

BUILDING DEPT.

1806 22ND AVE.

1 OF 1

OREGON MICRO-IMAGING, INC.

**CITY OF FOREST GROVE
BUILDING DEPARTMENT
Microfilm Record**

Address/Location: 1800 22nd Ave.	
Map/Tax Lot:	
Subdivision:	
Bldg. Permit No(s): 2100 505	
Dates From: 9/27/65	To: 12/31/87
<p>FILE CONTENTS</p> <p>Please check mark those items which are in the file.</p> <p>* CONTENTS TO BE MICROFILMED IN ORDER LISTED</p>	<input type="checkbox"/> Certif./Occupancy
	<input checked="" type="checkbox"/> Inspection Request card/sheet
	<input checked="" type="checkbox"/> Building Permit How many? 6
	<input type="checkbox"/> Other Permits Plumbing Mechanical Sewer
	<input type="checkbox"/> Security Agreements
	<input type="checkbox"/> Site plan drawings Blueprint drawings
	<input checked="" type="checkbox"/> Correspondence/Memos
	<input checked="" type="checkbox"/> Other Correction NOTICE
Notes:	
Date Microfilmed: 9/23	

CITY OF FOREST GROVE

COMMUNITY DEVELOPMENT DEPARTMENT
BUILDING & CODE ENFORCEMENT DIVISION

**PERMIT - APPLICATION
BUILDING**

VALIDATION

Date 8/30/76

By [Signature]
#06941

This is a Building Permit When Properly Filled Out,
Signed and Validated.

Mcp Book _____ Page _____ Parcel _____

OWNER <u>PAUL WALTHER</u>		BUILDING ADDRESS <u>1806 22ND AVE</u>	
MAIL ADDRESS <u>1262 3RD ST.</u>		NEAREST CROSS ST	
CITY <u>ELMO NEV.</u> TEL. NO.		LOT	
CONTRACTOR <u>SELF</u>		TRACT	
ADDRESS		LOT SIZE	
CITY		BLDG. AREA	
STATE LICENSE NO.		NO. BLDG. NOW ON LOT	
ARCHITECT OR ENGINEER		GROUP <u>I</u> TYPE <u>II</u> FIRE ZONE <u>III</u>	
ADDRESS		SPECIAL CONDITIONS	
CITY		<u>REEROOF</u>	
DESCRIPTION OF WORK		PLANNING DIV APPR. _____ DATE _____	
NEW	ADD	ALTER	REPAIR
SIZE	SQ FT	NO OF ROOMS	NO OF STORIES
WALL COVERING		EXTERIOR	INTERIOR
ROOF COVERING <u>SPLIT SHAKES</u>		APPROVALS	
USE OF STRUCTURE <u>DWELLING</u>		DATE	
ESTIMATED COST <u>7500</u>		INSPECTOR & SIGNATURE	
WORKMEN & COMP INS NO		FOUNDATION LOCATION FORMS, MATERIALS	
I ACKNOWLEDGE THAT I HAVE READ THIS APPLICATION AND STATE THAT THE ABOVE IS CORRECT AND AGREE TO COMPLY WITH ALL CITY ORDINANCES AND STATE LAWS		JOIST & GIRDERS	
I CERTIFY THAT I AM PROPERLY REGISTERED AND LICENSED AS REQUIRED BY THE CITY OF FOREST GROVE, STATE OF OREGON, OR THAT I AM THE LEGAL OWNER OF THE ABOVE PROPERTY		FRAMING	
LENDER		LATH OR DRYWALL INTERIOR	
BRANCH DESIGNATION		LATH EXTERIOR	
ADDRESS		ENCLOSURE	
SIGNATURE OF PERMITTEE <u>Paul Walther</u>		DRIVEWAY	
PLAN CHECK RECEIPT NO.		GRADING & DRAINAGE	
DATE PAID		ROOF SHEATHING	
VALUATION <u>7500</u>		ROOF COVERING	
PLAN CHECK FEE		SWIM POOL EXCAVATION & STEEL	
ADDITIONAL FEE		PARTIAL INSPECTION	
PERMIT FEE		HOUSE NUMBER CORRECT & POSTED	
STATE SUR CHARGE		FINAL APPROVAL	
TOTAL FEE		DATE <u>8-30-76</u> PERMIT NO <u>505</u>	
ISSUING OFFICER <u>[Signature]</u>			

CITY OF FOREST GROVE

BUILDING

PERMIT-APPLICATION

COMMUNITY DEVELOPMENT DEPARTMENT
BUILDING & CODE ENFORCEMENT DIVISION

VALIDATION #
Date 3-4-83 By Rockelle

This is a Building Permit when properly filled out, signed and validated.

Map Book _____ Page _____ Parcel _____

OWNER <u>Irod Wise</u>				BUILDING ADDRESS <u>1806 22nd Ave</u>			
MAIL <u>1806 22nd Ave</u>				NEAREST CROSS ST.			
CITY <u>Forest Grove</u>		TEL. NO. <u>557-5023</u>		LOT <u>1N331C</u>		TRACT <u>7/1.10600</u>	
CONTRACTOR <u>Same</u>				LOT SIZE		BLOG. AREA	
ADDRESS				GROUP		TYPE	
CITY				TEL. NO.		FIRE ZONE	
STATE LICENSE NO.				BUS. TEL. NO.		SPECIAL CONDITIONS	
ARCHITECT OR ENGINEER				REG. NO.			
ADDRESS							
CITY				TEL. NO.		PLANNING DIV. APR.	
						DATE	
DESCRIPTION OF WORK				APPROVALS		DATE	
						INSPECTOR'S SIGNATURE	
NEW	ADD.	ALTER.	REPAIR	DEMOL.	MOVE		
SIZE	SQ. FT.	NO. RMS.			NO. STORIES		
WALL COVERING		EXTERIOR		INTERIOR		FOUNDATION; LOCATION	
ROOF COVERING						UNDER FLOOR	
USE OF STRUCTURE						FRAMING	
ESTIMATED COST						LATH OR DRYWALL INTERIOR	
						DRIVEWAY & WALK	
						RAIN DRAIN	
						SWIM POOL EXCAVATION & STEEL	
						OTHER	
I acknowledge that I have read this application and state that the above is correct and agree to comply with all City ordinances and State laws. I certify that I am properly registered and licensed as required by the City of Forest Grove, State of Oregon; or that I am the legal owner of the above property. <u>Irod Wise</u> Signature of Permittee							
PLAN CHECK RECEIPT NO.		PLAN CHECK FEE \$		ADDITIONAL FEE \$		FINAL APPROVAL	
DATE PAID		PERMIT FEE \$ <u>29.50</u>		STATE SURCHARGE \$ <u>9.00</u>		DATE <u>3-4-83</u> PERMIT NO. <u>2106</u>	
VALUATION <u>2,000.00</u>		TOTAL FEE \$ <u>33.50</u>				ISSUING OFFICER <u>Rockelle Grey</u>	

WHITE: Inspector's Copy CANARY: Permittee Copy PINK: Building Div. Copy

PI2 49605

UNITED STATES POSTAL SERVICE
FIRST CLASS PERMIT NO. 1000
NEW YORK, N.Y.

Fred Wesley
1806 53rd Ave
Forest Grove

CONSULT POSTMASTER FOR FEES	CERTIFIED MAIL	
	SPECIAL DELIVERY	
	RESTRICTED DELIVERY	
	OPTIONAL SERVICES	
RETURN RECEIPT SERVICE		
TOTAL POSTAGE AND FEES		
POSTMARK OR DATE		<i>CV</i>

PS Form 3841, Apr. 1975

forest
grove

August 13, 1982

Mr. Fred Wise
1806 22nd Ave.
Forest Grove, OR 97116

RE: CODE VIOLATION
1806 22nd Ave 1N3 31CC t/1 10600

Dear Mr. Wise,

On July 19, 1982 you were given a correction notice to make you aware that a building permit must be obtained before the new foundations under the existing house are constructed. We have not received any response to the notice as of this date.

This letter serves as notice to you the legal owner of the property according to Washington County tax books to obtain the required permit and obtain the required inspections as required in the State of Oregon Structural Specialty Code and Fire and Life Safety Code within 30 days from the date of this notice. Failure to comply will result with further legal action to abate the violation.

Any questions you might have please contact this office at 357-7151, ext. 213.

Sincerely,

Roy Hoogendoorn
Roy Hoogendoorn
Building Official

RH:rg

MR. WISE CALLED ON 8-16-82 TO ADVISE ME THAT HE WILL OBTAIN THE REQ'D PERMIT BUT WON'T BE COMPLETING THE WORK FOR A WHILE RH

CITY OF FOREST GROVE P.O. Box 326 Forest Grove, Oregon 97116 (503) 357-7151

UNITED STATES POSTAL SERVICE
OFFICIAL BUSINESS

SENDER INSTRUCTIONS
Print your name, address, and ZIP Code in the space below.
• Complete items 1, 2, and 3 on the reverse.
• Attach to front of article if space permits. Otherwise affix to back of article.
• Endorse article "Return Receipt Requested" adjacent to number.

PENALTY FOR PRIVATE
USE TO AVOID PAYMENT
OF POSTAGE, \$300



RETURN
TO



RECEIVED

AUG 17 1982

CITY OF FOREST GROVE

CITY OF FOREST GROVE
P.O. BOX 326
FOREST GROVE, OR. 97115

(City, State, and ZIP Code)
Bldg
(City, State, and ZIP Code)

WHILE YOU WERE AWAY

FOR Ray
M Mr Wise
OF _____
PHONE 357-9856
MESSAGE Permit
to
SIGNED _____

DATE 8-16 TIME 2:20 PM

<input checked="" type="checkbox"/>	TELEPHONED
<input checked="" type="checkbox"/>	RETURNED YOUR CALL
<input type="checkbox"/>	PLEASE CALL
<input type="checkbox"/>	WILL CALL AGAIN
<input type="checkbox"/>	CAME TO SEE YOU
<input type="checkbox"/>	WANTS TO SEE YOU

FORM 4002

CITY OF FOREST GROVE

COMMUNITY DEVELOPMENT DEPARTMENT
BUILDING & CODE ENFORCEMENT DIVISION

1924 COUNCIL STREET 357-7151 EXT 253
HOURS: 8-9 a.m. - 4-5 p.m., MON. THRU FRI.

CORRECTION NOTICE

Job Address 1806 22ND AVE

OWNER DEED WISE

CONTRACTOR _____

Bldg. Permit No. _____ Date 7-19-82

It is unlawful to cover any work until it has been inspected.

YOU ARE REQUIRED TO
OBTAIN A BUILDING
PERMIT BEFORE THE
CONSTRUCTION OF THE
FOUNDATIONS UNDER THE
EXISTING HOUSE.

DO NOT DO ANYMORE
UNTIL THE REQUIRED
PERMIT IS OBTAINED.

PLEASE CALL 357-7151
EXT. 213 FOR ANY
QUESTIONS YOU HAVE

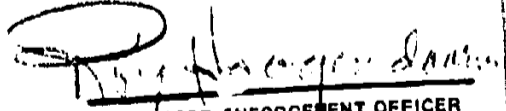
CODE ENFORCEMENT OFFICER

CITY OF FOREST GROVE

COMMUNITY DEVELOPMENT DEPARTMENT
BUILDING & CODE ENFORCEMENT DIVISION

1924 COUNCIL STREET 357-7151 EXT. 253
HOURS: 8-9 a.m. - 4-5 p.m., MON. THRU FRI.

CORRECTION NOTICE

Job Address 1806 22ND AVE

OWNER FRED WISE

CONTRACTOR _____

Eldg. Permit No. _____ Date 7-19-82

It is unlawful to cover any work until it has been inspected.

PURSUANT TO A COMPLAINT

A INSPECTION WAS MADE

WHICH DETERMINED THAT

A CODE VIOLATION EXISTS ON

THE PREMISES. CITY CODE

PROHIBITS THE KEEPING CHICKENS,

RABBITS, LIVESTOCK ETC. UNLESS

A PERMIT IS OBTAINED, AS

REQ'D BY SECTION 5-900 OF

CITY ORDINANCES & CODES.

YOU ARE DIRECTED TO REMOVE

THE VIOLATION WITH IN

10 DAYS. FAILURE TO COMPLY

TO THE DIRECTIVE WILL RESULT

WITH FURTHER LEGAL ACTION.

CODE ENFORCEMENT OFFICER

R. H. Hagen

City of Forest Grove

For Inspection
Call the 24 Hour Inspection Line
(503-992-3206)

PLUMBING PERMIT

PERMIT NO.: PLM06-00092
APPLIED: 4/20/2006
ISSUED: 4/20/2006
EXPIRES: 10/20/2006

SITE ADDRESS: 1806 22ND AVE
ASSESSOR'S PARCEL NO.: 1N331CC-10600
TYPE OF WORK: Alteration
TYPE OF USE: Single Family Residential
PROJECT DESCRIPTION: BACKFLOW FOR IRRIGATION

<p><u>OWNER/APPLICANT</u></p> <p>HALL, ANN 1806 22ND AVE FOREST GROVE OR 97116</p>	<p><u>CONTRACTOR</u></p>
--	--------------------------

Plumbing Fixtures		Fees			
Fixture Type	Quantity	Type	By	Date	Amount
Backflow device	1	PRMT	LVW	4/20/2006	\$27.30
		SUCH	LVW	4/20/2006	\$2.18
Total:					\$29.48

NOTES:

I hereby acknowledge that I have read this permit and state that the above information is correct, and agree to comply with all ordinances and state and federal laws regulating activities covered by this permit.

Issued by _____

Applicant or Owner's Signature  _____

CONDITIONS OF APPROVAL :

1)

Plumbing Permit Application



City of Forest Grove

Phone: 503-992-3229

Fax: 503-992-3202

1924 Council Street/P.O. Box 326, Forest Grove, Oregon 97116

Inspection Request Line: 503-992-3206

Permit Number:

TYPE OF WORK	
<input type="checkbox"/> New construction	<input type="checkbox"/> Demolition
<input checked="" type="checkbox"/> Addition/alteration/replacement	<input type="checkbox"/> Other:
CATEGORY OF CONSTRUCTION	
<input checked="" type="checkbox"/> 1- and 2-family dwelling	<input type="checkbox"/> Commercial/industrial
<input type="checkbox"/> Accessory building	<input type="checkbox"/> Multi-family
<input type="checkbox"/> Master builder	<input type="checkbox"/> Other:
JOB SITE INFORMATION AND LOCATION	
Job site address: <u>1806 22nd Ave.</u>	
City/State/ZIP: <u>Forest Grove, OR 97116</u>	
Suite/bldg./apt. no.:	Project name:
Cross street/directions to job site:	
Subdivision:	Lot no.:
Tax map/parcel no.:	
DESCRIPTION OF WORK	
<u>Irrigation system installation</u>	
<input checked="" type="checkbox"/> PROPERTY OWNER	<input type="checkbox"/> TENANT
Name: <u>Ann Hall</u>	
Address: <u>1806 22nd Ave</u>	
City/State/ZIP: <u>Forest Grove, OR 97116</u>	
Phone: <u>(503) 357-3055</u>	Fax: ()
<input checked="" type="checkbox"/> APPLICANT	<input type="checkbox"/> CONTACT PERSON
Business name: <u>Forest Landscape, Inc.</u>	
Contact name: <u>Vanessa</u>	
Address: <u>40437 NW Verboort Rd</u>	
City/State/ZIP: <u>Forest Grove, OR 97116</u>	
Phone: <u>(503) 357-3808</u>	Fax: <u>(503) 359-1908</u>
E-mail:	
CONTRACTOR	
Business name: <u>Forest Landscape, Inc.</u>	
Address: <u>40437 NW Verboort Rd</u>	
City/State/ZIP: <u>Forest Grove 97116</u>	
Phone: <u>(503) 357-3808</u>	Fax: <u>(503) 359-1908</u>
CCB lic.: <u>LCB 8253</u>	PB Lic. no.:

FEE* SCHEDULE			
For special information use checklist.			
Description	Qty.	Ea.	Total
New 1- 2-family dwellings (includes 100 ft. for each utility connection)			
SFR (1) bath		239.50	
SFR (2) bath		316.75	
SFR (3) bath		386.25	
Each additional bath/kitchen		41.72	
Fire sprinkler (____ sq. ft.)		46.35	
Site utilities			
Catch basin or area drain		13.90	
Drywell, leach line, or trench drain		13.90	
Footing drain (no. linear ft.: ____)		46.35	
Manufactured home utilities			
Manholes		13.90	
Rain drain connector		13.90	
Sanitary sewer (no. linear ft.: ____)		46.35	
Storm sewer (no. linear ft.: ____)		46.35	
Water service (no. linear ft.: ____)		46.35	
Fixture or item			
Absorption valve		13.90	
Backflow preventer	1	13.90	13.90
Backwater valve		13.90	
Clothes washer		13.90	
Dishwasher		13.90	
Drinking fountain		13.90	
Ejectors/sump		13.90	
Expansion tank		13.90	
Fixture/sewer cap		13.90	
Floor drain/floor sink/hub		13.90	
Garbage disposal		13.90	
Hose bib		13.90	
Ice maker		13.90	
Interceptor/grease trap		13.90	
Medical gas (value: \$ ____)			
Primer		13.90	
Roof drain (commercial)		13.90	
Sink/basin/lavatory		13.90	
Tub/shower/shower pan		13.90	
Urinal		13.90	
Water closet		13.90	
Water heater		13.90	
Other:		13.90	
Other:			
Subtotal			13.90
Minimum permit fee			\$ 27.30
Plan review (____% of permit fee)			
State surcharge (8% of permit fee)			
TOTAL PERMIT FEE			29.48

Authorized signature: Vanessa Castaneda

Print name: Vanessa Castaneda Date: 4/19/06

This permit application expires if a permit is not obtained within 180 days after it has been accepted as complete.

* Fee methodology set by Tri-County Building Industry Service Board
440-4616T (10/02/COM/WEB)



CITY OF FOREST GROVE
 1924 Council Street
 PO Box 326
 Forest Grove, OR 97116
 503-992-3229

Permit No.: PLM-15-00221

For Inspections Call the 24 Hour Inspection Line
 Building (503-992-3206) Engineering (503-992-3228)

Permit Type: **Plumbing Over the Counter**

Site Address:	1806 22ND AVE FOREST GROVE OR 97116	OccCode	Construction Type	SqFt
Owner:	HALL ANNE F LIVING TRUST	Phone:		
Address:	1806 22ND AVE FOREST GROVE OR 97116	Fax:		
Contractor:	CITY OF FOREST GROVE PUBLIC WORKS	Phone:	(503) 992-3258	
Address:	2551 23RD AVE SUITE A FOREST GROVE OR 97116	Fax:		
Contact:		Business Lic#:	no ccb #	
Description:		Phone:	(503) 992-3258	

SUPPLEMENTAL INFORMATION:	
# LF SANITARY SEWER	1

FEES:	
Plumbing Permit Fee	46.35
Plumbing State Surcharge	5.56
TOTAL FEES: 51.91	

I hereby acknowledge that I have read this permit and state that the above information is correct, and agree to comply with all conditions, ordinances and state and federal laws regulating activities covered by this permit.

Applicant Signature: R. Vanki Date: 2/17/15 Issued by: UB



Plumbing Permit Application

City of Forest Grove

Phone: 503-992-3229

Fax: 503-992-3202

1924 Council Street/P.O. Box 326, Forest Grove, Oregon 97116

Inspection Request Line: 503-992-3206

Permit Number: **PLM-15-00221**

TYPE OF WORK	
<input type="checkbox"/> New construction	<input type="checkbox"/> Demolition
<input checked="" type="checkbox"/> Addition/alteration/replacement	<input type="checkbox"/> Other:
CATEGORY OF CONSTRUCTION	
<input checked="" type="checkbox"/> 1- and 2-family dwelling	<input type="checkbox"/> Commercial/industrial
<input type="checkbox"/> Accessory building	<input type="checkbox"/> Multi-family
<input type="checkbox"/> Master builder	<input type="checkbox"/> Other:
JOB SITE INFORMATION AND LOCATION	
Job site address: 1806 22nd Street Ave	
City/State/ZIP: Forest Grove, OR 97116	
Suite/bldg./apt. no.:	Project name: 23 rd I & I Phase 2
Cross street/directions to job site:	
Subdivision:	
Lot no.:	
Tax map/parcel no.: 1N331CC10600	
DESCRIPTION OF WORK	
Sanitary Sewer Lateral Replacement	
<input checked="" type="checkbox"/> PROPERTY OWNER <input type="checkbox"/> TENANT	
Name: Anne F. Hall	
Address: 1806 22nd Street Ave	
City/State/ZIP: Forest Grove, OR 97116	
Phone: ()	Fax: ()
APPLICANT	CONTACT PERSON
Business name: City of Forest Grove Public Works	
Contact name: Rick Vanderkin	
Address: 2551-A 23 rd Ave.	
City/State/ZIP: Forest Grove, OR 97116	
Phone: (503)992-3258	Fax: : (503)992-3119
E-mail: rvanderkin@forestgrove-or.gov	
CONTRACTOR	
Business name:	
Address:	
City/State/ZIP:	
Phone: ()	Fax: ()
CCB lic.:	PB Lic. no.:

FEE* SCHEDULE			
<i>For special information use checklist.</i>			
Description	Qty.	Ea.	Total
New 1- 2-family dwellings (includes 100 ft. for each utility connection)			
SFR (1) bath		239.50	
SFR (2) bath		316.75	
SFR (3) bath		386.25	
Each additional bath/kitchen		41.72	
Fire sprinkler (____sq. ft.)		By sq ft .	
Site utilities			
Catch basin or area drain		13.90	
Drywell, leach line, or trench drain		13.90	
Footing drain (each 100 ft.: ____)		46.35	
Manufactured home utilities			
Manholes		13.90	
Rain drain connector		13.90	
Sanitary sewer (each 100 ft.: ____)	1	46.35	\$46.35
Storm sewer (each 100 ft.: ____)		46.35	
Water service (each 100 ft.: ____)		46.35	
Fixture or item			
Absorption valve		13.90	
Backflow preventer		13.90	
Backwater valve		13.90	
Clothes washer		13.90	
Dishwasher		13.90	
Drinking fountain		13.90	
Ejectors/sump		13.90	
Expansion tank		13.90	
Fixture/sewer cap		13.90	
Floor drain/floor sink/hub		13.90	
Garbage disposal		13.90	
Hose bib		13.90	
Ice maker		13.90	
Interceptor/grease trap		13.90	
Medical gas (value: \$ ____)		By value	
Primer		13.90	
Roof drain (commercial)		13.90	
Sink/basin/lavatory		13.90	
Tub/shower/shower pan		13.90	
Urinal		13.90	
Water closet		13.90	
Water heater		13.90	
Other:		13.90	
Other:			
Subtotal			\$46.35
Minimum permit fee			\$ 27.30
Plan review (____% of permit fee)			
State surcharge (12% of permit fee)			\$5.56
TOTAL PERMIT FEE			\$51.91

Authorized signature:

Print name: Rick Vanderkin

Date: 01/06/15

This permit application expires if a permit is not obtained within 180 days after it has been accepted as complete.

* Fee methodology set by Tri-County Building Industry Service Board
440-4616T (10/02/COM/WEB)

③ Street Trees



COMMUNITY DEVELOPMENT DEPARTMENT
Building and Code Enforcement

INSPECTION REQUEST
503-992-3206

Site Address 1806 22nd Ave
Contractor
Phone Number

Scheduled Inspection Date
Mon [] Tues [] Wed [] Thurs [] Fri []
AM [] PM [] other
Permit Number BLD05-00224

BUILDING

- Footing / Pier
Foundation Wall
Underfloor (P & B)
Shear
Framing
Insulation
Approach/Sidewalk
Other
[X] Planning
Final

PLUMBING

- Underfloor (P & B)
Top Out (Rough)
Water Line
Rain/Crawl Drains
Storm Drainage
Sanitary Sewer
Backflow Device
Water Heater
Other
Final

MECHANICAL

- Gas Piping
Underfloor (P & B)
Rough Mechanical
HVAC (Final)
Other

MANUFACTURED HOME

- M/H Set-Up
M/H Mechanical
M/H Water/Sewer
M/H Electrical Feeder
M/H Final
Other

Comments:

- [X] APPROVED
[] NOT APPROVED (REINSPECTION REQUIRED)
[] APPROVED AFTER CORRECTIONS
[] REINSPECTION FEE IS REQUIRED BEFORE NEXT INSPECTION \$

CORRECTIONS:

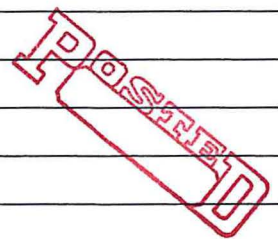

Date: 7/19/06

Inspector: [Signature]



COMMUNITY DEVELOPMENT DEPARTMENT
Building and Code Enforcement

INSPECTION REQUEST

503-992-3206

Site Address 1806 22nd Ave

Scheduled Inspection Date 2-15-06

Contractor

Mon [] Tues [] Wed [x] Thurs [] Fri []

Phone Number 503-936-7462

AM [x] PM [] other

Permit Number MC0500192

BUILDING

PLUMBING

MECHANICAL

MANUFACTURED HOME

- Footing / Pier
Foundation Wall
Underfloor (P & B)
Shear
Framing
Insulation
Approach/Sidewalk
Other
Planning
Final

- Underfloor (P & B)
Top Out (Rough)
Water Line
Rain/Crawl Drains
Storm Drainage
Sanitary Sewer
Backflow Device
Water Heater
Other
Final

- Gas Piping
Underfloor (P & B)
Rough Mechanical
HVAC (Final)
Other

- M/H Set-Up
M/H Mechanical
M/H Water/Sewer
M/H Electrical Feeder
M/H Final
Other

Comments:

Call if you need let in.

[] APPROVED

[x] NOT APPROVED (REINSPECTION REQUIRED)

[] APPROVED AFTER CORRECTIONS

[] STOP WORK

CORRECTIONS: 1 complete installation of fireplace igniter AND connect gas line

POSTED

Date: 2-15-06

Inspector: AWL



COMMUNITY DEVELOPMENT DEPARTMENT
Building and Code Enforcement

INSPECTION REQUEST

503-992-3206

Site Address 1806 22nd Ave
Contractor John
Phone Number 503-936-7462

Scheduled Inspection Date 2/14/06
Mon [] Tues [x] Wed [] Thurs [] Fri []
AM [] PM [] other []
Permit Number PUMOS-00352

BUILDING

PLUMBING

MECHANICAL

MANUFACTURED HOME

- Footing / Pier
Foundation Wall
Underfloor (P & B)
Shear
Framing
Insulation
Approach/Sidewalk
Other
Planning
Final

- Underfloor (P & B)
Top Out (Rough)
Water Line
Rain/Crawl Drains
Storm Drainage
Sanitary Sewer
Backflow Device
Water Heater
Other
Final [x]

- Gas Piping
Underfloor (P & B)
Rough Mechanical
HVAC (Final)
Other

- M/H Set-Up
M/H Mechanical
M/H Water/Sewer
M/H Electrical Feeder
M/H Final
Other

Comments:

[] APPROVED

[] NOT APPROVED
(REINSPECTION REQUIRED)

[x] APPROVED AFTER
CORRECTIONS
(NO REINSPECTION REQUIRED)

[] STOP WORK

CORRECTIONS: 1) Install downspout on west side of garage

Will check at Building final

POSTED

Date: 2-14-06

Inspector: [Signature]



COMMUNITY DEVELOPMENT DEPARTMENT
Building and Code Enforcement

INSPECTION REQUEST

503-992-3206

Site Address 1806 22nd Ave
Contractor John
Phone Number 503-936-7422

Scheduled Inspection Date 2/16/06
Mon [] Tues [] Wed [] Thurs [] Fri []
AM [x] PM [] other Late
Permit Number MEC 05-00192

BUILDING

PLUMBING

MECHANICAL

MANUFACTURED HOME

- Footing / Pier
Foundation Wall
Underfloor (P & B)
Shear
Framing
Insulation
Approach/Sidewalk
Other
Planning
Final

- Underfloor (P & B)
Top Out (Rough)
Water Line
Rain/Crawl Drains
Storm Drainage
Sanitary Sewer
Backflow Device
Water Heater
Other
Final

- Gas Piping
Underfloor (P & B)
Rough Mechanical
HVAC (Final)
Other

- M/H Set-Up
M/H Mechanical
M/H Water/Sewer
M/H Electrical Feeder
M/H Final
Other

Comments:

Key on Mech Disconnect

[x] APPROVED

[] NOT APPROVED
(REINSPECTION REQUIRED)

[] APPROVED AFTER
CORRECTIONS
(NO REINSPECTION REQUIRED)

[] STOP WORK

CORRECTIONS: corrections completed



Date: 2-16-06

Inspector:

AWL



COMMUNITY DEVELOPMENT DEPARTMENT
Building and Code Enforcement

INSPECTION REQUEST

503-992-3206

Site Address 1806 22ND
Contractor JOHN
Phone Number 503) 936-7462

Scheduled Inspection Date 2-17-06
Mon [] Tues [] Wed [] Thurs [] Fri [x]
AM [] PM [x] other LATE
Permit Number 13LDOS-00224

- BUILDING: Footing / Pier, Foundation Wall, Underfloor (P & B), Shear, Framing, Insulation, Approach/Sidewalk, Other, Planning, Final [x]
PLUMBING: Underfloor (P & B), Top Out (Rough), Water Line, Rain/Crawl Drains, Storm Drainage, Sanitary Sewer, Backflow Device, Water Heater, Other, Final
MECHANICAL: Gas Piping, Underfloor (P & B), Rough Mechanical, HVAC (Final), Other
MANUFACTURED HOME: M/H Set-Up, M/H Mechanical, M/H Water/Sewer, M/H Electrical Feeder, M/H Final, Other
Comments:

[] APPROVED [x] NOT APPROVED (REINSPECTION REQUIRED) [] APPROVED AFTER CORRECTIONS (NO REINSPECTION REQUIRED) [] STOP WORK

CORRECTIONS: 1) PROVIDE Post PERMENANT ADDRESS
2) SEAL EXTERIOR PENETRATIONS @ CABLES ON side OF GARAGE
3) INSTALL HANDLE ON UNDER FLOOR CRAWL ACCESS
4) SEAL AROUND DRYER EXHAUST + DRAIN CLEANOUT in LAUNDRY ROOM
5) PROVIDE INSULATION certificate from Supplier

POSTED

Date: 2-17-06 Inspector: AWL



COMMUNITY DEVELOPMENT DEPARTMENT
Building and Code Enforcement

INSPECTION REQUEST

503-992-3206

Site Address 1806 22nd Ave
Contractor John
Phone Number 503-936-7462

Scheduled Inspection Date 2/21/06
Mon [] Tues [x] Wed [] Thurs [] Fri []
AM [] PM [] other []
Permit Number BLD05-00224

- BUILDING: Footing / Pier, Foundation Wall, Underfloor (P & B), Shear, Framing, Insulation, Approach/Sidewalk, Other, Planning, Final
PLUMBING: Underfloor (P & B), Top Out (Rough), Water Line, Rain/Crawl Drains, Storm Drainage, Sanitary Sewer, Backflow Device, Water Heater, Other, Final
MECHANICAL: Gas Piping, Underfloor (P & B), Rough Mechanical, HVAC (Final), Other
MANUFACTURED HOME: M/H Set-Up, M/H Mechanical, M/H Water/Sewer, M/H Electrical Feeder, M/H Final, Other

Comments: Key in panel - Heat Pump

- [x] APPROVED
[] NOT APPROVED (REINSPECTION REQUIRED)
[] APPROVED AFTER CORRECTIONS (NO REINSPECTION REQUIRED)
[] STOP WORK

CORRECTIONS: corrections completed

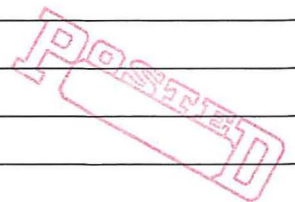



Date: 2-21-06

Inspector: [Signature]

CERTIFICATE OF INSULATION

At this address 1806 22nd Ave
Forest Grove, Oregon

The following insulation has been installed in the following areas in conformance to applicable codes, standards and regulations.

 ATTIC/ CEILING	 WALLS	 FLOOR
Using <u>22.68</u> bags covering <u>488</u> sq ft. to provide an R value of <u>R-38</u>	Using <u>23.89</u> bags covering <u>1389</u> sq ft. to provide an R value of <u>R-21</u>	Using _____ bags covering <u>1489</u> sq ft. to provide an R value of <u>R-25</u>

BUILDER:

Bill Wren & Sons

Builder's Company Name

Builder's Address

Builder's Signature

Date

INSTALLED BY:

Accurate Siding & Insulation, Inc.

[Signature]

2/20/06

Date

8170 SW NIMBUS AVE, Beaverton, OR 97008 (503) 646-9432 CCB#138442 WA LIC# ACCURS1980B2

POSTED



COMMUNITY DEVELOPMENT DEPARTMENT
Building and Code Enforcement

INSPECTION REQUEST

503-992-3206

Site Address 1806 22ND AVENUE

Contractor JOHN

Phone Number 503-936-7462

Scheduled Inspection Date 01/06/06

Mon [] Tues [] Wed [] Thurs [] Fri [X]

AM [] PM [X] other

Permit Number BLD005-00224

BUILDING

- Footing / Pier
Foundation Wall
Underfloor (P & B)
[X] Shear INTER FOL (2)
Framing
Insulation
Approach/Sidewalk
Other
Planning
Final

PLUMBING

- Underfloor (P & B)
Top Out (Rough)
Water Line
Rain/Crawl Drains
Storm Drainage
Sanitary Sewer
Backflow Device
Water Heater
Other
Final

MECHANICAL

- Gas Piping
Underfloor (P & B)
Rough Mechanical
HVAC (Final)
Other

MANUFACTURED HOME

- M/H Set-Up
M/H Mechanical
M/H Water/Sewer
M/H Electrical Feeder
M/H Final
Other

Comments:

[X] APPROVED

[] NOT APPROVED (REINSPECTION REQUIRED)

[] APPROVED AFTER CORRECTIONS (NO REINSPECTION REQUIRED)

[] STOP WORK

CORRECTIONS:

IBP's Nail as per plan

OK TO TAPE

POSTED

Date: 1-06-06

Inspector: [Signature]



COMMUNITY DEVELOPMENT DEPARTMENT
Building and Code Enforcement

INSPECTION REQUEST

503-992-3206

Site Address 1806 Jewel Ave

Contractor Anne Hall

Phone Number 503-936-7462 John

Scheduled Inspection Date 12/30/05

Mon [] Tues [] Wed [] Thurs [] Fri [x]

AM [x] PM [] other []

Permit Number BU005-00224

BUILDING

PLUMBING

MECHANICAL

MANUFACTURED HOME

- Footing / Pier
Foundation Wall
Underfloor (P & B)
Shear
Framing [x]
Insulation
Approach/Sidewalk
Other
Planning
Final

- Underfloor (P & B)
Top Out (Rough)
Water Line
Rain/Crawl Drains
Storm Drainage
Sanitary Sewer
Backflow Device
Water Heater
Other
Final

- Gas Piping
Underfloor (P & B)
Rough Mechanical
HVAC (Final)
Other

- M/H Set-Up
M/H Mechanical
M/H Water/Sewer
M/H Electrical Feeder
M/H Final
Other

Comments:

Back Door Unlocked

[x] APPROVED

[] NOT APPROVED
(REINSPECTION REQUIRED)

[] APPROVED AFTER
CORRECTIONS
(NO REINSPECTION REQUIRED)

[] STOP WORK

CORRECTIONS:

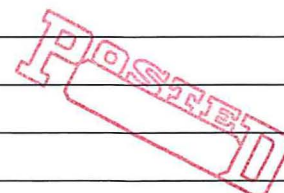

Date:

12-30-05

Inspector:

[Signature]



COMMUNITY DEVELOPMENT DEPARTMENT
Building and Code Enforcement

INSPECTION REQUEST

503-992-3206

Site Address 1806 27th Ave
Contractor John
Phone Number 936-74602

Scheduled Inspection Date 12-2-05
Mon [] Tues [] Wed [] Thurs [] Fri [X]
AM [] PM [X] other
Permit Number BLD05-00224

- BUILDING
Footing / Pier
Foundation Wall
Underfloor (P & B)
Shear
[X] Framing
Insulation
Approach/Sidewalk
Other
Planning
Final

- PLUMBING
Underfloor (P & B)
Top Out (Rough)
Water Line
Rain/Crawl Drains
Storm Drainage
Sanitary Sewer
Backflow Device
Water Heater
Other
Final

- MECHANICAL
Gas Piping
Underfloor (P & B)
Rough Mechanical
HVAC (Final)
Other

- MANUFACTURED HOME
M/H Set-Up
M/H Mechanical
M/H Water/Sewer
M/H Electrical Feeder
M/H Final
Other

Comments:

- [] APPROVED
[X] NOT APPROVED (REINSPECTION REQUIRED)
[] APPROVED AFTER CORRECTIONS (NO REINSPECTION REQUIRED)
[] STOP WORK

CORRECTIONS: 1) PROVIDE MIDPOINT GABLE BRACE @ North and West GABLE 2) Fill Blocks UNDER DBL IN Garage 3) Block Back of FIREPLACE CHASE TO SEAL 3) Baffle FIREPLACE CHASE @ ceiling line

Note: OK to Insulate - will check @ insulation inspection

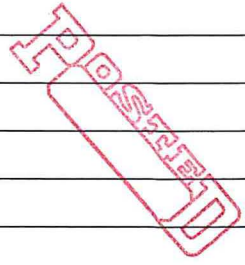

Date: 12-2-05 Inspector: AWL



COMMUNITY DEVELOPMENT DEPARTMENT
Building and Code Enforcement

INSPECTION REQUEST

503-992-3206

Site Address 1806 22nd Ave.
Contractor
Phone Number

Scheduled Inspection Date 12-2-05
Mon [] Tues [] Wed [] Thurs [] Fri [x]
AM [] PM [x] other
Permit Number MEC05-00192

BUILDING

PLUMBING

MECHANICAL

MANUFACTURED HOME

- Footing / Pier
Foundation Wall
Underfloor (P & B)
Shear
Framing
Insulation
Approach/Sidewalk
Other
Planning
Final

- Underfloor (P & B)
Top Out (Rough)
Water Line
Rain/Crawl Drains
Storm Drainage
Sanitary Sewer
Backflow Device
Water Heater
Other
Final

- Gas Piping
Underfloor (P & B)
Rough Mechanical
HVAC (Final)
Other

- M/H Set-Up
M/H Mechanical
M/H Water/Sewer
M/H Electrical Feeder
M/H Final
Other

Comments:

[x] APPROVED

[] NOT APPROVED
(REINSPECTION REQUIRED)

[] APPROVED AFTER
CORRECTIONS
(NO REINSPECTION REQUIRED)

[] STOP WORK

CORRECTIONS:

TAG # 358 255

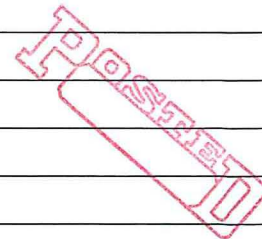

Date: 12-2-05

Inspector: AWT



COMMUNITY DEVELOPMENT DEPARTMENT
Building and Code Enforcement

INSPECTION REQUEST

503-992-3206

Site Address 1806 22ND AVENUE

Contractor JOHN

Phone Number 503-936-7462

Scheduled Inspection Date 11-23-05

Mon [] Tues [] Wed [x] Thurs [] Fri []

AM [] PM [] other []

Permit Number ALMOS-00352

BUILDING

- Footing / Pier
Foundation Wall
Underfloor (P & B)
Shear
Framing
Insulation
Approach/Sidewalk
Other
Planning
Final

PLUMBING

- Underfloor (P & B)
[X] Top Out (Rough)
Water Line
Rain/Crawl Drains
Storm Drainage
Sanitary Sewer
Backflow Device
Water Heater
Other
Final

MECHANICAL

- Gas Piping
Underfloor (P & B)
Rough Mechanical
HVAC (Final)
Other

MANUFACTURED HOME

- M/H Set-Up
M/H Mechanical
M/H Water/Sewer
M/H Electrical Feeder
M/H Final
Other

Comments:

[x] APPROVED

[] NOT APPROVED (REINSPECTION REQUIRED)

[] APPROVED AFTER CORRECTIONS (NO REINSPECTION REQUIRED)

[] STOP WORK

CORRECTIONS: TOP-OUT PLUMBING

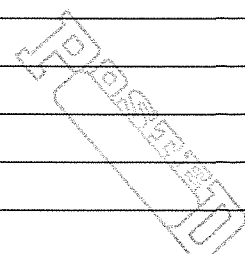

Date: 11/23/05

Inspector: [Signature]



COMMUNITY DEVELOPMENT DEPARTMENT
Building and Code Enforcement

INSPECTION REQUEST

503-992-3206

Site Address 1806 22nd Ave
Contractor
Phone Number

Scheduled Inspection Date 11/17/05
Mon [] Tues [] Wed [] Thurs [x] Fri []
AM [x] PM [] other
Permit Number B 4005-00224

BUILDING

- Footing / Pier
Foundation Wall
Underfloor (P & B)
Shear [x]
Framing
Insulation
Approach/Sidewalk
Other
Planning
Final

PLUMBING

- Underfloor (P & B)
Top Out (Rough)
Water Line
Rain/Crawl Drains
Storm Drainage
Sanitary Sewer
Backflow Device
Water Heater
Other
Final

MECHANICAL

- Gas Piping
Underfloor (P & B)
Rough Mechanical
HVAC (Final)
Other

MANUFACTURED HOME

- M/H Set-Up
M/H Mechanical
M/H Water/Sewer
M/H Electrical Feeder
M/H Final
Other

Comments:

- [x] APPROVED
[] NOT APPROVED (REINSPECTION REQUIRED)
[] APPROVED AFTER CORRECTIONS (NO REINSPECTION REQUIRED)
[] STOP WORK

CORRECTIONS: Interior & Exterior complete

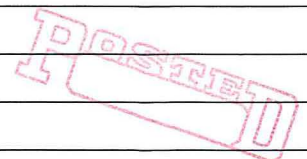

Date: 11-17-05

Inspector: [Signature]

City of Forest Grove

For Inspections
Call the 24 Hour Inspection Line
(503-992-3206)

BUILDING PERMIT

PERMIT NO.: BLD05-00128
APPLIED: 6/7/2005
ISSUED: 6/7/2005
EXPIRES: 12/7/2005

SITE ADDRESS: 1806 22ND AVE

ASSESSOR'S PARCEL NO.: 1N331CC-10600

PROJECT DESCRIPTION: DEMOLITION OF SINGLE FAMILY
RESIDENCE

<p><u>OWNER/APPLICANT</u></p> <p>HALL, ANNE 1207 NICHOLS LANE FOREST GROVE OR 97116</p>	<p><u>CONTRACTOR</u></p> <p>BILL WREN & SONS INC PO BOX 980 NORTH PLAINS OR 97133 121914</p>
--	--

<p>TYPE OF WORK: DEM</p> <p>TYPE OF USE: SF</p> <p>CENSUS CATEGORY:</p> <p>ZONING:</p> <p>Occupancy Groups</p> <hr/> <p>1: 2:</p> <p>3: 4:</p> <p>Construction Types</p> <hr/> <p>1: 2:</p> <p>3: 4:</p>	<p>AREA</p> <hr/> <p>LOT: 0sf</p> <p>1ST FLR: 0sf</p> <p>2ND FLR: 0sf</p> <p>BASEMENT: 0sf</p> <p>GAR/CARPORT: 0sf</p> <p>OTHER: 0sf</p> <p>NUMBER OF UNITS: 0</p> <p>STORIES: 0</p> <p>BUILDING HEIGHT: 0 ft</p>	<p>VALUE: \$0.00</p> <p>REQUIRED SETBACKS:</p> <hr/> <p>FRONT: 0.00 ft</p> <p>SIDE 1: 0 ft</p> <p>SIDE 2: 0 ft</p> <p>REAR: 0 ft</p> <p>REQUIRED PARKING</p> <hr/> <p>TOTAL: 0</p> <p>HANDICAPPED: 0</p> <p>COMPACT: 0</p> <p>IMPRV SURF: 0 sf</p>
--	---	--

FEES			
Type	By	Date	Amount
PRMT	MLP	6/7/2005	\$50.00
Total:			\$50.00

NOTES:

I hereby acknowledge that I have read this permit and state that the above information is correct, and agree to comply with all ordinances and state and federal laws regulating activities covered by this permit.

Issued by _____

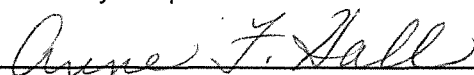
Applicant or Owner's Signature

CONDITIONS OF APPROVAL:

24 Hour Notice Required For All Inspections

Building Permit Application



City of Forest Grove

1924 Council Street/P.O. Box 326, Forest Grove, OR 97116

Permit Number:

Phone: 503-992-3229

Fax: 503-992-3202

Inspection Request Line: 503-992-3206

BLD 05-00128

TYPE OF WORK	
<input type="checkbox"/> New construction	<input checked="" type="checkbox"/> Demolition
<input type="checkbox"/> Addition/alteration/replacement	<input type="checkbox"/> Other: _____
CATEGORY OF CONSTRUCTION	
<input checked="" type="checkbox"/> 1- and 2-family dwelling	<input type="checkbox"/> Commercial/industrial
<input type="checkbox"/> Accessory building	<input type="checkbox"/> Multi-family
<input type="checkbox"/> Master builder	<input type="checkbox"/> Other: _____
JOB SITE INFORMATION AND LOCATION	
Job site address: <u>1806 22nd St.</u>	
City/State/ZIP: <u>Forest Grove, Or. 97116</u>	
Suite/bldg./apt. no.:	Project name:
Cross street/directions to job site: <u>22nd and B streets</u>	
Subdivision:	Lot no.:
Tax map/parcel no.:	
DESCRIPTION OF WORK	
<u>Demolition of house.</u>	
<input checked="" type="checkbox"/> PROPERTY OWNER	<input type="checkbox"/> TENANT
Name: <u>Anne F. Hall</u>	
Address: <u>1207 Nichols Lane</u>	
City/State/ZIP: <u>Forest Grove, Or. 97116</u>	
Phone: <u>(503) 357-3055</u>	Fax: ()
<input checked="" type="checkbox"/> APPLICANT	<input type="checkbox"/> CONTACT PERSON
Business name:	
Contact name: <u>Same</u>	
Address:	
City/State/ZIP:	
Phone: ()	Fax: ()
E-mail:	
CONTRACTOR	
Business name: <u>Bill Wren & Sons (John Wren)</u>	
Address: <u>P.O. Box 980</u>	
City/State/ZIP: <u>North Plains 97133</u>	
Phone: <u>(503) 647-2736</u>	Fax: <u>(647) 2736</u>
CCB lic.: <u># 121914</u>	

Authorized signature:	Date:
Print name:	Date:

REQUIRED DATA: 1- AND 2-FAMILY DWELLING
Permit fees* are based on the value of the work performed. Indicate the value (rounded to the nearest dollar) of all equipment, materials, labor, overhead, and the profit for the work indicated on this application.
Valuation
Number of bedrooms: <u>2</u>
Number of bathrooms: <u>1</u>
Total number of floors: <u>2 1/2</u>
New dwelling area: _____ square feet
Garage/carport area: <u>400</u> square feet
Covered porch area: <u>120</u> square feet
Deck area: _____ square feet
Other structure area: _____ square feet
REQUIRED DATA: COMMERCIAL-USE CHECKLIST
Permit fees* are based on the value of the work performed. Indicate the value (rounded to the nearest dollar) of all equipment, materials, labor, overhead, and the profit for the work indicated on this application.
Valuation
Existing building area: _____ square feet
New building area: _____ square feet
Number of stories: _____
Type of construction: _____
Occupancy groups: _____
Existing: _____
New: _____
NOTICE
All contractors and subcontractors are required to be licensed with the Oregon Construction Contractors Board under ORS 701 and may be required to be licensed in the jurisdiction in which work is being performed. If the applicant is exempt from licensing, the following reasons apply:
BUILDING PERMIT FEES*
<i>Please refer to fee schedule</i>
Fees due upon application
Amount received
Date received:

**This permit application expires
if a permit is not obtained within 180 days
after it has been accepted as complete**

* Fee methodology set by Tri-County Building Industry Service Board



COMMUNITY DEVELOPMENT DEPARTMENT
Building and Code Enforcement

INSPECTION REQUEST

503-992-3206

Site Address 1806 22nd Ave

Contractor

Phone Number

Scheduled Inspection Date 10/18/05

Mon [] Tues [x] Wed [] Thurs [] Fri []

AM [x] PM [] other

Permit Number 00352

- BUILDING
Footing / Pier
Foundation Wall
Underfloor (P & B)
Shear
Framing
Insulation
Approach/Sidewalk
Other
Planning
Final

- PLUMBING
Underfloor (P & B)
Top Out (Rough)
Water Line
Rain/Crawl Drains
Storm Drainage
Sanitary Sewer
Backflow Device
Water Heater
Other
Final

- MECHANICAL
Gas Piping
Underfloor (P & B)
Rough Mechanical
HVAC (Final)
Other

- MANUFACTURED HOME
M/H Set-Up
M/H Mechanical
M/H Water/Sewer
M/H Electrical Feeder
M/H Final
Other

Comments:

- [x] APPROVED
[] NOT APPROVED (REINSPECTION REQUIRED)
[] APPROVED AFTER CORRECTIONS (NO REINSPECTION REQUIRED)
[] STOP WORK

CORRECTIONS: PERIMETER RD'S AND U.F. PLUMBING

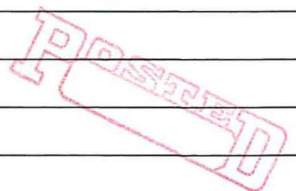

Date: 10/18/05

Inspector: [Signature]



COMMUNITY DEVELOPMENT DEPARTMENT
Building and Code Enforcement

INSPECTION REQUEST

503-992-3206

Site Address 1806 22nd Ave
Contractor John
Phone Number 503-936-7462

Scheduled Inspection Date 10/20/05
Mon [] Tues [] Wed [] Thurs [x] Fri []
AM [] PM [] other []
Permit Number 00192

BUILDING

PLUMBING

MECHANICAL

MANUFACTURED HOME

- Footing / Pier
Foundation Wall
Underfloor (P & B)
Shear
Framing
Insulation
Approach/Sidewalk
Other
Planning
Final

- Underfloor (P & B)
Top Out (Rough)
Water Line
Rain/Crawl Drains
Storm Drainage
Sanitary Sewer
Backflow Device
Water Heater
Other
Final

- Gas Piping
Underfloor (P & B) [x]
Rough Mechanical
HVAC (Final)
Other

- M/H Set-Up
M/H Mechanical
M/H Water/Sewer
M/H Electrical Feeder
M/H Final
Other

Comments:

[x] APPROVED

[] NOT APPROVED
(REINSPECTION REQUIRED)

[] APPROVED AFTER
CORRECTIONS
(NO REINSPECTION REQUIRED)

[] STOP WORK

CORRECTIONS:

POSTED

Date: 10-20-05

Inspector: [Signature]



COMMUNITY DEVELOPMENT DEPARTMENT
Building and Code Enforcement

INSPECTION REQUEST

503-992-3206

Site Address 1806 22nd Ave

Contractor

Phone Number

Scheduled Inspection Date 10/20/05

Mon [] Tues [] Wed [] Thurs [] Fri [X]

AM [] PM [] other

Permit Number 00224

BUILDING

PLUMBING

MECHANICAL

MANUFACTURED HOME

- Footing / Pier
Foundation Wall
[X] Underfloor (P & B)
Shear
Framing
Insulation
Approach/Sidewalk
Other
Planning
Final

- Underfloor (P & B)
Top Out (Rough)
Water Line
Rain/Crawl Drains
Storm Drainage
Sanitary Sewer
Backflow Device
Water Heater
Other
Final

- Gas Piping
Underfloor (P & B)
Rough Mechanical
HVAC (Final)
Other

- M/H Set-Up
M/H Mechanical
M/H Water/Sewer
M/H Electrical Feeder
M/H Final
Other

Comments:

[] APPROVED

[X] NOT APPROVED (REINSPECTION REQUIRED)

[] APPROVED AFTER CORRECTIONS (NO REINSPECTION REQUIRED)

[] STOP WORK

CORRECTIONS:

1) Install Beana @ Interior BRACED wallpanel line as per R602-10.9 and approved print

Note: All framing Below GRADE to be pressure treated or covered w/ 1/2" P.T. ply and 30# felt w/ 26 GAGE GALV. tin for ground or concrete cover - Thank you (entry way)

POSTED

Date: 10-20-05

Inspector: [Signature]



COMMUNITY DEVELOPMENT DEPARTMENT
Building and Code Enforcement

INSPECTION REQUEST

503-992-3206

Site Address 1806 22nd Ave
Contractor John
Phone Number 503-936-7462

Scheduled Inspection Date 10/21/05
Mon [] Tues [] Wed [] Thurs [] Fri [x]
AM [x] PM [] other early
Permit Number BLD05-20224

- BUILDING: Footing / Pier, Foundation Wall, Underfloor (P & B) [x], Shear, Framing, Insulation, Approach/Sidewalk, Other, Planning, Final
PLUMBING: Underfloor (P & B), Top Out (Rough), Water Line, Rain/Crawl Drains, Storm Drainage, Sanitary Sewer, Backflow Device, Water Heater, Other, Final
MECHANICAL: Gas Piping, Underfloor (P & B), Rough Mechanical, HVAC (Final), Other
MANUFACTURED HOME: M/H Set-Up, M/H Mechanical, M/H Water/Sewer, M/H Electrical Feeder, M/H Final, Other
Comments:

[x] APPROVED [] NOT APPROVED (REINSPECTION REQUIRED) [] APPROVED AFTER CORRECTIONS (NO REINSPECTION REQUIRED) [] STOP WORK

CORRECTIONS: corrections completed

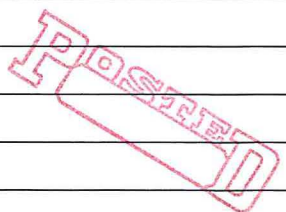

Date: 10.21.05

Inspector: [Signature]



COMMUNITY DEVELOPMENT DEPARTMENT
Building and Code Enforcement

INSPECTION REQUEST

503-992-3206

Site Address 1806 22nd St.
Contractor John
Phone Number 936-7462

Scheduled Inspection Date 10-11-05
Mon [] Tues [x] Wed [] Thurs [] Fri []
AM [] PM [] other []
Permit Number PLM05-00352

BUILDING

- Footing / Pier
Foundation Wall
Underfloor (P & B)
Shear
Framing
Insulation
Approach/Sidewalk
Other
Planning
Final

PLUMBING

- Underfloor (P & B)
Top Out (Rough)
[X] Water Line
Rain/Crawl Drains
Storm Drainage
[X] Sanitary Sewer
Backflow Device
Water Heater
Other
Final

MECHANICAL

- Gas Piping
Underfloor (P & B)
Rough Mechanical
HVAC (Final)
Other

MANUFACTURED HOME

- M/H Set-Up
M/H Mechanical
M/H Water/Sewer
M/H Electrical Feeder
M/H Final
Other

Comments:

[x] APPROVED

[] NOT APPROVED
(REINSPECTION REQUIRED)

[] APPROVED AFTER
CORRECTIONS
(NO REINSPECTION REQUIRED)

[] STOP WORK

CORRECTIONS:

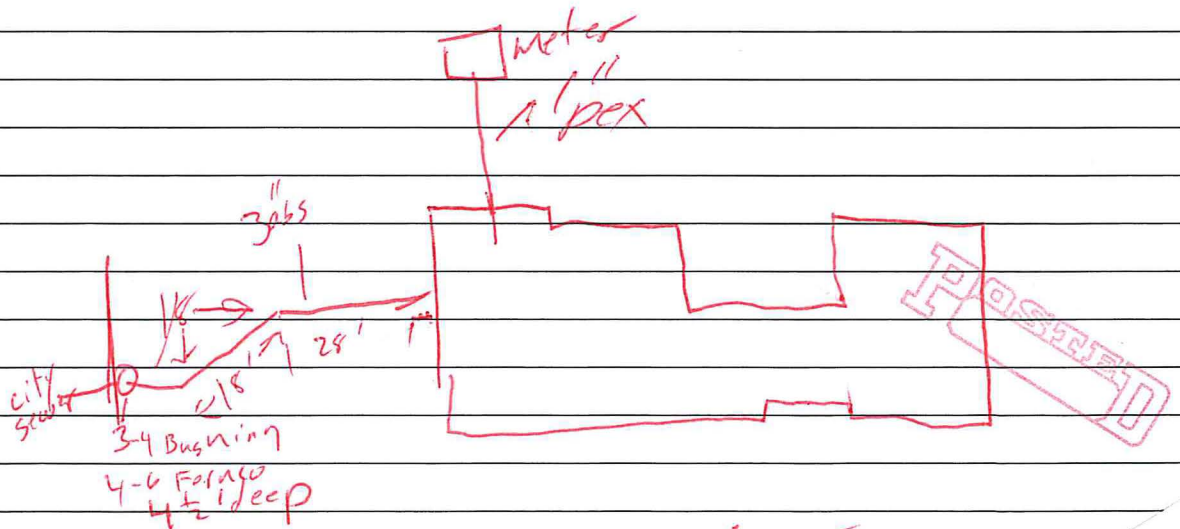

Date: 10-11-05

Inspector: [Signature]



COMMUNITY DEVELOPMENT DEPARTMENT
Building and Code Enforcement

INSPECTION REQUEST

503-992-3206

Site Address 1806 22nd Ave
Contractor
Phone Number

Scheduled Inspection Date 10/10/05
Mon [X] Tues [] Wed [] Thurs [] Fri []
AM [X] PM [] other
Permit Number BLD05-00324

- BUILDING: Footing / Pier, Foundation Wall, Underfloor (P & B), Shear, Framing, Insulation, Approach/Sidewalk, Other, Planning, Final
PLUMBING: Underfloor (P & B), Top Out (Rough), Water Line, Rain/Crawl Drains, Storm Drainage, Sanitary Sewer, Backflow Device, Water Heater, Other, Final
MECHANICAL: Gas Piping, Underfloor (P & B), Rough Mechanical, HVAC (Final), Other
MANUFACTURED HOME: M/H Set-Up, M/H Mechanical, M/H Water/Sewer, M/H Electrical Feeder, M/H Final, Other

- [] APPROVED
[] NOT APPROVED (REINSPECTION REQUIRED)
[X] APPROVED AFTER CORRECTIONS (NO REINSPECTION REQUIRED)
[] STOP WORK

CORRECTIONS: 1 Finish installing vents as per code

Note: Forms + REBAR AS PER PLAN

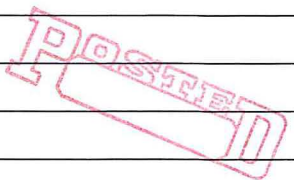

Date: 10-10-05
Inspector: [Signature]



COMMUNITY DEVELOPMENT DEPARTMENT
Building and Code Enforcement
INSPECTION REQUEST
 503-992-3206

Site Address 1806 22nd Ave
 Contractor _____
 Phone Number _____

Scheduled Inspection Date 11/1/06
 Mon Tues Wed Thurs Fri
 AM PM other _____
 Permit Number PLM 06-00092

BUILDING

- Footing / Pier
- Foundation Wall
- Underfloor (P & B)
- Shear
- Framing
- Insulation
- Approach/Sidewalk
- Other
- Planning
- Final

PLUMBING

- Underfloor (P & B)
- Top Out (Rough)
- Water Line
- Rain/Crawl Drains
- Storm Drainage
- Sanitary Sewer
- Backflow Device
- Water Heater
- Other
- Final

MECHANICAL

- Gas Piping
- Underfloor (P & B)
- Rough Mechanical
- HVAC (Final)
- Other

MANUFACTURED HOME

- M/H Set-Up
- M/H Mechanical
- M/H Water/Sewer
- M/H Electrical Feeder
- M/H Final
- Other

Comments:

Never Inspected

- APPROVED NOT APPROVED (REINSPECTION REQUIRED) APPROVED AFTER CORRECTIONS REINSPECTION FEE IS REQUIRED BEFORE NEXT INSPECTION \$ _____

CORRECTIONS:

watts 775 QT
Serial # 40991
Located NW corner of house

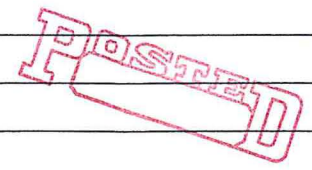

Date: _____ Inspector: _____

City of Forest Grove

For Inspections
Call the 24 Hour Inspection Line
(503-992-3206)

BUILDING PERMIT

PERMIT NO.: **BLD05-00224**
APPLIED: **9/2/2005**
ISSUED: **9/19/2005**
EXPIRES: **3/19/2006**

SITE ADDRESS: **1806 22ND AVE**

ASSESSOR'S PARCEL NO.: **1N331CC-10600**

PROJECT DESCRIPTION: **NEW SFR - IN FILL - BED 3 BATH 2**

<p><u>OWNER/APPLICANT</u></p> <p>HALL, ANNE 1806 22ND AVE FOREST GROVE OR 97116</p>	<p><u>CONTRACTOR</u></p> <p>BILL WREN & SONS INC PO BOX 980 NORTH PLAINS OR 97133 121914</p>
--	--

<p>TYPE OF WORK: NEW</p> <p>TYPE OF USE: SF</p> <p>CENSUS CATEGORY:</p> <p>ZONING:</p> <p>Occupancy Groups</p> <hr/> <p>1: 2:</p> <p>3: 4:</p> <p>Construction Types</p> <hr/> <p>1: 2:</p> <p>3: 4:</p>	<p>AREA</p> <hr/> <p>LOT: 0sf</p> <p>1ST FLR: 0sf</p> <p>2ND FLR: 0sf</p> <p>BASEMENT: 0sf</p> <p>GAR/CARPORT: 0sf</p> <p>OTHER: 0sf</p> <p>NUMBER OF UNITS: 0</p> <p>STORIES: 0</p> <p>BUILDING HEIGHT: 0 ft</p>	<p>VALUE: \$151,902.00</p> <p>REQUIRED SETBACKS:</p> <hr/> <p>FRONT: 14.00 ft</p> <p>SIDE 1: 8 ft</p> <p>SIDE 2: 38 ft</p> <p>REAR: 51 ft</p> <p>REQUIRED PARKING</p> <hr/> <p>TOTAL: 2</p> <p>HANDICAPPED: 0</p> <p>COMPACT: 0</p> <p>IMPRV SURF: 0 sf</p>
--	---	---

FEES			
Type	By	Date	Amount
PRMT	MLP	9/19/2005	\$1,182.65
SUCH	MLP	9/19/2005	\$94.61
PLAN	MLP	9/2/2005	\$768.72
SITE	MLP	9/2/2005	\$242.00
EXCA	MLP	9/19/2005	\$23.00
(additional fees not shown here) Total:			\$3,259.98

NOTES:

I hereby acknowledge that I have read this permit and state that the above information is correct, and agree to comply with all ordinances and state and federal laws regulating activities covered by this permit.

Issued by _____

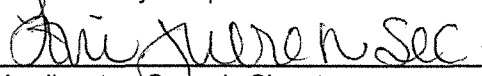
Applicant or Owner's Signature

CONDITIONS OF APPROVAL:

1 INSTALL CONSTRUCTION ACCESS - 8" MINIMUM DEPTH BASE ROCK PAD, 20' MINIMUM LENGTH AND W DO NOT TRACK MUD ONTO STREETS

City of Forest Grove

For Inspections
Call the 24 Hour Inspection Line
(503-992-3206)

BUILDING PERMIT

PERMIT NO.: BLD05-00224
APPLIED: 9/2/2005
ISSUED: 9/19/2005
EXPIRES: 3/19/2006

- 2 INSTALL EROSION CONTROL FENCING AS REQUIRED PER CLEAN WATER SERVICES STANDARD SPECIFICATIONS.
- 3 PIPE ALL ROOF WATER THROUGH 3" MINIMUM DIAMETER PIPE PER UNIFORM PLUMBING CODE AND THROUGH CURB WEEP HOLES TO STREET PER CITY STANDARD SPECIFICATIONS.
- 4 INSTALL CONCRETE SIDEWALK AND DRIVE APPROACH PER CITY STANDARD SPECIFICATIONS.
- 5 THE STREET ADDRESS SHALL BE DISPLAYED IN A PROMINENT POSITION NEAR THE ENTRANCE TO THE BUILDING. NUMBERS SHALL BE AT LEAST 4 INCHES HIGH, OF A CONTRASTING COLOR AND VISIBLE FROM THE STREET. MUNICIPAL CODE SECTION 9.215
- 6 THREE STREET TREES TO BE PLANTED IN PARKWAY. INSTALLATION TO BE COMPLETED BY THE CITY
- 7 Note: General Contractor - see red-lined site plan and attachments from the Light and Power Department; regarding electric service installation. Pass needed information on to electrical and other contractors. Contact the L&P Department for location of riser on pole.

24 Hour Notice Required For All Inspections

City of Forest Grove

For Inspections
Call the 24 Hour Inspection Line
(503-992-3206)

MECHANICAL PERMIT

PERMIT NO.: MEC05-00192
ISSUED: 9/19/2005
APPLIED: 9/2/2005
EXPIRES: 3/19/2006

SITE ADDRESS: 1806 22ND AVE
ASSESSOR'S PARCEL NO.: 1N331CC-10600
TYPE OF WORK: NEW
TYPE OF USE: SFD
PROJECT DESCRIPTION: NEW SFR - IN FILL - BED 3 BATH 2

<u>OWNER/APPLICANT</u> HALL, ANNE 1806 22ND AVE FOREST GROVE OR 97116	<u>CONTRACTOR</u>
--	-------------------

Equipment	
Type of Equipment	Quantity
Clothes Dryers	1.00
Exhaust Hoods	1.00
Fireplace	1.00
Gas Outlets	4.00
Furnaces Under 100,000	1.00
Ventilation Fans	3.00
Water Heater Vent	1.00

Fees			
Type	By	Date	Amount
PRMT	RMM	9/19/2005	\$69.70
SUCH	RMM	9/19/2005	\$5.58
Total:			\$75.28

NOTES:

I hereby acknowledge that I have read this permit and state that the above information is correct, and agree to comply with all ordinances and state and federal laws regulating activities covered by this permit.

Issued By: _____

Applicant or Owner's Signature

24 Hour Notice Required For All Inspections

CONDITIONS OF APPROVAL:

City of Forest Grove

For Inspection
Call the 24 Hour Inspection Line
(503-992-3206)

PLUMBING PERMIT

PERMIT NO.: **PLM05-00352**
APPLIED: **9/2/2005**
ISSUED: **9/19/2005**
EXPIRES: **3/19/2006**

SITE ADDRESS: **1806 22ND AVE**
ASSESSOR'S PARCEL NO.: **1N331CC-10600**
TYPE OF WORK: **New**
TYPE OF USE: **Single Family Residential**
PROJECT DESCRIPTION: **NEW SFR - IN FILL - BED 3 BATH 2**

<p><u>OWNER/APPLICANT</u></p> <p>HALL, ANNE 1806 22ND AVE FOREST GROVE OR 97116</p>	<p><u>CONTRACTOR</u></p> <p>AAPLE PLUMBING PO BOX 1543 HILLSBORO OR 97123 104311</p>
---	--

Plumbing Fixtures		Fees			
Fixture Type	Quantity	Type	By	Date	Amount
		BTH1	RMM	9/19/2005	\$316.75
		SUCH	RMM	9/19/2005	\$25.34
Total:					\$342.09

NOTES:

I hereby acknowledge that I have read this permit and state that the above information is correct, and agree to comply with all ordinances and state and federal laws regulating activities covered by this permit.

Issued by _____

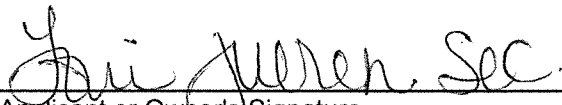
 Applicant or Owner's Signature

CONDITIONS OF APPROVAL :

1)

Building Permit Application

city of forest grove

City of Forest Grove

Phone: 503-992-3229

Fax: 503-992-3202

1924 Council Street/P.O. Box 326, Forest Grove, OR 97116

Inspection Request Line: 503-992-3206

Permit Number:

BLD05-00224

TYPE OF WORK	
<input type="checkbox"/> New construction	<input type="checkbox"/> Demolition
<input checked="" type="checkbox"/> Addition/alteration/replacement	<input type="checkbox"/> Other:
CATEGORY OF CONSTRUCTION	
<input checked="" type="checkbox"/> 1- and 2-family dwelling	<input type="checkbox"/> Commercial/Industrial
<input type="checkbox"/> Accessory building	<input type="checkbox"/> Multi-family
<input type="checkbox"/> Master builder	<input type="checkbox"/> Other:
JOB SITE INFORMATION AND LOCATION	
Job site address: <u>1806 22nd St.</u>	
City/State/ZIP: <u>Forest Grove, OR 97116</u>	
Suite/bldg./apt. no.:	Project name: <u>Anne Hall Residence</u>
Cross street/directions to job site:	
Subdivision:	
Lot no.:	
Tax map/parcel no.: <u>1N331CC10600</u>	
DESCRIPTION OF WORK	
<u>Replacement of existing dwelling</u>	
<input checked="" type="checkbox"/> PROPERTY OWNER <input type="checkbox"/> TENANT	
Name: <u>Anne Hall</u>	
Address: <u>1806 22nd St.</u>	
City/State/ZIP: <u>Forest Grove, OR 97116</u>	
Phone: <u>(503) 357-3055</u>	Fax: ()
<input checked="" type="checkbox"/> APPLICANT <input type="checkbox"/> CONTACT PERSON	
Business name: <u>Bill Wren & Sons, Inc.</u>	
Contact name: <u>John Wren</u>	
Address: <u>PO Box 936</u>	
City/State/ZIP: <u>North Plains, OR 97133</u>	
Phone: <u>(503) 647-2736</u>	Fax: <u>(503) 647-5000</u>
E-mail: <u>cell 503-936-7462</u>	
CONTRACTOR	
Business name: <u>Bill Wren & Sons, Inc.</u>	
Address: <u>PO Box 936</u>	
City/State/ZIP: <u>North Plains, OR 97133</u>	
Phone: <u>(503) 647-2736</u>	Fax: <u>(503) 647-5000</u>
CCB lic.: <u>121914</u>	
Authorized signature: <u>Loni J. Wren Sec.</u>	
Print name: <u>Loni J. Wren</u>	Date: <u>8/25/05</u>

REQUIRED DATA: 1- AND 2-FAMILY DWELLING	
Permit fees* are based on the value of the work performed. Indicate the value (rounded to the nearest dollar) of all equipment, materials, labor, overhead, and the profit for the work indicated on this application.	
Valuation <u>App. \$150,000.00 +/-</u>	
Number of bedrooms: <u>3</u>	
Number of bathrooms: <u>2</u>	
Total number of floors: <u>1</u>	
New dwelling area: <u>1503</u> square feet	
Garage/carport area: <u>536</u> square feet	
Covered porch area: square feet	
Deck area: square feet	
Other structure area: square feet	
REQUIRED DATA: COMMERCIAL-USE CHECKLIST	
Permit fees* are based on the value of the work performed. Indicate the value (rounded to the nearest dollar) of all equipment, materials, labor, overhead, and the profit for the work indicated on this application.	
Valuation	
Existing building area: square feet	
New building area: square feet	
Number of stories:	
Type of construction:	
Occupancy groups:	
Existing:	
New:	
NOTICE	
All contractors and subcontractors are required to be licensed with the Oregon Construction Contractors Board under ORS 701 and may be required to be licensed in the jurisdiction in which work is being performed. If the applicant is exempt from licensing, the following reasons apply:	
BUILDING PERMIT FEES*	
Please refer to fee schedule	
Fees due upon application	
Amount received	
Date received:	

Richard Wren
9-15-05
BUILDING

Plumbing Permit Application

city of forest grove

City of Forest Grove

Phone: 503-992-3229

Fax: 503-992-3202

1924 Council Street/P.O. Box 326, Forest Grove, Oregon 97116

Inspection Request Line: 503-992-3206

Permit Number:

PLM.05-00352

TYPE OF WORK	
<input type="checkbox"/> New construction	<input type="checkbox"/> Demolition
<input checked="" type="checkbox"/> Addition/alteration/replacement	<input type="checkbox"/> Other:
CATEGORY OF CONSTRUCTION	
<input checked="" type="checkbox"/> 1- and 2-family dwelling	<input type="checkbox"/> Commercial/industrial
<input type="checkbox"/> Accessory building	<input type="checkbox"/> Multi-family
<input type="checkbox"/> Master builder	<input type="checkbox"/> Other:
JOB SITE INFORMATION AND LOCATION	
Job site address: 1806 22nd St.	
City/State/ZIP: Forest Grove, OR 97116	
Suite/bldg./apt. no.:	Project name: Anne Hall Residence
Cross street/directions to job site:	
Subdivision:	
Lot no.:	
Tax map/parcel no.: IN331CC10600	
DESCRIPTION OF WORK	
Replacement of existing dwelling	
<input checked="" type="checkbox"/> PROPERTY OWNER	<input type="checkbox"/> TENANT
Name: Anne Hall	
Address: 1806 22nd St.	
City/State/ZIP: Forest Grove, OR 97116	
Phone: (503) 357-3055	Fax: ()
<input checked="" type="checkbox"/> APPLICANT	<input type="checkbox"/> CONTACT PERSON
Business name: Bill Wren & Sons, Inc.	
Contact name: John Wren	
Address: PO Box 936	
City/State/ZIP: North Plains, OR 97133	
Phone: (503) 647-2736	Fax: (503) 647-5000
E-mail: cell 503-936-7462	
CONTRACTOR	
Business name: Apple Plumbing	
Address: PO Box 1543	
City/State/ZIP: Hillsboro, OR 97123	
Phone: (503) 648-1855	Fax: ()
CCB lic.: 104311	PB Lic. no.: 34-308

FEE SCHEDULE			
For special information use checklist.			
Description	Qty.	Ea.	Total
New 1- 2-family dwellings (includes 100 ft. for each utility connection)			
SFR (1) bath		239.50	
SFR (2) bath		316.75	
SFR (3) bath 2 Bath, KH	3	386.25	
Each additional bath/kitchen		41.72	
Fire sprinkler (___ sq. ft.)		46.35	
Site utilities			
Catch basin or area drain		13.90	
Drywell, leach line, or trench drain		13.90	
Footing drain (no. linear ft.: ___)		46.35	
Manufactured home utilities			
Manholes		13.90	
Rain drain connector	1	13.90	
Sanitary sewer (no. linear ft.: ___)		46.35	
Storm sewer (no. linear ft.: ___)		46.35	
Water service (no. linear ft.: ___)		46.35	
Fixture or Item			
Absorption valve		13.90	
Backflow preventer		13.90	
Backwater valve		13.90	
Clothes washer	1	13.90	
Dishwasher	1	13.90	
Drinking fountain		13.90	
Ejectors/sump		13.90	
Expansion tank		13.90	
Fixture/sewer cap		13.90	
Floor drain/floor sink/hub		13.90	
Garbage disposal		13.90	
Hose bib	2	13.90	
Ice maker	1	13.90	
Interceptor/grease trap		13.90	
Medical gas (value: \$ ___)			
Primer		13.90	
Roof drain (commercial)		13.90	
Sink/basin/lavatory		13.90	
Tub/shower/shower pan	2	13.90	
Urinal		13.90	
Water closet	2	13.90	
Water heater	1	13.90	
Other:		13.90	
Other:			
Subtotal			
Minimum permit fee			\$ 27.30
Plan review (___ % of permit fee)			
State surcharge (8% of permit fee)			
TOTAL PERMIT FEE			

This permit application expires if a permit is not obtained within 180 days after it has been accepted as complete.

* Fee methodology set by Tri-County Building Industry Service Board 440-4616T (10/02/COM/WEB)

Authorized signature: Loni J. Wren, Sec. 1-31-08 10,000

Print name: Loni J. Wren, Sec. Date: 8/25/05

Mechanical Permit Application



City of Forest Grove Phone: 503-992-3229 Fax: 503-992-3202

1924 Council Street/P.O. Box 326, Forest Grove, OR 97116

Inspection Request Line: 503-992-3206

Permit Number:

MEC05-00192

TYPE OF WORK	
<input type="checkbox"/> New construction	<input checked="" type="checkbox"/> Addition/alteration/replacement
<input type="checkbox"/> Demolition	<input type="checkbox"/> Other:
CATEGORY OF CONSTRUCTION	
<input checked="" type="checkbox"/> 1- and 2-family dwelling	<input type="checkbox"/> Commercial/industrial <input type="checkbox"/> Accessory building
<input type="checkbox"/> Multi-family	<input type="checkbox"/> Master builder <input type="checkbox"/> Other:
JOB SITE INFORMATION AND LOCATION	
Job site address: <u>1806 22nd St.</u>	
City/State/ZIP: <u>Forest Grove, OR 97116</u>	
Suite/bldg./apt. no.:	Project name: <u>Anne Hall Residence</u>
Cross street/directions to job site:	
Subdivision: Lot no.:	
Tax map/parcel no.: <u>1N331CC10600</u>	
DESCRIPTION OF WORK	
<u>Replacement of existing dwelling.</u>	
<input checked="" type="checkbox"/> PROPERTY OWNER	<input type="checkbox"/> TENANT
Name: <u>Anne Hall</u>	
Address: <u>1806 22nd St.</u>	
City/State/ZIP: <u>Forest Grove, OR 97116</u>	
Phone: <u>(503) 357-3055</u>	Fax: ()
<input checked="" type="checkbox"/> APPLICANT	<input type="checkbox"/> CONTACT PERSON
Business name: <u>Bill Wren & Sons, Inc.</u>	
Contact name: <u>John Wren</u>	
Address: <u>PO Box 936</u>	
City/State/ZIP: <u>North Plains, OR 97133</u>	
Phone: <u>(503) 647-2736</u>	Fax: <u>(503) 647-5000</u>
E-mail: <u>cell 503-936-7462</u>	
CONTRACTOR	
Business name:	
Address:	
City/State/ZIP:	
Phone: ()	Fax: ()
CCB lic.:	

COMMERCIAL FEE* SCHEDULE - USE CHECKLIST			
Mechanical permit fees* are based on the value of the work performed. Indicate the value (rounded to the nearest dollar) of all mechanical materials, equipment, labor, overhead, and profit.			
Value: \$			
RESIDENTIAL EQUIPMENT / SYSTEMS FEES*			
For special information use checklist.			
Description	Qty.	En.	Total
Heating/cooling			
Furnace add-on air conditioning		11.90	
Gas heat pump		8.95	
Duct work		15.85	
Hydronic hot water system			
Residential boiler (radiator or hydronic)		11.90	
Unit heaters (fuel-type, not electric), in-wall, in-duct, suspended, etc.		11.90	
Flue/vent for any of above		6.00	
Other:		8.95	
Other fuel appliances			
Water heater		8.95	
Gas fireplace		8.95	
Flue vent for water heater or gas fireplace		6.00	
Log lighter (gas)		8.95	
Wood/pellet stove		8.95	
Wood fireplace/insert		8.95	
Chimney/liner/flue/vent		6.00	
Other:		8.95	
Environmental exhaust and ventilation			
Range hood/other kitchen equipment		8.95	
Clothes dryer exhaust		8.95	
Single-duct exhaust (bathrooms, toilet compartments, utility rooms)		6.00	
Attic/crawl space fans		6.00	
Other:		8.95	
Fuel piping			
\$4.00 for first four outlets; \$1.05 for each additional			
Furnace, etc.		By Outlet #	
Gas heat pump		By Outlet #	
Wall/suspended/unit heater		By Outlet #	
Water heater		By Outlet #	
Fireplace		By Outlet #	
Range		By Outlet #	
Barbecue		By Outlet #	
Clothes dryer (gas)		By Outlet #	
Other:			
MECHANICAL PERMIT FEES*			
Subtotal			
Minimum permit fee			27.30
Plan review (% of permit fee)			
State surcharge (8% of permit fee)			
TOTAL PERMIT FEE			

This permit application expires if a permit is not obtained within 180 days after it has been accepted as complete.

* Fee methodology set by Tri-County Building Industry Service Board 440-4617T (11/02/COM/WEB)

Authorized signature: Joni Wren, Sec
 Print name: Loni J. Wren, sec. Date: 8/25/05



AUG 26 2005

Faxed 8/26 8:50 a.m.



File Number 05-003656

Sensitive Area Pre-Screening Site Assessment

Jurisdiction	<u>City of Forest Grove</u>	Date	<u>8/26/05</u>
Map & Tax Lot	<u>1N3310C10600</u>	Owner	<u>Anne Hall</u>
Site Address	<u>1806 22nd Street</u> <u>Forest Grove, OR 97116</u>	Contact	<u>John Wren</u>
Proposed Activity	<u>replacement of</u> <u>existing dwelling.</u>	Company	<u>Bill Wren & Sons, Inc.</u>
		Address	<u>PO Box 980</u>
		City State Zip	<u>North Plains, OR 97133</u>
		Phone	<u>503-647-2736/cell 503-936-</u>
		Fax	<u>503-647-5000 7462</u>

Official use only below this line

Y	N	NA		Y	N	NA
<input type="checkbox"/>	<input checked="" type="checkbox"/>	<input type="checkbox"/>	Sensitive Area Composite Map Map # <u>1N4WD</u>	<input type="checkbox"/>	<input type="checkbox"/>	<input checked="" type="checkbox"/> Stormwater Infrastructure maps QS # <u>3086</u>
<input type="checkbox"/>	<input type="checkbox"/>	<input checked="" type="checkbox"/>	Locally adopted studies or maps Specify _____	<input type="checkbox"/>	<input type="checkbox"/>	<input checked="" type="checkbox"/> Other Specify _____

Based on a review of the above information and the requirements of Clean Water Services Design and Construction Standards Resolution and Order No. 04-9:

- Sensitive areas potentially exist on site or within 200' of the site. THE APPLICANT MUST PERFORM A SITE CERTIFICATION PRIOR TO ISSUANCE OF A SERVICE PROVIDER. If Sensitive Areas exist on the site or within 200 feet on adjacent properties, a Natural Resources Assessment Report may also be required.
- Sensitive areas do not appear to exist on site or within 200' of the site. This pre-screening site assessment does NOT eliminate the need to evaluate and protect water quality sensitive areas if they are subsequently discovered. This document will serve as your Service Provider letter as required by Resolution and Order 04-9, Section 3.02.1. All required permits and approvals must be obtained and completed under applicable local, state, and federal law.
- The proposed activity does not meet the definition of development. NO SITE ASSESSMENT OR SERVICE PROVIDER LETTER IS REQUIRED.

Reviewer Comments:

Reviewed By:

Chuck Burkholder

Date:

9/1/05

Post-it® Fax Note	7671	Date	<u>9/1/05</u>	# of pages	<u>1</u>
To	<u>John Wren</u>	From	<u>Chuck Burkholder</u>		
Co./Dept.		Co.	<u>CWS</u>		
Phone #		Phone #	<u>503-681-5100</u>		
Fax #	<u>503-647-5000</u>	Fax #			

Official use only
 Returned to Applicant
 Mail Fax Counter
 Date 9/1/05 By [Signature]

COPY

Sanitary

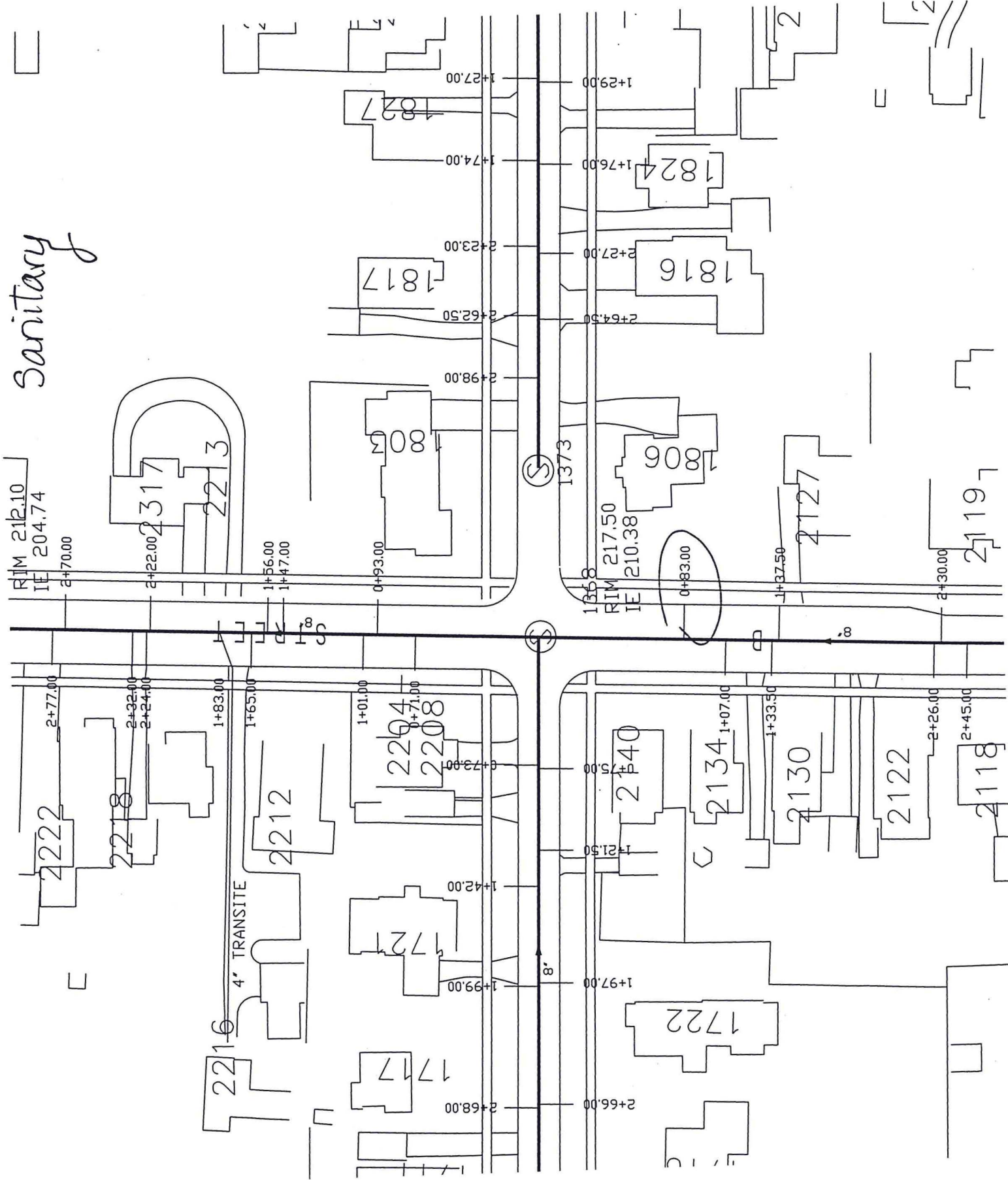

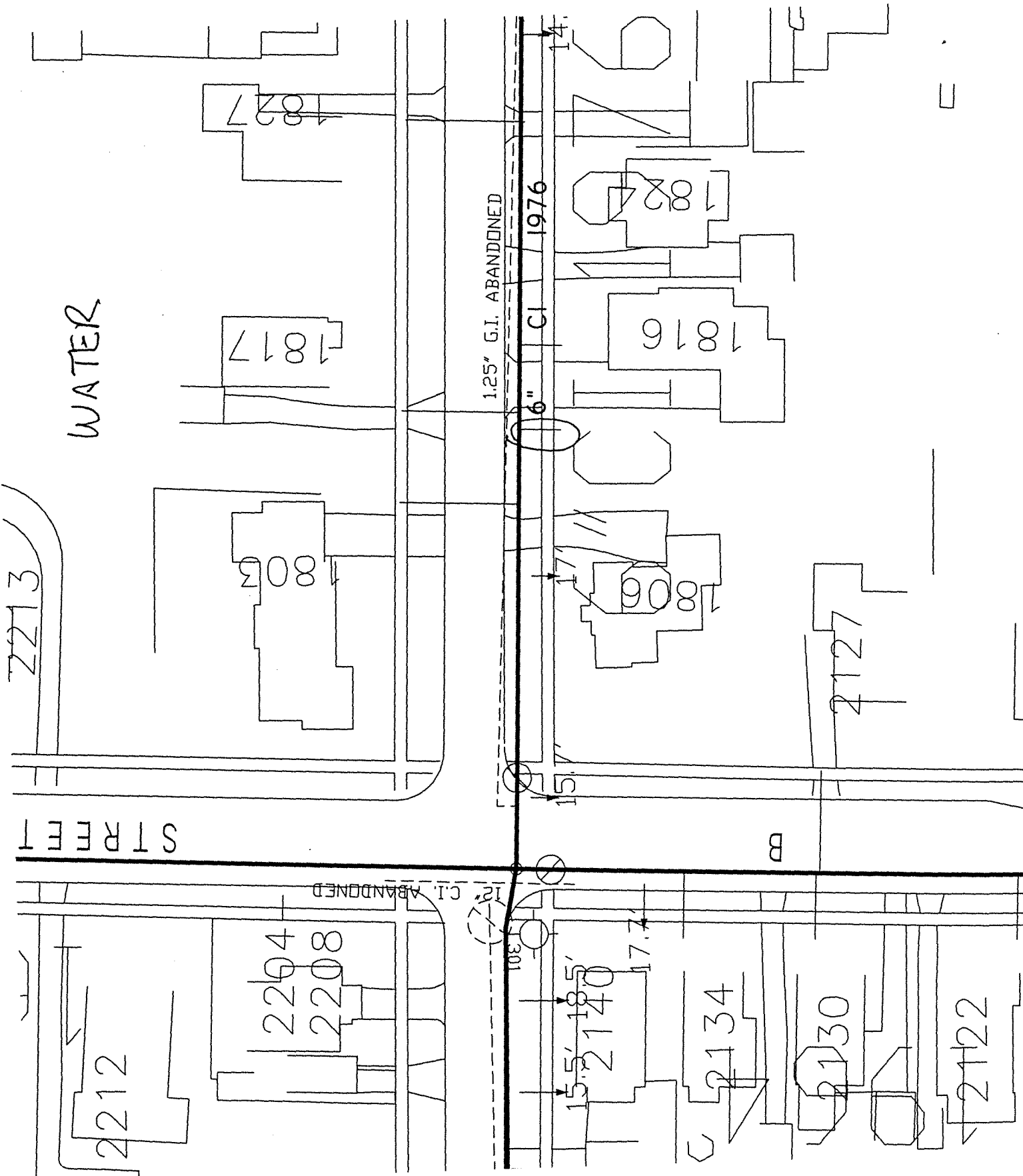

WATER

2213

STREET

2212

2204
2208

12" C.I. ABANDONED

1301

15.5'
18.5'
2140

2134

2130

2122

1817

803

1827

1.25" G.I. ABANDONED

6"

CI

1976

15.7'

17.7'

1806

1816

1827

14.7'

2127

B

C

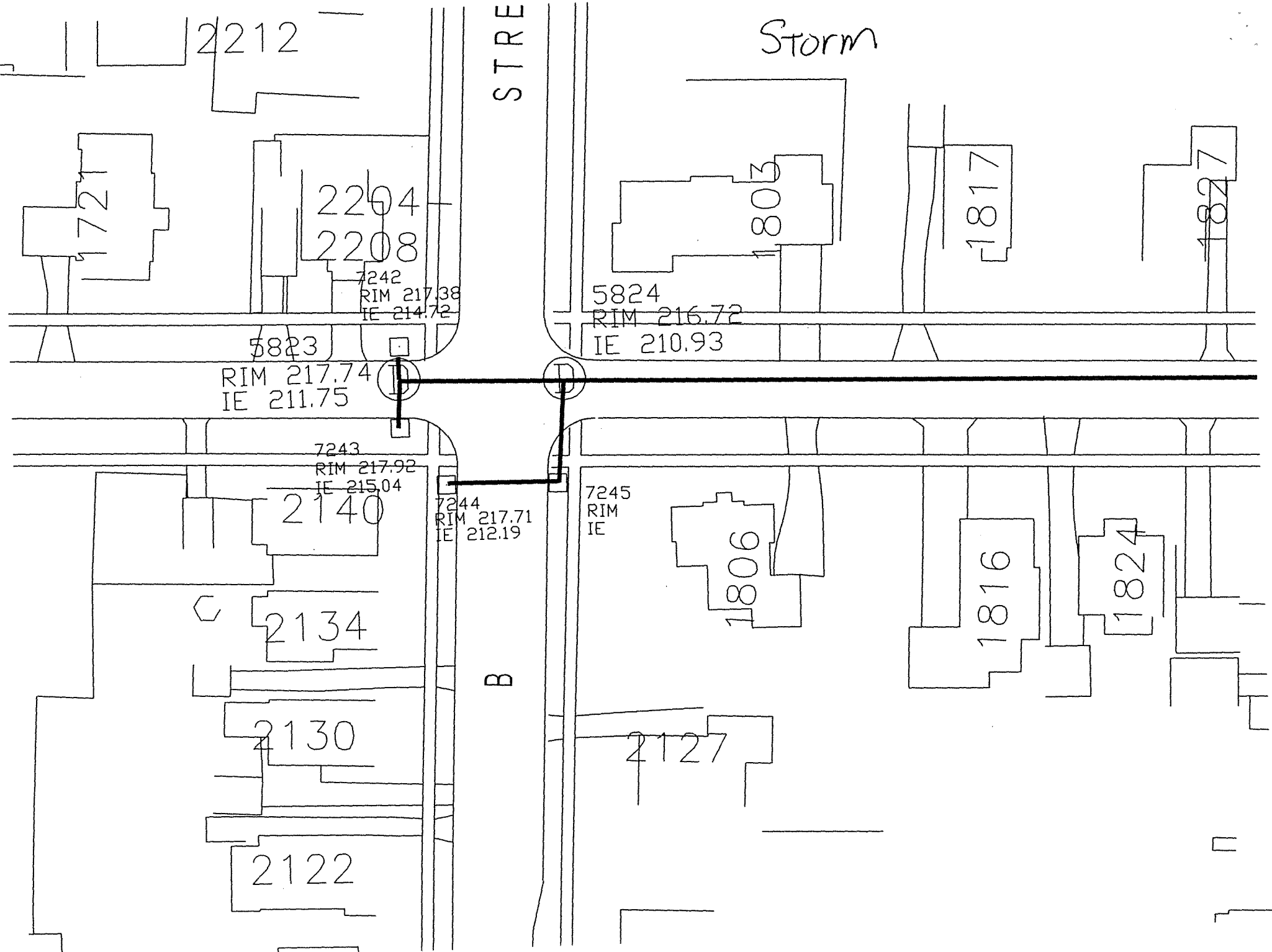

City of Forest Grove

1806 22ND AVENUE

Light and Power Review

Single Family Residential

1. Builder to locate meter base on EAST wall of GARAGE within 3 feet of the front corner of the structure, or as follows: _____

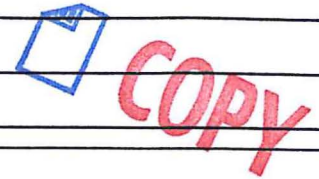

2. If underground service, builder to provide and install 3" Sch. 40 PVC conduit (maximum of three (3) 90 degree bends) from the meter base to the pedestal (or pole) located at:

NORTHEAST CORNER OF LOT, SEE
ATTACHED RED-LINED SITE PLAN ...

Light & Power Department to inspect conduit installation prior to backfilling.

Contact L&P Dept. for specifications.

3. Utility-provided temporary construction service, including permit, is available for a \$150.00 fee. In addition, line extension fees are charged if the cost to connect to the Utility System exceeds a pre-set allowance. Contact the City Light & Power Department at (503)992-3250.

Comments: The City of Forest Grove Light & Power Dept. can provide and install the duct run for U.G. power service for an additional cost. Contact the Light & Power Dept. for information.

NOTE: If service is to be over 200 amps, 4" Sch. 40 PVC duct must be installed. If service is to be 400 amps or more, contact Light & Power Dept.

Additional comments:

THERE IS A \$330⁰⁰ ALLOWANCE FOR THE
INSTALLATION OF THE ELECTRICAL SERVICE -
ALL COSTS OVER THE ALLOWANCE WILL BE
BILLED TO THE CUSTOMER ...

COPY

RECEIVED
SEP 09 2005
CITY OF FOREST GROVE

Residence 1806 22nd Ave., Forest Grove
Scale: 1 sq. = 4' OR 3/32" = 1'

CITY OF FOREST GROVE
LIGHT & POWER DEPT.
1818 B. STREET
P.O. BOX 329
FOREST GROVE, OR 97113

NOTE: USE THE CITY OF FOREST GROVE LIGHT & POWER DEPARTMENT SPECIFICATIONS, NOT PGE. IF SPECIFICATIONS ARE NOT CLEAR CALL (503) 992-3255

APPROVED

AS PER THIS RED-LINED SITE PLAN AND ATTACHMENTS . . .

N - 9/15/05

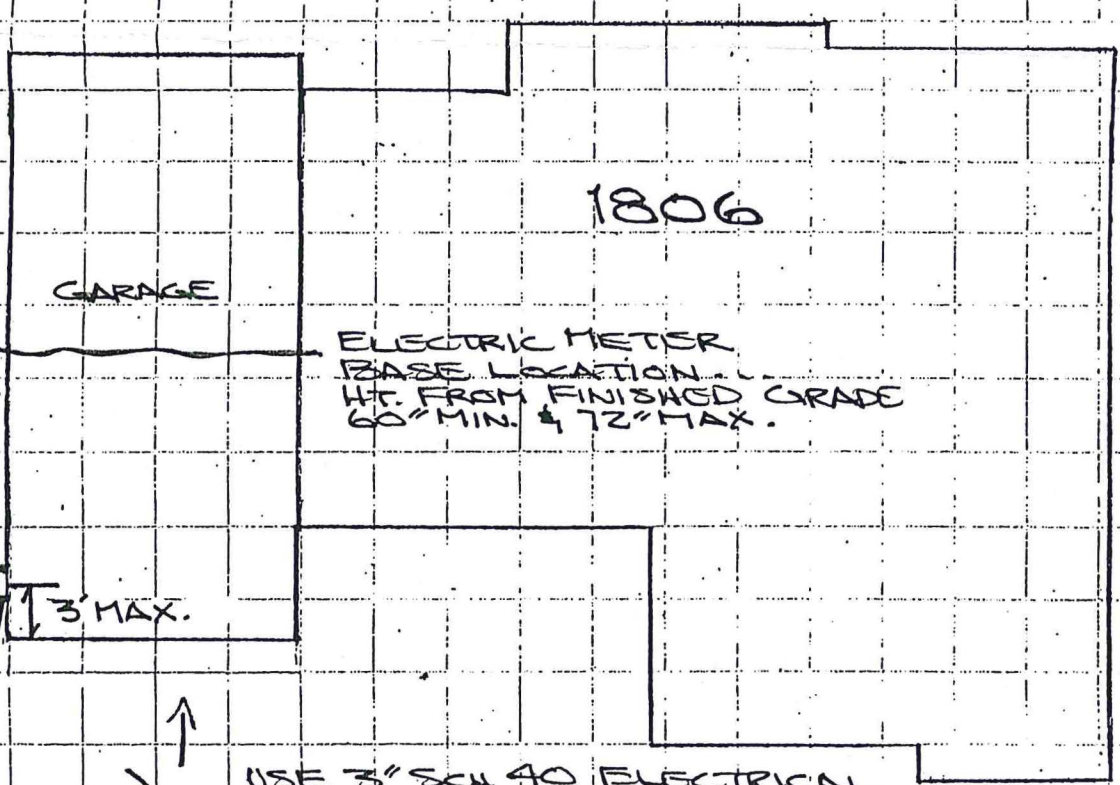

USE 3" SCH 40 ELECTRICAL PVC CONDUIT, MIN. DEPTH 36" (3-90° BENDS MAX. IN THIS DUCT RUN, INCLUDING 90° BEND AT EACH END OF DUCT RUN).

← 8" →

↓ 3" MAX. ↓

↑ 22" ↑

↓ 22" ↓

↑ 14" ↑

↓ 14" ↓

← 94.5" →

← 38" →

↑ 30" ↑

↓ 16" ↓

← 5" ← Sidewalk

← 105" ←

Curb

B Street

sidewalk

Curb

APPROX. LOCATION OF EXIST. POWER POLE.

22nd Ave.



Residence 1806 22nd Ave., Forest Grove

Scale: 1 sq. = 4'

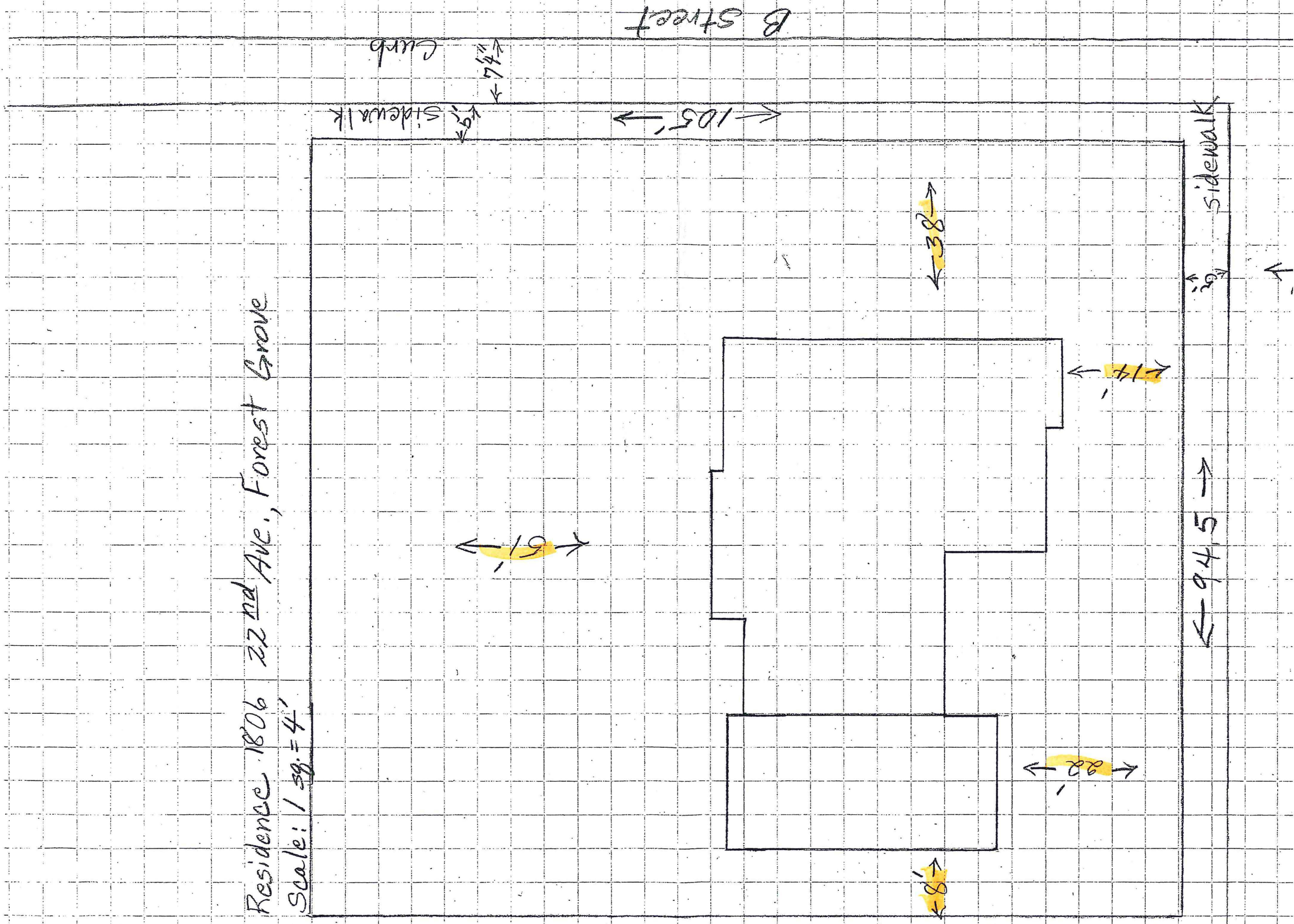



A place where businesses and families thrive.

City of Forest Grove

1924 Council St
Forest Grove, OR 97116
503-992-3229
Fax: 503-992-3202

Building Permit

Residential Plumbing

Permit Number: 311-23-000460-PLM

IVR Number: 311040976538

Web Address: www.forestgrove-or.gov

Email Address: cd@forestgrove-or.gov

Permit Issued: June 20, 2023
Project: MINOR LABEL INSPECTION

Application Date: June 20, 2023

TYPE OF WORK

Plumbing Specialty Code Edition: 2021

Category of Construction: Single Family Dwelling

Type of Work: Alteration

Submitted Job Value:

Description of Work: ***MINOR LABEL*** WATER HEATER INSTALL

JOB SITE INFORMATION

Worksite Address

1806 22ND AVE
FOREST GROVE OR

Parcel

1N331CC10600

Owner:

HALL ANNE F LIVING TRUST

Address:

1806 22ND AVE
FOREST GROVE, OR
97116-1616

LICENSED PROFESSIONAL INFORMATION

Business Name

GEO A MORLAN PLUMBING &
APPLIANCE CO - Primary

License

CCB

License Number

2734

Phone

503-624-9855

PENDING INSPECTIONS

Inspection

3999 Final Plumbing

Inspection Group

Plumb Res

Inspection Status

Pending

SCHEDULING INSPECTIONS

Various inspections are minimally required on each project and often dependent on the scope of work. Contact the issuing jurisdiction indicated on the permit to determine required inspections for this project.

Schedule or track inspections at www.buildingpermits.oregon.gov

Call or text the word "schedule" to 1-888-299-2821 use IVR number: 311040976538

Schedule using the Oregon ePermitting Inspection App, search "epermitting" in the app store

Permits expire if work is not started within 180 Days of issuance or if work is suspended for 180 Days or longer depending on the issuing agency's policy.

Per R105.7 and R 106.3.1, a copy of the building permit and one set of approved construction documents shall be available for review at the work site.

All provisions of laws and ordinances governing this type of work will be complied with whether specified herein or not. Granting of a permit does not presume to give authority to violate or cancel the provisions of any other state or local law regulating construction or the performance of construction.

ATTENTION: Oregon law requires you to follow rules adopted by the Oregon Utility Notification Center. Those rules are set forth in OAR 952-001-0010 through OAR 952-001-0090. You may obtain copies of the rules by calling the Center at (503) 232-1987.

All persons or entities performing work under this permit are required to be licensed unless exempted by ORS 701.010 (Structural/Mechanical), ORS 479.540 (Electrical), and ORS 693.010-020 (Plumbing).

PERMIT FEES

Fee Description	Quantity	Fee Amount
------------------------	-----------------	-------------------

Total Fees:

Note: This may not include all the fees required for this project.

Forest Grove Inspection Report

1924 Council Street
Forest Grove, OR 97116

Tel: (503)992-3229

Location:
1806 22ND AVE FOREST GROVE OR

Inspection Date:
Thu, 22 Jun 2023 08:41 AM

Owner:
HALL ANNE F LIVING TRUST

Record ID:
311-23-000460-PLM

Record Type:
Residential Plumbing

Result:
Approved

Inspection Type:
3999 Final Plumbing

Inspector: Yvette Hamilton

Phone: 503-992-3244

Email: yhamilton@forestgrove-or.gov

Comments:



Inspector

