

ORDINANCE NO. 19-1005

**AN ORDINANCE OF THE CITY OF OREGON CITY DESIGNATING THE PROPERTY
IDENTIFIED AS OAK TREE PARK AS A PARK UNDER
OREGON CITY CHARTER CHAPTER X**

WHEREAS, the Plat of "Oaktree" was accepted by the County Clerk on April 19, 1974, and contained three tracts (A, B and C) identified by the developers, David and Virginia Farr, as "Park Area" that was dedicated to the public; and

WHEREAS, Tract A on the northeasterly side of Lafayette Avenue (3-1E-12AB-03200) is identified as Oak Tree Park in the 1999 Parks Master Plan, a 0.5-acre undeveloped park; and

WHEREAS, Oak Tree Park is identified by the community and the City of Oregon City as a park property but it has never formally been designated as a park under Chapter X of the Oregon City Charter; and

WHEREAS, designating Oak Tree Park as a park under Chapter X of the City Charter would ensure protection of the park by preventing the transfer, sale, vacation or major changes to Oak Tree Park without a legal vote of the people; and

WHEREAS, the status of Oregon City's parks as charter parks has been discussed by the Parks & Recreation Advisory Committee (PRAC) and at a regular meeting held on January 24, 2019, PRAC recommended that staff prepare an ordinance for adoption by the City Commission recognizing Oak Tree Park as a charter park.

NOW, THEREFORE, OREGON CITY ORDAINS AS FOLLOWS:

Section 1. Oak Tree Park, identified as 3-1E-12AB-03200, with the boundaries as shown on the map attached to this Ordinance as Exhibit A, is hereby designated as a park in accordance with the Charter of Oregon City, Chapter X, Section 43, creating a permanent park for the enjoyment of the citizens of Oregon City.

Read for the first time at a regular meeting of the City Commission held on the 20th day of February 2019, and the City Commission finally enacted the foregoing Ordinance this 6th day of March 2019.

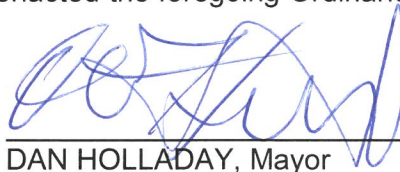

DAN HOLLADAY, Mayor

Attested to this 6th day of March 2019:

Approved as to legal sufficiency:

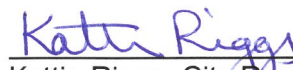

Kattie Riggs, City Recorder



Carrie Rich
City Attorney

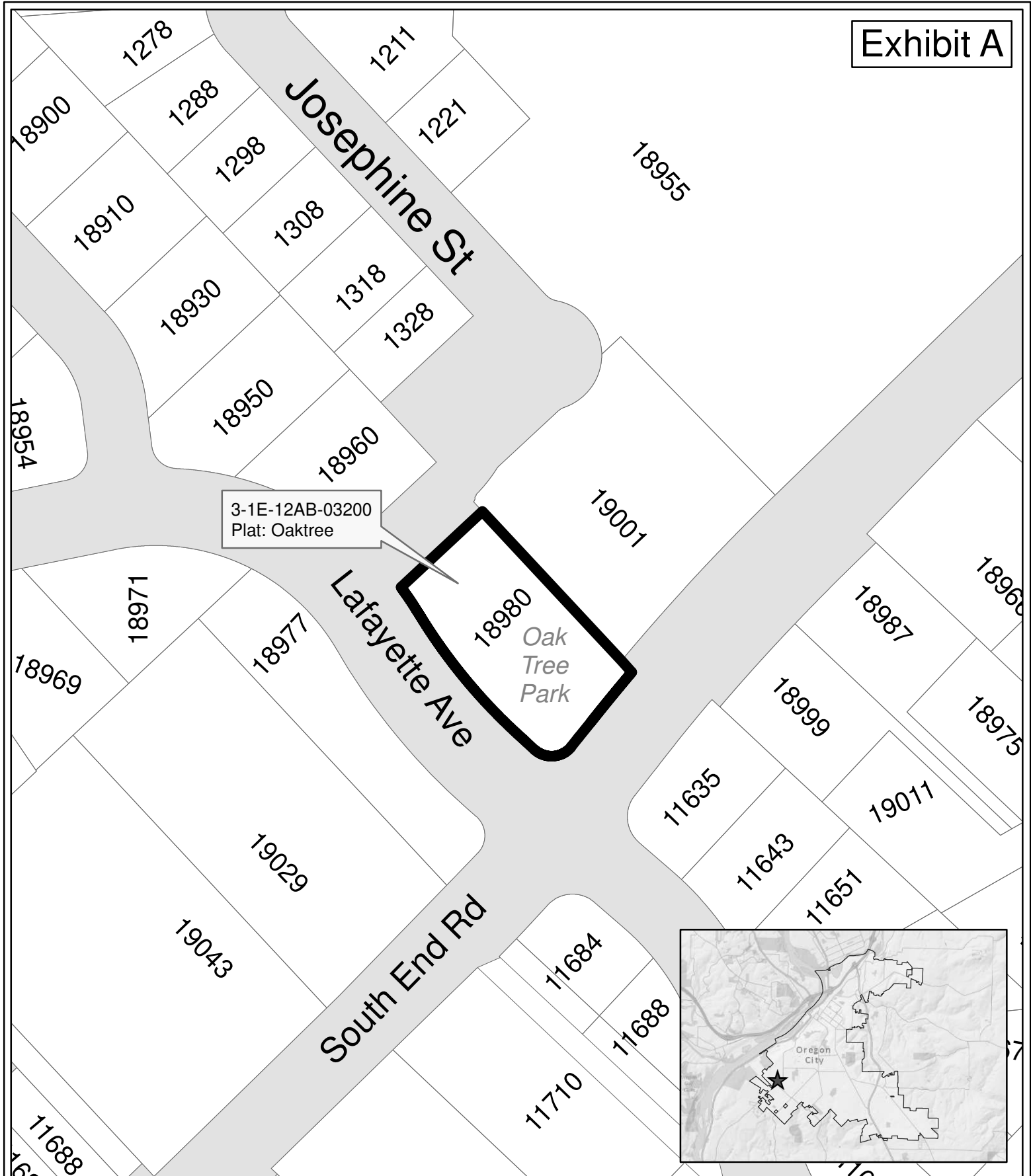

The City of Oregon City makes no representations, express or implied, as to the accuracy, completeness and timeliness of the information displayed. This map is not suitable for legal, engineering, or surveying purposes. Notification of any errors is appreciated.



Oak Tree Park Ordinance 19-1005

0 100 200 Feet

1 inch = 100 feet

City of Oregon City
P.O. Box 3040
625 Center St
Oregon City, OR 97045
503-657-0891 phone
503-657-6629 fax
www.orcity.org

