

ORDINANCE NO. 18-1020

AN ORDINANCE OF THE CITY OF OREGON CITY DESIGNATING THE PROPERTY KNOWN AS HILLENDALE PARK AS A PARK UNDER OREGON CITY CHARTER CHAPTER X

WHEREAS, on December 1, 1975, the parcels identified as Tax Lot 102 of 3-2E-08B (14.79 acres) and Tax Lot 12300 of 3-2E-08BB (1.18 acres) were deeded to the City of Oregon City by a local developer, Smelser Inc. The deed was recorded at Clackamas County as 1975-36302 with the purpose on the deed identified as being for public park and recreation purposes; and

WHEREAS, the 1999 Parks Master Plan identified Hillendale Park as a 15.64 acre developed park and the site location in the Plan included Tax Lot 102 of 3-2E-08B and Tax Lot 12300 of 3-2E-08BB; and

WHEREAS, Tax Lot 14200 of 3-2E-08BA totaling 0.04 acres, was deeded to the City of Oregon City on December 1, 1976 by Smelser Inc. Said deed was recorded at Clackamas County as 1976-44801. This lot was more specifically identified as Tract A on the plat of Hillendale No. 4; and

WHEREAS, Tax Lot 14200 of 3-2E-08BA has not previously been mapped or formally identified as part of Hillendale Park, but this lot is contiguous with the Hillendale Park site, was dedicated to the City of Oregon City by Smelser Inc. as was the rest of Hillendale Park and is maintained by parks maintenance crews. Therefore, it is appropriate to include this tax lot in the park boundary; and

WHEREAS, Hillendale Park is identified by the community and the City of Oregon City as a park property but it has never formally been designated as a park under Chapter X of the Oregon City Charter; and

WHEREAS, designating Hillendale Park as a park under Chapter X of the City Charter would ensure protection of the park by preventing the transfer, sale, vacation or major changes to Hillendale Park without a legal vote of the people; and

WHEREAS, the status of Oregon City's parks as charter parks has been discussed by the Parks & Recreation Advisory Committee (PRAC) and at a regular meeting held on May 24, 2018, PRAC recommended that staff prepare ordinances for adoption by the City Commission recognizing ten parks as charter parks including Hillendale Park.

NOW, THEREFORE, OREGON CITY ORDAINS AS FOLLOWS:

Section 1. Hillendale Park, identified as 3-2E-08B-00102, 3-2E-08BB-12300, and 3-2E-08BA-14200, with the boundaries as shown on the map attached to this Ordinance as Exhibit A, is hereby designated as a park in accordance with the Charter of Oregon City, Chapter X, Section 43, creating a permanent park for the enjoyment of the citizens of Oregon City.

Read for the first time at a regular meeting of the City Commission held on the 5th day of September, 2018, and the City Commission finally enacted the foregoing Ordinance this 19th day of September, 2018.

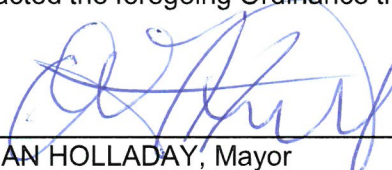

DAN HOLLADAY, Mayor

Attested to this 19th day of September, 2018:



Kattie Riggs, City Recorder

Approved as to legal sufficiency:

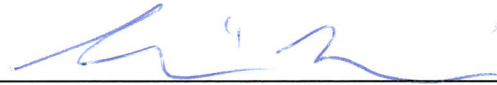

City Attorney

Attachment:
Exhibit A –Map of Park

Exhibit A

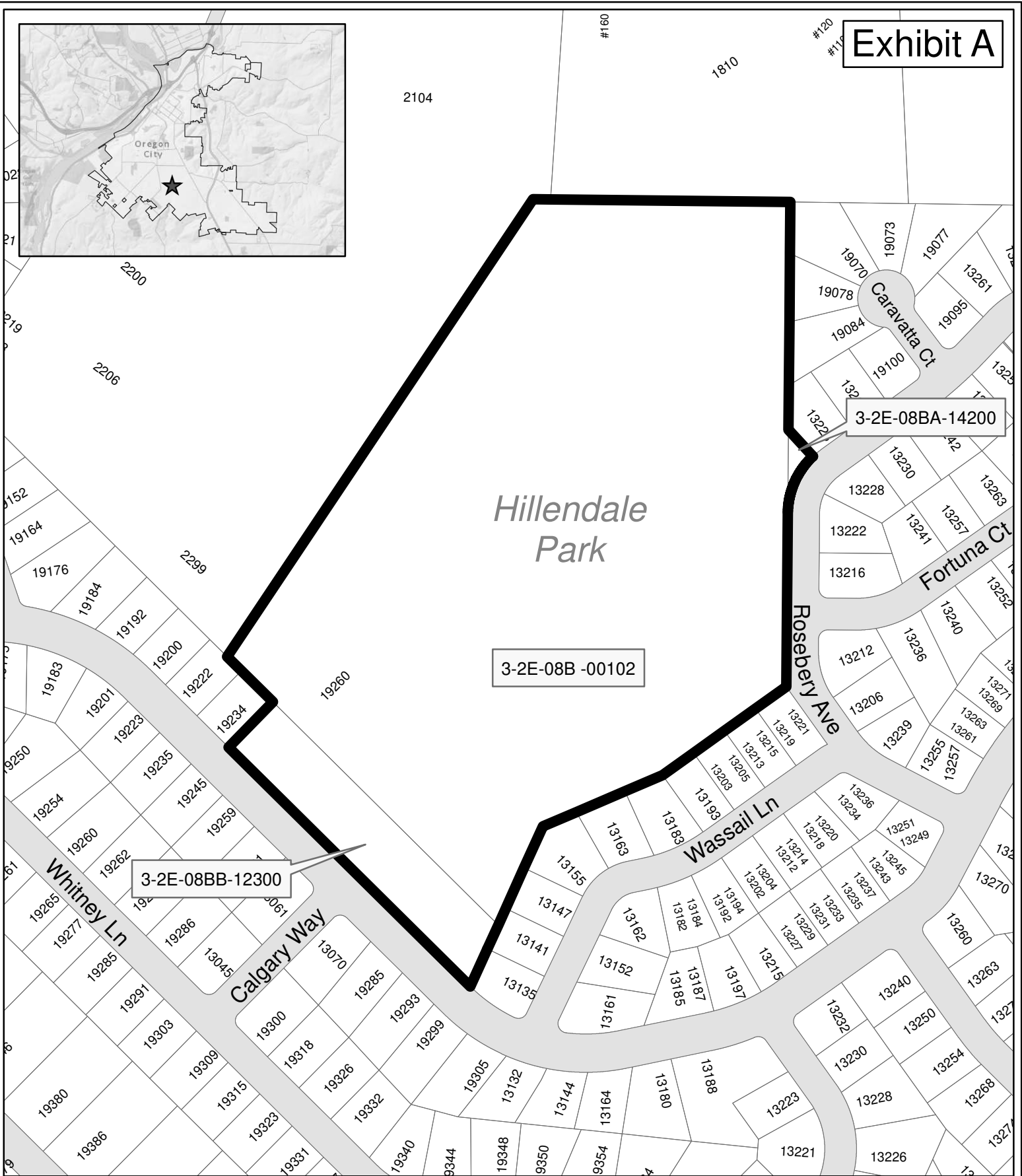
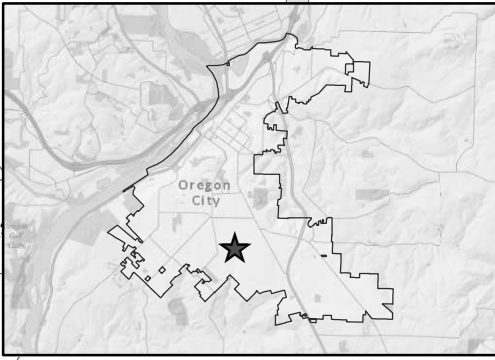

The City of Oregon City makes no representations, express or implied, as to the accuracy, completeness and timeliness of the information displayed. This map is not suitable for legal, engineering, or surveying purposes. Notification of any errors is appreciated.



0 200 400 Feet

1 inch = 200 feet

Hillendale Park Ordinance 18-1020

City of Oregon City
P.O. Box 3040
625 Center St
Oregon City, OR 97045
503-657-0891 phone
503-657-6629 fax
www.orcity.org



Plot date: August 23, 2018
Plot name: Hillendale Park - Ordinance - 8_5x11P - 20180823.pdf
Map name: Hillendale Park - Ordinance - 8_5x11P.mxd