

## ORDINANCE NO. 18-1013

---

### AN ORDINANCE OF THE CITY OF OREGON CITY DESIGNATING THE PROPERTY KNOWN AS PARK PLACE PARK AS A PARK UNDER OREGON CITY CHARTER CHAPTER X

**WHEREAS**, the parcels identified as Tax Lots 1202, 1300 and 1600 as well as the northerly portion of Tax Lot 2000 of Tax Map 2-2E-28BB were transferred from the Park Place Water District to the City of Oregon City for no monetary consideration on January 18, 1994, through the recordation of 1994-004788 at Clackamas County; and

**WHEREAS**, the Park Place Park Master Plan dated September 11, 1995, was adopted as a supporting document to the Comprehensive Plan through the adoption of Ordinance 96-1003 on May 17, 1996; and

**WHEREAS**, the 1999 Parks Master Plan identified Park Place Park as a partially developed 6.5 acre neighborhood park; and

**WHEREAS**, the intent of the master plan was to provide a framework for the City of Oregon City to use in pursuit of funding and to solicit partnerships to help implement future park plans; and

**WHEREAS**, through a deed recorded at Clackamas County as 2002-038584 on April 22, 2002, the southernmost (approximately) 75 feet of Tax Lot 2000 of 2-2E-28BB was acquired from Gary and Diane Cavener for \$63,000; and

**WHEREAS**, the boundaries of Tax Lot 2000 of 2-2E-28BB were modified to combine the northerly portion of Tax Lot 2000 (deed 1994-004788) and the southerly portion of Tax Lot 2000 (deed 2002-038584) into one tax lot which was recorded at Clackamas County as 2002-038585; and

**WHEREAS**, it may be necessary in the future to construct public infrastructure improvements along the Park Place Park frontages of Hiram Avenue, Cleveland Street and Front Avenue, including sidewalks, street lights, planter strips and stormwater management facilities; and

**WHEREAS**, designating Park Place Park as a park under Chapter X of the City Charter would ensure protection of the park by preventing the transfer, sale, vacation or major changes to Park Place Park without a legal vote of the people; and

**WHEREAS**, the status of Oregon City's parks as charter parks has been discussed by the Parks & Recreation Advisory Committee (PRAC) and at a regular meeting held on May 24, 2018, PRAC recommended that staff prepare ordinances for adoption by the City Commission recognizing ten parks as charter parks including Park Place Park.

**NOW, THEREFORE, OREGON CITY ORDAINS AS FOLLOWS:**

**Section 1.** Park Place Park, identified as 2-2E-28BB-1202&1300&1600&2000, with the boundaries as shown on the map attached to this Ordinance as Exhibit A, except those areas identified in Section 2 below, is hereby designated as a park in accordance with the Charter of Oregon City, Chapter X, Section 43, creating a permanent park for the enjoyment of the citizens of Oregon City.

**Section 2.** New public infrastructure along the Park Place Park frontages of Hiram Avenue, Cleveland Street and Front Avenue, including sidewalks, street lights, planter strips and stormwater management facilities shall be permitted to be constructed if it is not detrimental to the usage of the park and if it is deemed to be necessary and in the best interest of the public by the City Manager, City Engineer and the Director of Parks and Recreation.

Read for the first time at a regular meeting of the City Commission held on the 5th day of September, 2018, and the City Commission finally enacted the foregoing Ordinance this 19th day of September, 2018.

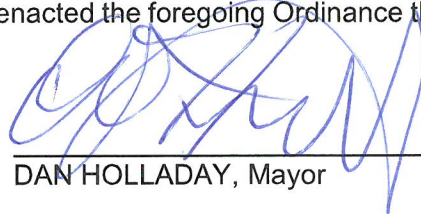
  
\_\_\_\_\_  
DAN HOLLADAY, Mayor

Attested to this 19th day of September, 2018:

Approved as to legal sufficiency:

  
\_\_\_\_\_  
Kattie Riggs, City Recorder  
\_\_\_\_\_  
City Attorney

Attachment:  
Exhibit A – Map of Park

# Exhibit A

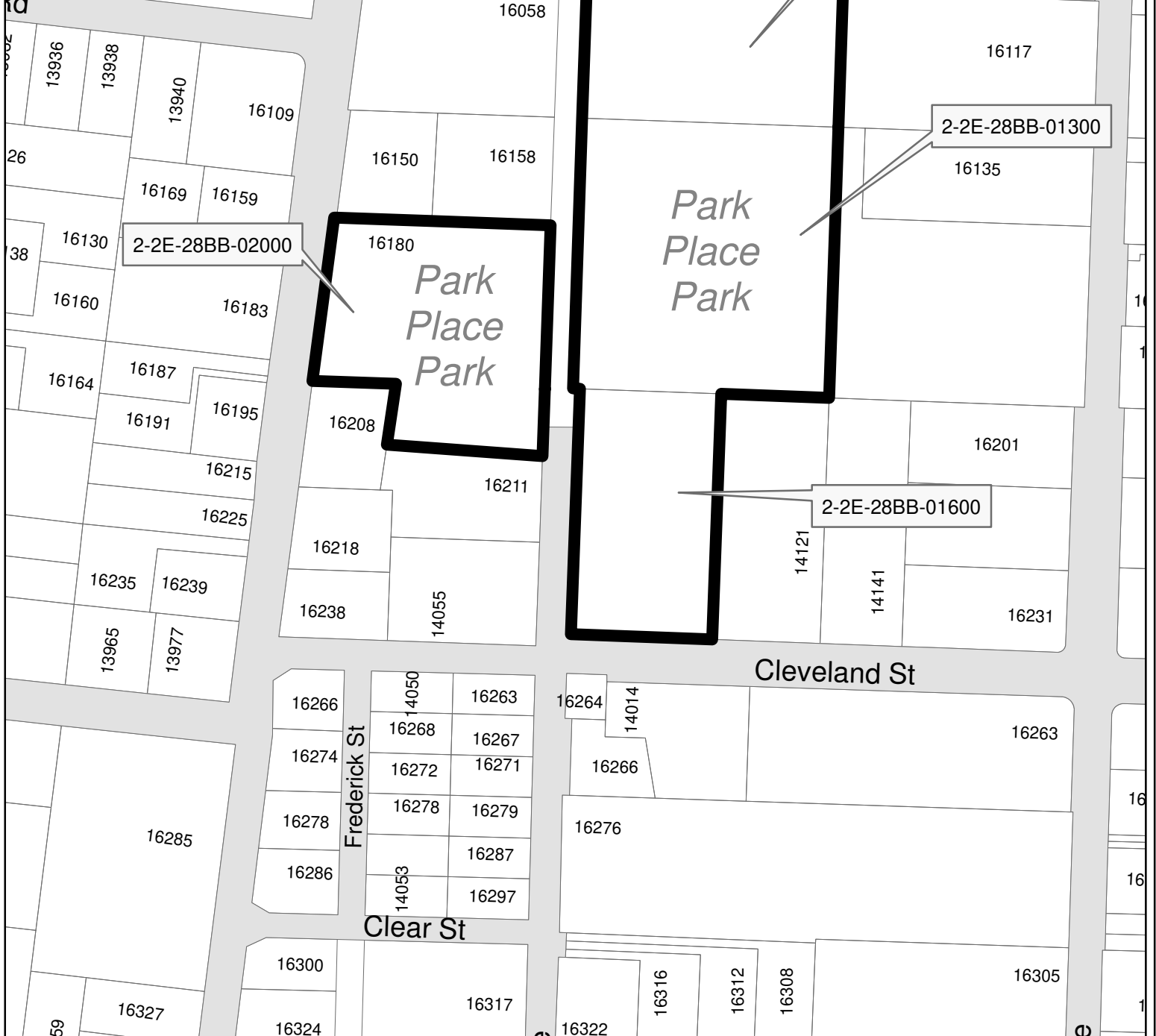
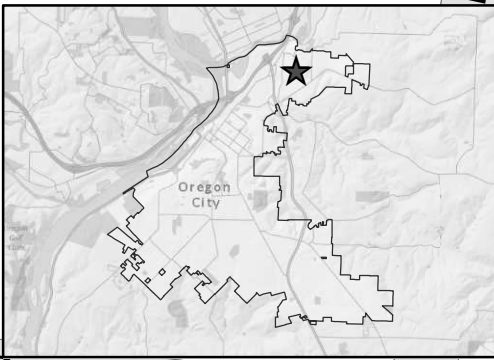

The City of Oregon City makes no representations, express or implied, as to the accuracy, completeness and timeliness of the information displayed. This map is not suitable for legal, engineering, or surveying purposes. Notification of any errors is appreciated.



0 200 400 Feet

## Park Place Park Ordinance 18-1013

1 inch = 175 feet

City of Oregon City  
P.O. Box 3040  
625 Center St  
Oregon City, OR 97045  
503-657-0891 phone  
503-657-6629 fax  
www.orcity.org



Plot date: August 23, 2018  
Plot name: Park Place Park - Ordinance - 8\_5x11P - 20180823.pdf  
Map name: Park Place Park - Ordinance - 8\_5x11P.mxd