

6P
AFTER RECORDING RETURN TO:

was Rogers
City Recorder
City of Oregon
P.O. Box 3040
Oregon City, Oregon 97045-0304



02067356201700479940060061

\$78.00

07/14/2017 08:38:32 AM

D-E Cnt=1 Stn=9 COUNTER1
\$30.00 \$16.00 \$22.00 \$10.00

Map No.: 3-2E-09C
Tax Lot: 800
Planning No.: CP 1403, DP 14.04, NR 14.10
Grantor: Clackamas Community College

**CITY OF OREGON CITY, OREGON
PUBLIC PEDESTRIAN AND BICYCLE EASEMENT**

KNOW ALL BY THESE PRESENTS, THAT CLACKAMAS COMMUNITY COLLEGE herein after called the GRANTOR, do(es) hereby grant unto the City of Oregon City, hereinafter called the CITY, its successors in interest and assigns, a permanent easement and right-of-way, including the permanent right to construct, reconstruct, operate, and maintain A PUBLIC PEDESTRIAN & BICYCLE ACCESS on the following described land:

See attached Exhibit "A" Legal Description and attached Exhibit "B"
Sketch for Legal Description

TO HAVE AND TO HOLD, the above described easement unto the CITY, its successors in interest and assigns forever.

GRANTOR reserves the right to use the surface of the land for walkways, plantings, parking, and related uses. Such uses undertaken by the GRANTOR shall not be inconsistent or interfere with the use of the subject easement area by the CITY. No building or utility shall be placed upon, under, or within the property subject to the foregoing easement during the term thereof, however, without the written permission of the CITY.

Upon completion of the construction, the CITY shall restore the surface of the property to its original condition and shall indemnify and hold the GRANTOR harmless against any and all loss, cost, or damage arising out of the exercise of the rights granted herein.

The true consideration of this conveyance is \$1.00, the receipt of which is hereby acknowledged by GRANTOR.

And the GRANTOR above named hereby covenants to and with the CITY, and CITY's successors in interest and assigns that GRANTOR is lawfully seized in fee simple of the above granted premises, free from all encumbrances (no exceptions)

and that GRANTOR and their heirs and personal representatives shall warrant and forever defend the said premises and every part thereof to the CITY, its successors in interest and assigns against the lawful claims and demands of all persons claiming by, through, or under the GRANTOR.

In construing this deed and where the context so requires, the singular includes the plural and all grammatical changes shall be implied to make the provisions hereof apply equally to corporations and to individuals.

IN WITNESS WHEREOF, the GRANTOR has executed this instrument this 04 day of July, 20 17; if a corporate grantor, it has caused its name to be signed and seal affixed by its officers, duly authorized thereto by order of its board of directors.

NOTICE: No stamp or corporate seal is allowed over any typed information.

Individuals, general partnerships

By: _____

Name, Title (if any)

By: _____

Name, Title (if any)

(affix corporate seal below if executed by a corporation)

Entity
~~Corporation/limited partnership~~

Clackamas Community College
Corporation/Partnership Name (above)

By: [Signature]

ALISSA MATAR, VP
Signer's Name, Title

By: _____

Signer's Name, Title

NOTICE TO NOTARIES: No notary stamp or corporate seal is allowed over any typed information.

Personal Acknowledgment

STATE OF OREGON)

) ss.

County of _____)

Personally appeared the above named _____

and _____

and acknowledged the foregoing instrument to be his (their) voluntary act and deed.

Before me:

NOTARY PUBLIC FOR OREGON

Notary's signature

My Commission Expires: _____

Stamp seal below

(Grantor's Name and Address)

Corporate Acknowledgment

STATE OF OREGON)

) ss.

County of Clackamas)

Personally appeared Akissa Maher

and _____

who being duly sworn, each for himself and not one for the other did say that the former is the Vice president and that the latter is the _____ secretary of Clackamas Community College, a corporation, and that the seal affixed to the foregoing instrument was signed and sealed in behalf of said corporation by authority of its board of directors; and each of them acknowledged said instrument to be its voluntary act and deed.

Before me:

NOTARY PUBLIC FOR OREGON

Steven Robert Cameron
Notary's signature

My Commission Expires: March 6, 2018

Stamp seal below

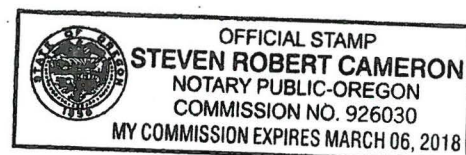

City of Oregon City
P.O. Box 3040
625 Center Street
Oregon City, OR 97045-0304
(Grantee's Name and Address)

Accepted on behalf of the City of Oregon City on
the condition that the easement granted is free and
clear from any taxes, liens, and encumbrances.

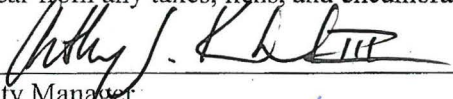

City Manager

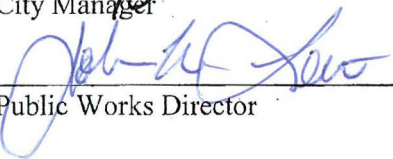

Public Works Director



City Recorder

Pedestrian and Bike Access Easement
Oregon City School District #62
Clackamas County, Oregon
February 15, 2017
Project No. 2489-001 [F]

EXHIBIT "A"

A 25.00 foot strip of land situated in the south one-half of Section 9, Township 3 South, Range 2 East, of the Willamette Meridian, Clackamas County, Oregon, being a portion of that property conveyed to Clackamas County Area Education District by Deed Document Number 83-02823, Clackamas County Deed Records, being more particularly described as follows:

Beginning on the east line of said property conveyed to Clackamas County Area Education District, at a point which bears North $00^{\circ}26'30''$ West, 144.32 feet from a found Stone with an "X" marking the southeast corner thereof;

thence, South $89^{\circ}21'23''$ West, 134.39 feet;

thence, North $47^{\circ}41'00''$ West, 22.31 feet;

thence, North $42^{\circ}19'00''$ East, 25.00 feet;

thence, South $47^{\circ}41'00''$ East, 12.48 feet;

thence, North $89^{\circ}21'23''$ East, 124.74 feet to said east line of Clackamas County Area Education District property;

thence, along said east line, South $00^{\circ}26'30''$ East, 25.00 feet to the Point of Beginning.

Containing 3,675 square feet.

Bearings are based on the centerline of Glen Oak Road between found monuments at the south one-quarter corner of Section 9 and the southeast corner of Section 9 per Survey Number 2008-277, Clackamas County Survey Records.

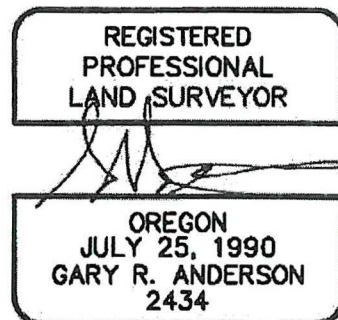

RENEWS: 12/31/17

45



0 50' 100'

SCALE: 1"=100'

CLACKAMAS COUNTY AREA
EDUCATION DISTRICT
DOC. NO. 83-2823

S. DOUGLAS LOOP
(PRIVATE ROAD)

PEDESTRIAN AND BIKE
ACCESS EASEMENT
AREA: 3,675 SQ. FT.

HENRY & JANICE NUTT
DOC. NO. 71-7453

N42°19'00"E 25.00
N47°41'00"W 22.31
S89°21'23"W 134.49
S47°41'00"E 12.48
N89°21'23"E 124.74
S00°26'30"E 25.00
N00°26'30"W 144.32

EXISTING PEDESTRIAN AND BIKE ACCESS EASEMENT

OREGON CITY SCHOOL DISTRICT #62
DOC. NO. 91-52218

STONE WITH "X"

OREGON CITY SCHOOL DISTRICT #62
DOC. NO. 2012-080636

LODER
ROAD

54.00'

EXHIBIT B PAGE 1 OF 1

LOCATED IN THE S. 1/2 OF SECTION 9
TOWNSHIP 3 S., RANGE 2 E., W.M.
CLACKAMAS COUNTY, OREGON

DATE	15FEB17
DRAWN BY	SLH2
CHECKED BY	GRA
REVISION	0
JOB NO.	2489-001



WESTLAKE
CONSULTANTS INC.

ENGINEERING • SURVEYING • PLANNING

PACIFIC CORPORATE CENTER
15115 S.W. SEQUOIA PARKWAY, SUITE 150 (503) 684-0652
TIGARD, OREGON 97224 FAX (503) 624-0157

Drawing Name: J:\2489-001\14\Survey\CAD\DWG\2489-001E.dwg Feb 15, 2017 - 8:50am - gao

(6) 7