

25 After Recording Return to:

Oregon City Recorder

~~325 Warner Mine Road~~ POB 4351

Oregon City, OR 97045

Willamette Falls Hospital

Waterline Easement

T.L. 2100, 2-2E-32AB

CITY OF OREGON CITY, OREGON

PUBLIC UTILITY(S) EASEMENT

KNOW ALL MEN BY THESE PRESENTS, THAT Doctors Hospital Association, Inc., hereinafter called the GRANTOR, do(es) hereby grant unto the City of Oregon City, hereinafter called the CITY, its successors in interest and assigns, a permanent easement and right-of-way, including the permanent right to construct, reconstruct, operate and maintain a waterline on the following described land:

See attached Exhibit "A" Legal Description and attached Exhibit "B" Sketch for Legal Description

TO HAVE AND TO HOLD, the above described easement unto the CITY, its successors in interest and assigns forever.

GRANTOR reserves the right to use the surface of the land for walkways, plantings, parking and related uses. Such uses undertaken by the GRANTOR shall not be inconsistent or interfere with the use of the subject easement area by the CITY. No building or utility shall be placed upon, under or within the property subject to the foregoing easement during the term thereof, however, without the written permission of the CITY.

Upon completion of the construction, the CITY shall restore the surface of the property to its original condition and shall indemnify and hold the GRANTOR harmless against any and all loss, cost or damage arising out of the exercise of the rights granted herein.

The true consideration of this conveyance is one dollar, the receipt of which is hereby acknowledged by GRANTOR.

And the GRANTOR above named hereby covenants to and with the CITY, and CITY's successors in interest and assigns that GRANTOR is lawfully seized in fee simple of the above granted premises, free from all encumbrances

and that GRANTOR and their heirs and personal representatives shall warrant and forever defend the said premises and every part thereof to the CITY, its successors in interest and assigns against the lawful claims and demands of all persons claiming by, through, or under the GRANTOR.

In construing this deed and where the context so requires, the singular includes the plural and all grammatical changes shall be implied to make the provisions hereof apply equally to corporations and to individuals.

IN WITNESS WHEREOF, the GRANTOR has executed this instrument this 9  
day of December, 1992; if a corporate grantor, it has caused its name to be  
signed and seal affixed by its officers, duly authorized thereto by order of  
its board of directors.

Individuals,  
General Partnerships

Corporation  
Limited Partnership

\_\_\_\_\_  
Signer's Name

Doctors Hospital Association, Inc.

Robert A. Steed

\_\_\_\_\_  
Signer's Name

(If executed by a corporation  
affix corporate seal)

Robert A. Steed, Administrator/CEO  
Signer's Name, Title

\_\_\_\_\_  
Signer's Name, Title

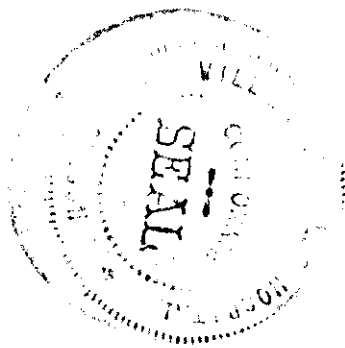

Personal Acknowledgement  
STATE OF OREGON )  
County of \_\_\_\_\_ ) .ss

Personally appeared the above  
named \_\_\_\_\_ and  
acknowledged the foregoing  
instrument to be \_\_\_\_\_  
voluntary act and deed.

Before me:

\_\_\_\_\_  
NOTARY PUBLIC FOR OREGON

My Commission Expires: \_\_\_\_\_

(OFFICIAL SEAL)

Doctors Hospital Association Inc.  
c/o Willamette Falls Community Hospital  
1500 Division Street  
Oregon City, Oregon 97045  
(Grantor's Name & Address)

City of Oregon City  
320 Warner-Milne Road  
Oregon City, Oregon 97045  
(Grantee's Name & Address)

Accepted on behalf of the City of  
Oregon City on the condition that  
the easement granted is free and  
clear from taxes, liens and  
encumbrances.

Daniel W. Fowler

Mayor

Alan K. Elliott

City Recorder

After Recording Return to:  
City Engineer  
City of Oregon City  
320 Warner-Milne Road  
Oregon City, Oregon 97045

Corporate Acknowledgement  
STATE OF OREGON )  
Clackamas County ) .ss

Personally appeared Robert A. Steed  
and \_\_\_\_\_  
who being duly sworn, acknowledged the  
himself and not one for the other  
did say that the former is the Adminis-  
trator ~~president~~ and that the latter  
is the CEO ~~secretary~~ of  
Doctors Hospital Association, Inc. a  
corporation, and that the seal affixed to the  
foregoing instrument was signed and  
sealed in behalf of said corporation  
by authority of its board of  
directors; and each of them  
acknowledged said instrument to be  
its voluntary act and deed.

Before me: Ann Allanach

Ann Allanach

NOTARY PUBLIC FOR OREGON

My Commission Expires: 7/29/95

(OFFICIAL SEAL)

Space Reserved for  
County Record's Office

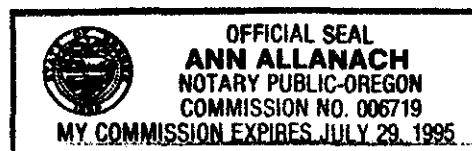

EXHIBIT "A"

A portion of that real property in the NE 1/4 of Section 32, T 2 S, R 2 E, W.M., City of Oregon City, Clackamas County, Oregon, conveyed to Doctors Hospital Association, Inc. as described and recorded December 27, 1957 in Book 534, page 590, deed records of said Clackamas County, more particularly described as follows:

All of said Doctors Hospital Association, Inc. real property lying within a strip of land 15.0 feet wide, 7.5 feet either side of the following described centerline.

Beginning at a point which is N 1°00'00" E 7.30 feet from the northwesterly corner of said Doctors Hospital Association, Inc. real property; thence S 87°15'00" E parallel with the northerly line of said Doctors Hospital Association, Inc. real property 774.46 feet; thence S 1°49'33" W 143.92 feet; thence S 39°33'18" W 81.63 feet; thence S 1°27'50" W 140.53 feet; thence S 52°49'29" W 38.32 feet; thence N 37°10'31" W 24.00 feet; thence S 37°10'31" E 24.00 feet; thence S 52°49'29" W 57.29 feet to a point on the line which is parallel with and 4.00 feet southerly from, when measured at right angles, the southerly line of said Doctors Hospital Association, Inc. real property; thence N 87°15'00" W along said parallel line 645.14 feet, more or less, to a point on the easterly right-of-way line of Division Street and the terminus of said centerline.

This description is based upon a survey dated March 26, 1990 and filed with the Clackamas County Surveyor as P.S. #23670.

2 2E 32AA  
T L 400

WATERLINE  
EASEMENT

CENTERLINE  
EASEMENT

2 2E 32AC  
T L 101

S 1°49'33" W 143.92'  
S 39°33'18" W 81.63'  
S 1°27'50" W 140.53'  
7.5'  
7.5'  
S 52°49'29" W 38.32'  
N 37°10'31" W 24.00'  
S 52°49'29" W 57.29'

2 2E 32AB  
T L 2000

2 2E 32AC  
T L 103

S 87°15'00" E 774.46'

DOCTORS HOSPITAL  
ASSOCIATION, INC.  
BOOK 534, PAGE 590  
2 2E 32AB TAX LOT 2100

S 87°15'00" E 645.14' M/L

EXISTING EASEMENT  
INGRESS, EGRESS,  
AND UTILITIES  
FEE NO. 74-13168

7.5' CENTERLINE EASEMENT  
TO EDGE OF EASEMENT

7.3' CENTERLINE  
EASEMENT TO  
PROPERTY LINE

4.00'

2 2E 32AB  
T L 1900

2 2E 32AC  
T L 200

NW CORNER  
534/590

SW CORNER  
543/590

P.O.B.  
CENTERLINE

N 1°00'00" E

DIVISION STREET

TERMINUS CENTERLINE

15 TH  
ST.

14 TH  
ST.

PREPARED BY:  
LEE ENGINEERING, INC.  
1300 JOHN ADAMS ST.  
OREGON CITY, OR 97045  
(503) 655-1342

1" = 100'  
1107E03

JUNE 6, 1990



# CITY OF OREGON CITY

INCORPORATED 1844

## COMMISSION REPORT

TO THE HONORABLE MAYOR AND COMMISSIONERS

FOR AGENDA

DATED

June 15, 1994

Page 1 of 1

Subject: Public Utility Easement  
Water Line Installation -  
Around Willamette Falls Hospital

Report No. 94-112

On the June 15, 1994 City Commission agenda is an easement covering a public water line installation around Willamette Falls Community Hospital that was completed in 1992. This easement surfaced in files that described the particular project. A vicinity map is attached for Commission review.

It is recommended that the City Commission accept the easement, authorize the Mayor and City Recorder to execute the document and record in Clackamas County Records.

CHARLES LEESON  
City Manager

attach.

- cc
- Max Talbot, Director, Community Development
  - Rick McClung, Public Works Director
  - Henry Mackenroth, City Engineer

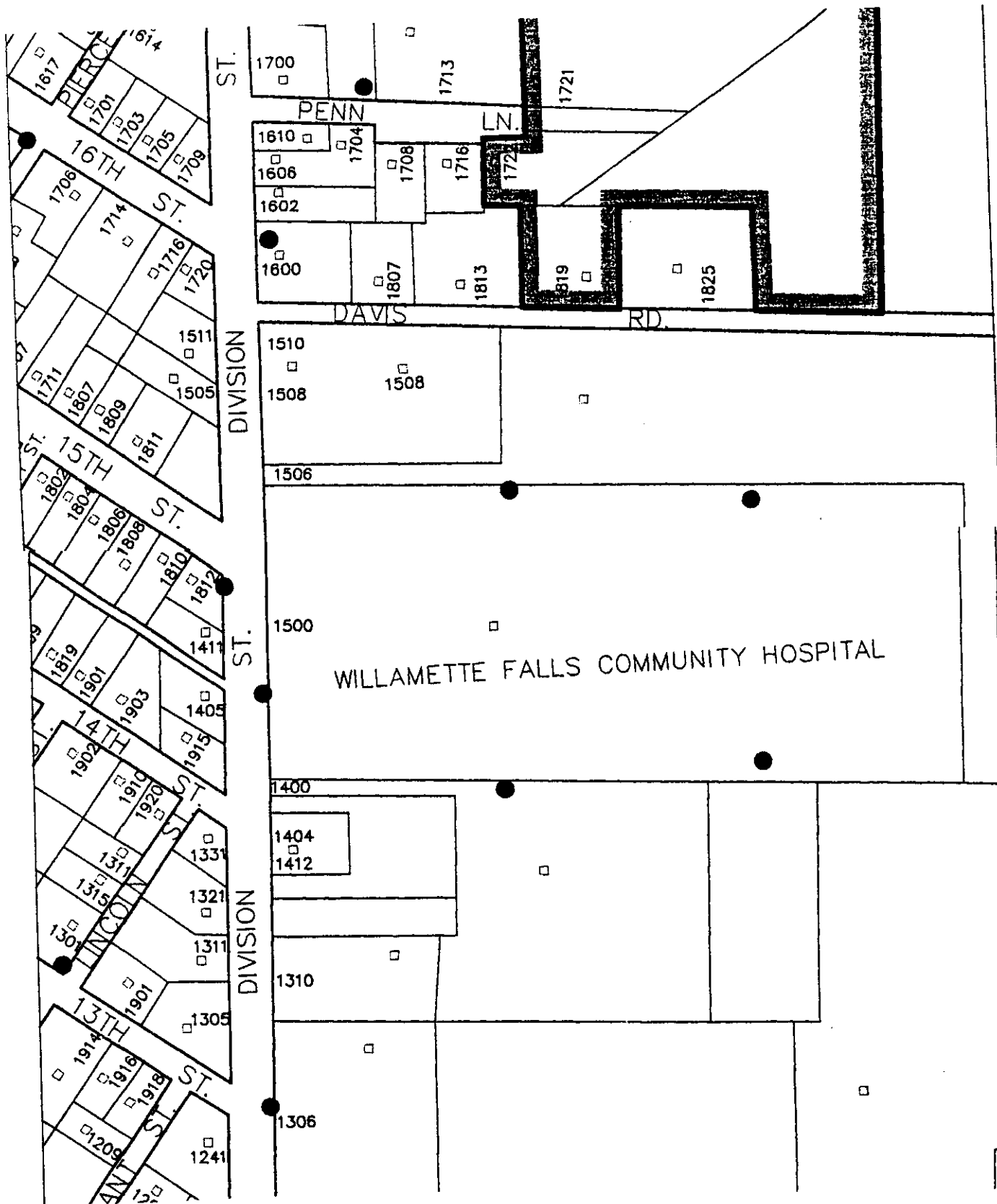

Vicinity Map



# CITY OF OREGON CITY

INCORPORATED 1844

## COMMISSION REPORT

TO THE HONORABLE MAYOR AND COMMISSIONERS

FOR AGENDA

DATED

June 15, 1994

Page 1 of 1

Subject: Public Utility Easement  
Water Line Installation -  
Around Willamette Falls Hospital

Report No. 94-112

On the June 15, 1994 City Commission agenda is an easement covering a public water line installation around Willamette Falls Community Hospital that was completed in 1992. This easement surfaced in files that described the particular project. A vicinity map is attached for Commission review.

It is recommended that the City Commission accept the easement, authorize the Mayor and City Recorder to execute the document and record in Clackamas County Records.

CHARLES LEESON  
City Manager

attach.

- cc
- Max Talbot, Director, Community Development
  - Rick McClung, Public Works Director
  - Henry Mackenroth, City Engineer



Public  
Utility Easement

December 1992

2-2E-32AB  
T.L. 2100

DOCTORS HOSPITAL  
ASSOCIATION

DOC# 94-068148

pg	item
814	8

EW#  
819