

SEWER EASEMENT  
TRI-CITY SERVICE DISTRICT

KNOW ALL MEN BY THESE PRESENTS, That The City of Oregon City hereinafter referred to as the Grantor, for the consideration hereinafter stated, and the mutual benefit hereby gained, which consideration and benefit are hereby acknowledged and receipted by the Grantor, do hereby grant, bargain, sell and convey unto Tri-City Service District, a permanent easement and right to lay down, construct, reconstruct, replace, operate, inspect and perpetually maintain a sewer and all related facilities through, under and along the following described property in the County of Clackamas and State of Oregon:

See Exhibit "A", "C", "D" also Exhibit "B" which is a 50 foot wide temporary easement overlaying easement "A".

Also an additional Temporary Construction easement of 20 feet wide on the north and south sides of easement "C" and easement "D".

These Temporary easements shall cease after construction of said sewer, or November, 1985, whichever occurs first.

It is understood and agreed that no building shall be erected upon said easement premises without the written consent of Tri-City Service District and that the said District shall replace, as near as practicable, the surface of said easement premises after construction and maintenance work on said sewer.

This instrument does not grant or convey unto Tri-City Service District, any right or title to the surface of the soil along the route of said sewer except for the purpose of laying down, constructing, reconstructing, replacing, operating, inspecting and maintaining the same. This instrument gives immediate possession of the foregoing premises.

The true and actual consideration for this transfer is: \$ -0-  
paid herewith; \$ \_\_\_\_\_ to be paid prior to construction; Gift \_\_\_\_\_

The only other persons, firms or corporation known by Grantor to have any interest in the foregoing premises are:

IN WITNESS WHEREOF, the grantor            above named, has hereunto set his  
hand and seal this 4th day of September, 19 85 .

Don Anderson  
Don Anderson Mayor

Noel Klein, City Manager

STATE OF OREGON, County of Clackamas) ss. September 4, 1985

Personally appeared the above named Don Andersen and

Noel J. Klein

and acknowledged the foregoing instrument to be their voluntary act and deed.

Before me:

Notary Public for Oregon  
 My Commission Expires: 3-09-88



## PROPERTY MANAGEMENT DEPARTMENT CLACKAMAS COUNTY

CAROLE J. BERGGREN  
Director

PHONE (503) 655-8357

WILBUR SCHICK  
Chief of Right-of-Way

July 26, 1985

City of Oregon City  
320 Warner Milne Road  
Oregon City, OR 97045

Attn: Noel Klein, City Manager  
Subject: Revised Legal Description for Sewer Easement at Oregon City STP.  
(Willamette Interceptor)

Dear Mr. Klein:

On July 5th, 1984, the City of Oregon City executed an easement for the benefit of the Tri-City Service District. This easement permitted construction of a sewer line along the Oregon City STP property on Clackanet Drive.

Changes due to design consideration have been made in the alignment of the sewer requiring that it be moved further onto the STP property a short distance.

The easement will still fall within the 10 foot set back area along the property frontage. We request that you re-execute this corrected document which would then be recorded to supercede the prior document.

Mr. David Feinauer is representing the District in this matter.

Thank you for your cooperation in this matter.

Sincerely,

*Wilbur Schick CB*

Wilbur Schick  
Chief of Right-of-Way

WS:DF:lem

7223B:10:1



# CITY OF OREGON CITY

Incorporated 1844

CITY MANAGER'S OFFICE  
320 Warner-Milne Road  
Oregon City, OR 97045  
503-657-0891

September 9, 1985

Wilbur Schick  
Chief of Right-of-Way  
Property Management Department  
County of Clackamas  
121 Library Court  
Oregon City OR 97045

Dear Wilbur:

This letter is in response to your letter dated July 26, 1985 regarding a revised legal description for sewer easement at Oregon City Sewage Treatment Plant.

At its September 4, 1985 meeting, the City Commission approved the revised sewer easement. Enclosed is the original as signed by Mayor Don Andersen and City Manager Noel J. Klein. Please proceed to have the easement recorded.

Very truly yours,

JEAN K. McNULTY  
City Recorder

jkm

Enclosure

cc: Rosalind A. Daniels, Director of Public Works

Permanent Easement Oregon City STP  
Map 2-2E-30

(Interceptor 1A)

REVISED JULY 17, 1985

A parcel of land in the NE 1/4 of Section 30, T.2S., R.2E., W. M., Clackamas County, Oregon, to wit:

A strip of land, 10 feet wide, the centerline of which is described as follows:

Commencing at the true point of beginning of that parcel described in Document Number 70-22199, recorded October 1, 1970, in the Deed Records of said County; thence S.81°19'59"E. along the north line extended easterly of said parcel, 32.13 feet to the said centerline and True Point of Beginning of the strip herein described, which point is herein defined as station "O" 5+74.23; thence S.11°06'34"W., 142.56 feet to station "O" 7+16.79; thence southwesterly along the arc of a 1,485 foot radius curve (the radius point of which bears N.58°02'02"W.) through a central angle of 23°43'57", 615.10 feet (chord bears S.43°49'57"W., 610.71 feet) to station "O" 13+31.89; thence nontangentially, S.38°58'33"W., 551.35 feet to station "O" 18+83.24; thence S.29°00'09"W., 397.25 feet to station "O" 22+80.49 and point of curve right of a 3,987 foot radius curve; thence along the arc of said curve right through a central angle of 08°55'36", 621.18 feet (chord bears S.33°27'57"W., 620.54 feet) to station "O" 29+01.67; thence nontangentially, S.37°55'38"W., 157.58 feet to station "O" 30+59.25; thence S.00°54'37" E., 23.92 feet to station "I" 31+31.86; thence N.67°46'28"W., 118.14 feet to station "I" 32+50.00 and point of curve right of a 1,250 foot radius curve; thence along the arc of said curve right through a central angle of 16°22'38", 357.30 feet (chord bears N.59°35'09"W., 356.08 feet) to station "I" 36+07.30; thence N.51°23'50"W., 408.79 feet to station "I" 40+16.09 and point of curve left of a 572.98 foot radius curve; thence along the arc of said curve left through a central angle of 41°09'02", 411.51 feet (chord bears N.71°58'21"W., 402.73 feet) to station "I" 44+27.60; thence S.87°27'08"W., 197.50 feet to station "I" 46+25.10 and point of curve right of a 377.00 foot radius curve; thence along the arc of said curve right through a central angle of 15°06'24", 99.40 feet (chord bears N.84°59'40"W., 99.11 feet) to station "I" 47+24.50; thence N.77°26'28"W., 3.59 feet to station "I" 47+28.09 and point of curve left of a 377.03 foot radius curve; thence along the arc of said curve left through a central angle of 15°06'15", 99.39 feet (chord bears N.84°59'36"W., 99.10 feet) to station "I" 48+27.51; thence S.87°27'17"W., 420.00 feet to station "I" 52+47.51 and the True Point of Beginning of the strip herein described; thence S.02°07'02"E., 642.20 feet; thence N.85°24'50"E., 187.59 feet, to the terminus of this strip.

EXCEPTING therefrom all portions lying in public rights-of-way.

Bearings and distances are based upon the Oregon State Coordinate System - North Zone (horizontal scale factor = .9999006).

Temporary Easement in the Oregon City STP  
Map 2-2E-30

(Interceptor 1A)

REVISED JULY 17, 1985

A parcel of land in the NE 1/4 of Section 30, T.2S., R.2E., W.M., Clackamas County, Oregon, to wit:

A strip of land, 50 feet wide, the centerline of which is described as follows:

Commencing at the true point of beginning of that parcel described in Document Number 70-22199, recorded October 1, 1970, in the Deed Records of said County; thence S.81°19'59"E. along the north line extended easterly of said parcel, 32.13 feet to the said centerline and True Point of Beginning of the strip herein described, which point is herein defined as station "O" 5+74.23; thence S.11°06'34"W., 142.56 feet to station "O" 7+16.79; thence southwesterly along the arc of a 1,485 foot radius curve (the radius point of which bears N.58°02'02"W.) through a central angle of 23°43'57", 615.10 feet (chord bears S.43°49'57"W., 610.71 feet) to station "O" 13+31.89; thence nontangentially, S.38°58'33"W., 551.35 feet to station "O" 18+83.24; thence S.29°00'09"W., 397.25 feet to station "O" 22+80.49 and point of curve right of a 3,987 foot radius curve; thence along the arc of said curve right through a central angle of 08°55'36", 621.18 feet (chord bears S.33°27'57"W., 620.54 feet) to station "O" 29+01.67; thence nontangentially, S.37°55'38"W., 157.58 feet to station "O" 30+59.25; thence S.00°54'37" E., 23.92 feet to station "I" 31+31.86; thence N.67°46'28"W., 118.14 feet to station "I" 32+50.00 and point of curve right of a 1,250 foot radius curve; thence along the arc of said curve right through a central angle of 16°22'38", 357.30 feet (chord bears N.59°35'09"W., 356.08 feet) to station "I" 36+07.30; thence N.51°23'50"W., 408.79 feet to station "I" 40+16.09 and point of curve left of a 572.98 foot radius curve; thence along the arc of said curve left through a central angle of 41°09'02", 411.51 feet (chord bears N.71°58'21"W., 402.73 feet) to station "I" 44+27.60; thence S.87°27'08"W., 197.50 feet to station "I" 46+25.10 and point of curve right of a 377.00 foot radius curve; thence along the arc of said curve right through a central angle of 15°06'24", 99.40 feet (chord bears N.84°59'40"W., 99.11 feet) to station "I" 47+24.50; thence N.77°26'28"W., 3.59 feet to station "I" 47+28.09 and point of curve left of a 377.03 foot radius curve; thence along the arc of said curve left through a central angle of 15°06'15", 99.39 feet (chord bears N.84°59'36"W., 99.10 feet) to station "I" 48+27.51; thence S.87°27'17"W., 420.00 feet to station "I" 52+47.51 and the True Point of Beginning of the strip herein described; thence S.02°07'02"E., 642.20 feet; thence N.85°24'50"E., 202.59 feet to the terminus of this strip.

EXCEPTING therefrom all portions lying in public rights-of-way.

Bearings and distances are based upon the Oregon State Coordinate System - North Zone (horizontal scale factor = .9999006).

EXHIBIT 'c'

Permanent Easement in Tax Lot 600 (Clackamette Park)  
Map 2-2E-30

(Outfall from Main Street Extension to Willamette River)

A parcel of land in the NE 1/4 of Section 30, T.2S., R.2E., W.M.,  
Clackamas County, Oregon, to wit:

That portion of that parcel recorded in Book 366, Page 412, Clackamas  
County Records lying northwesterly of Main Street Extension as recorded  
in Fee Number 76-14088; described below:

A strip of land, of varying widths, the centerline of which is described as  
follows:

Commencing at the true point of beginning of that parcel described in  
Document Number 70-22199, recorded October 1, 1970, in the Deed Records of  
said County; thence S.81°19'59"E. along the north line extended easterly  
of said parcel, 32.13 feet to the said centerline and True Point of  
Beginning of the strip herein described, which point is herein defined as  
station "O" 5+74.23; thence S.11°06'34"W., 142.56 feet to station "O"  
7+16.79; thence southwesterly along the arc of a 1,485 foot radius curve  
(the radius point of which bears N.58°02'02"W.) through a central angle of  
23°43'57", 615.10 feet (chord bears S.43°49'57"W., 610.71 feet) to station  
"O" 13+31.89; thence nontangentially, S.38°58'33"W., 551.35 feet to  
station "O" 18+83.24; thence S.29°00'09"W., 397.25 feet to station "O"  
22+80.49 and point of curve right of a 3,987 foot radius curve; thence  
along the arc of said curve right through a central angle of 08°55'36",  
621.18 feet (chord bears S.33°27'57"W., 620.54 feet) to station "O"  
29+01.67; thence nontangentially, S.37°55'38"W., 157.58 feet to station  
"O" 30+59.25; thence S.00°54'37" E., 23.92 feet to station "I" 31+31.86;  
thence N.67°46'28"W., 118.14 feet to station "I" 32+50.00 and point of  
curve right of a 1,250 foot radius curve; thence along the arc of said  
curve right through a central angle of 16°22'38", 357.30 feet (chord bears  
N.59°35'09"W., 356.08 feet) to station "I" 36+07.30; thence N.51°23'50"W.,  
408.79 feet to station "I" 40+16.09 and point of curve left of a 572.98  
foot radius curve; thence along the arc of said curve left through a  
central angle of 41°09'02", 411.51 feet (chord bears N.71°58'21"W., 402.73  
feet) to station "I" 44+27.60; thence S.87°27'08"W., 197.50 feet to  
station "I" 46+25.10 and point of curve right of a 377.00 foot radius curve;  
thence along the arc of said curve right through a central angle of  
15°06'24", 99.40 feet (chord bears N.84°59'40"W., 99.11 feet) to station  
"I" 47+24.50; thence N.77°26'28"W., 3.59 feet to station "I" 47+28.09 and  
point of curve left of a 377.03 foot radius curve; thence along the arc of  
said curve left through a central angle of 15°06'15", 99.39 feet (chord  
bears N.84°59'36"W., 99.10 feet) to station "I" 48+27.51; thence  
S.87°27'17"W., 271.88 feet to station "I" 50+99.39; thence N.02°32'43"W.,

23.00 feet to station "O" 50+23.14; thence northwesterly along the arc of a 600 foot radius curve (the radius point of which bears N.02°32'41"W.) through a central angle of 16°42'40", 175.00 feet (chord bears N.84°11'23"W., 174.38 feet) to station "O" 51+98.14; thence N.75°50'03"W., 2.76 feet, to station "O" 52+00.90 and point of curve left of a 600 foot radius curve; thence along the arc of said curve left through a central angle of 24°07'57", 252.72 feet (chord bears N.87°54'02"W., 250.85 feet) to station "O" 54+53.62; thence S.80°02'00"W., 229.79 feet to station "O" 56+83.41; thence N.77°32'50"W. to the Ordinary Low Water line of the Willamette River.

<u>Station</u>	<u>to</u>	<u>Station</u>	<u>Easement Width</u>
"O" 50+23.14		"O" 56+83.41	24
"O" 56+83.41		Ordinary Low Water line of Willamette River	30

EXCEPTING those portions within public rights-of-way.

Bearings and distances are based upon the Oregon State Coordinate System - North Zone (horizontal scale factor = .9999006).

EXHIBIT "D"

Permanent Easement in Tax Lot 600 (Clackamette Park)  
Map 2-2E-30

(Interceptor 1A from Main Street Extension to Willamette River)

A parcel of land in the NE 1/4 of Section 30, T.2S., R.2E., W.M.,  
Clackamas County, Oregon, to wit:

That portion of that parcel recorded in Book 366, Page 412, Clackamas  
County Records lying northwesterly of Main Street Extension as recorded  
in Fee Number 76-14088; described below:

A strip of land, 10 feet wide, the centerline of which is described as  
follows:

Commencing at the true point of beginning of that parcel described in  
Document Number 70-22199, recorded October 1, 1970, in the Deed Records of  
said County; thence S.81°19'59"E. along the north line extended easterly  
of said parcel, 32.13 feet to the said centerline and True Point of  
Beginning of the strip herein described, which point is herein defined as  
station "O" 5+74.23; thence S.11°06'34"W., 142.56 feet to station "O"  
7+16.79; thence southwesterly along the arc of a 1,485 foot radius curve  
(the radius point of which bears N.58°02'02"W.) through a central angle of  
23°43'57", 615.10 feet (chord bears S.43°49'57"W., 610.71 feet) to station  
"O" 13+31.89; thence nontangentially, S.38°58'33"W., 551.35 feet to  
station "O" 18+83.24; thence S.29°00'09"W., 397.25 feet to station "O"  
22+80.49 and point of curve right of a 3,987 foot radius curve; thence  
along the arc of said curve right through a central angle of 08°55'36",  
621.18 feet (chord bears S.33°27'57"W., 620.54 feet) to station "O"  
29+01.67; thence nontangentially, S.37°55'38"W., 157.58 feet to station  
"O" 30+59.25; thence S.00°54'37" E., 23.92 feet to station "I" 31+31.86;  
thence N.67°46'28"W., 118.14 feet to station "I" 32+50.00 and point of  
curve right of a 1,250 foot radius curve; thence along the arc of said  
curve right through a central angle of 16°22'38", 357.30 feet (chord bears  
N.59°35'09"W., 356.08 feet) to station "I" 36+07.30; thence N.51°23'50"W.,  
408.79 feet to station "I" 40+16.09 and point of curve left of a 572.98  
foot radius curve; thence along the arc of said curve left through a  
central angle of 41°09'02", 411.51 feet (chord bears N.71°58'21"W., 402.73  
feet) to station "I" 44+27.60; thence S.87°27'08"W., 197.50 feet to  
station "I" 46+25.10 and point of curve right of a 377.00 foot radius curve;  
thence along the arc of said curve right through a central angle of  
15°06'24", 99.40 feet (chord bears N.84°59'40"W., 99.11 feet) to station  
"I" 47+24.50; thence N.77°26'28"W., 3.59 feet to station "I" 47+28.09 and  
point of curve left of a 377.03 foot radius curve; thence along the arc of  
said curve left through a central angle of 15°06'15", 99.39 feet (chord  
bears N.84°59'36"W., 99.10 feet) to station "I" 48+27.51; thence  
S.87°27'17"W., 430.00 feet to station "I" 52+57.51; thence S.87°28'50"W.,  
5.01 feet to station "I" 52+62.52 Back; thence S.87°24'38"W., 1.99 feet to  
station "I" 52+62.52 Ahead; thence S.79°35'45"W. to the Ordinary Low Water  
line of the Willamette River.

Bearings and distances are based upon the Oregon State Coordinate System -  
North Zone (horizontal scale factor = .9999006).







**CITY OF OREGON CITY**

INCORPORATED 1844

FOR AGENDA

DATED

September 4, 1985

## COMMISSION REPORT

Page 1 of 2

TO THE HONORABLE MAYOR AND COMMISSIONERS

Subject: Tri-City Service District Request for  
Easement on Oregon City Sewage Treatment  
Plant Property.

Report No. 85-80

On the September 4, 1985 agenda, there is a request from Tri-City Service District (District) for a revised sewer easement along the Oregon City Sewage Treatment Plant property on Clackamette Drive. See attached map and exhibits.

### Background:

At its July 5, 1984 meeting, the City Commission authorized the execution of a sewer easement for the construction and maintenance of Willamette Interceptor 1-A along the existing sewage treatment plant property.

### Easement Revision:

During the construction work in Clackamette Drive, the existing City water main was discovered to be much closer to the proposed sewer main alignment than was shown on the plans.

In order to clear the water main and maintain the State mandated clearance between sewer and water mains to preclude contamination of the public water supply, District has requested approval to move the sewer main alignment ten feet ~~westerly~~ *easterly* onto the existing sewage treatment plant site. The proposed additional ten-foot wide sewer easement, as shown on the attached map, will be located in the front setback area of the sewage treatment plant site. It will not, however, adversely impact future development of the site.



**CITY OF OREGON CITY**

INCORPORATED 1844

FOR AGENDA  
DATED

September 4, 1985

## COMMISSION REPORT

Page 2 of 2

TO THE HONORABLE MAYOR AND COMMISSIONERS

Subject: Tri-City Service District Request for  
Easement on Oregon City Sewage Treatment  
Plant Property.

Report No. 85-80

The request has been reviewed by and found acceptable to the Planning Director and the Director of Public Works. The City Attorney has reviewed the easement documents and approved them as to form.

Based on the above information, it is recommended that the following motion be approved:

That the Mayor and City Manager are hereby directed and authorized to sign a Sewer Easement for Tri-City Service District as outlined in Commission Report No. 85-80.

NOEL J. KLEIN  
City Manager

RAD:jkm  
Attach.  
cc:

Director of Public Works  
Wilbur Schick, Property Management Department,  
Clackamas County General Services Agency



McLOUGHLIN (99-E) BLVD

PROPERTY LINE

FIRE DEPT. TRAINING SITE

OREGON CITY SEWAGE TREATMENT PLANT

50' CONSTRUCTION EASEMENT

10' SEWER EASEMENT

PROPERTY LINE

CLACKAMETTE DRIVE

PROPERTY LINE

CLACKAMETTE PARK

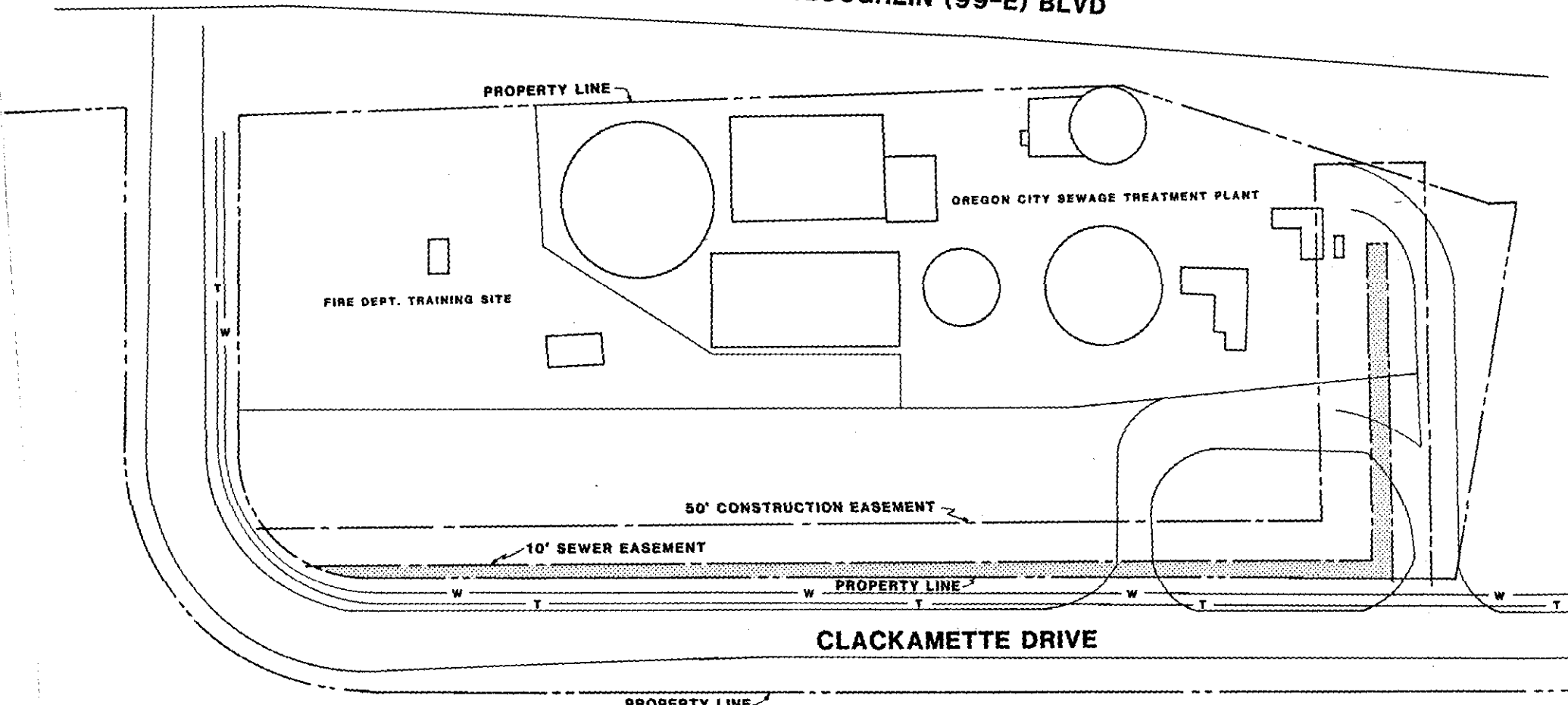

**CITY OF OREGON CITY**  
**- MEMORANDUM -**

**DATE:** August 27, 1985

**TO:** JEAN K. McNULTY, City Recorder

**FROM:** ROSALIND A. DANIELS, Director of Public Works

**SUBJECT:** AGENDA ITEM FOR SEPTEMBER 4, 1985 CITY COMMISSION MEETING  
Tri-City Service District Request for Easement on  
Oregon City Sewage Treatment Plant Property

On the September 4, 1985 agenda is a request from Tri-City Service District (District) for a revised sewer easement along the Oregon City Sewage Treatment Plant property on Clackamette Drive. (See attached map and exhibits.)

BACKGROUND:

On July 5th, 1985, the City Commission authorized the execution of a sewer easement for the construction and maintenance of Willamette Interceptor 1-A along the existing sewage treatment plant property.

EASEMENT REVISION:

During the construction work in Clackamette Drive the existing City water main was discovered to be much closer to the proposed sewer main alignment than was shown on the plans. In order to clear the water main and maintain the state mandated clearance between sewer and water mains to preclude contamination of the public water supply, the District has requested approval to move the sewer main alignment ten feet westerly onto the existing sewage treatment plant site. The proposed additional ten-foot wide sewer easement, as shown on the attached map, will be located in the front set back area of the sewage treatment site. It will not, however, adversely impact the future development of the site. The request has been reviewed by and found acceptable to the Planning Director and the Director of Public Works. The City Attorney has reviewed the easement documents and approved them as to form.

RECOMMENDATION:

It is recommended that the City Commission authorize the Mayor and City Manager to execute the attached revised sewer easement documents for Tri-City Sewer District.

  
ROSALIND A. DANIELS, P.E.  
Director of Public Works

RAD/im