

RESOLUTION NO. 10-04

**A RESOLUTION INITIATING VACATION OF A SECTION OF MAIN STREET,
CLACKAMAS COUNTY, CITY OF OREGON CITY, OREGON.**

WHEREAS, it is the intention of the City Commission of Oregon City, Oregon that proceedings be and hereby are initiated upon its own motion for the vacation hereinafter described. The City Recorder is hereby directed to cause notice to be given as provided by law for such vacation. Wednesday, March 3, 2010, at the hour of 7:00 p.m. in the Commission Chambers at City Hall, 320 Warner-Milne Road, Oregon City, Oregon, is hereby fixed as the time and place for the hearing of any and all objections or claims concerning this vacation.

The proposed vacation is a westerly portion of Main Street, described as follows:

Described by attachment Exhibit A (Legal Description) and Exhibit B (MAP)

WHEREAS, this vacation would enhance the development potential of the neighboring property known as 16381 & 16421 Main Street (also known as Tax Lot 2900 / 2900A1 of Tax Map 2-2E-29); and

WHEREAS, this vacation area is not needed for the final alignment and build-out of said Main Street; and

WHEREAS, Oregon City Public Works Staff has determined that this proposed vacation will not have a negative impact / effect on adjacent properties.

NOW, THEREFORE, BE IT RESOLVED by the City Commission of Oregon City, Oregon, to approve Resolution 10-04 to initiate the above described vacation.

Adopted, signed and approved this 3rd day of March 2010.



ALICE NORRIS, Mayor

ATTESTED to this 3rd of March 2010.



NANCY IDE, City Recorder

Exhibit " A "

LEGAL DESCRIPTION

MAIN STREET RIGHT OF WAY VACATION

February 16, 2010

Page 1 OF 2

A TRACT OF LAND LOCATED IN THE HIRAM STRAIGHT DLC NO. 42, SITUATED IN SECTION 29, TOWNSHIP 2 SOUTH, RANGE 2 EAST, WILLAMETTE MERIDIAN, CLACKAMAS COUNTY, OREGON, BEING MORE PARTICULARLY DESCRIBED AS FOLLOWS:

BEGINNING AT A POINT ON THE NORTHEASTERLY LINE OF LOT 2, "CLACKAMETTE COVE", PLAT NO. 4289, CLACKAMAS COUNTY PLAT RECORDS, FROM WHICH THE INITIAL POINT OF SAID "CLACKAMETTE COVE" BEARS NORTH 26° 23' 29" EAST, 2430.50 FEET; THENCE ALONG THE EASTERLY LINE OF SAID LOT 2 AND THE WESTERLY RIGHT OF WAY LINE OF THE ABANDONED PORTLAND TRACTION COMPANY RAILROAD, SAID WESTERLY RIGHT OF WAY LINE (BEING 70.00 FEET FROM THE CENTERLINE THEREOF, WHEN MEASURED PERPENDICULAR THERETO) AND 2794.79 FOOT RADIUS CURVE TO THE RIGHT THROUGH A CENTRAL ANGLE OF 07° 55' 14" AN ARC DISTANCE OF 386.35 FEET (THE CHORD OF WHICH BEARS SOUTH 28° 35' 21" WEST, 386.04 FEET) TO A POINT OF NON-TANGENCY; THENCE LEAVING SAID RIGHT OF WAY LINE SOUTH 12° 30' 12" WEST, 30.08 FEET; THENCE SOUTH 34° 09' 49" WEST, 44.28 FEET TO THE WESTERLY RIGHT OF WAY LINE OF THE ABANDONED PORTLAND TRACTION COMPANY RAILROAD, BEING A POINT OF NON-TANGENTIAL CURVATURE; THENCE ALONG SAID WESTERLY RIGHT OF WAY LINE (BEING 60.00 FEET FROM THE CENTERLINE THEREOF, WHEN MEASURED PERPENDICULAR THERETO) AND 378.31 FOOT RADIUS CURVE TO THE LEFT THROUGH A CENTRAL ANGLE OF 15° 12' 37" AN ARC DISTANCE OF 100.43 FEET (THE CHORD OF WHICH BEARS SOUTH 26° 25' 33" WEST, 100.14 FEET) TO A POINT OF NON-TANGENCY; THENCE LEAVING SAID WESTERLY RIGHT OF WAY LINE, NORTH 40° 33' 12" EAST, 135.75 FEET; THENCE NORTH 29° 07' 33" EAST, 143.38 FEET TO A POINT OF CURVATURE; THENCE ALONG A 230.00 FOOT RADIUS CURVE TO THE RIGHT THROUGH A CENTRAL ANGLE OF 16° 19' 09" AN ARC DISTANCE OF 65.51 FEET (THE CHORD OF WHICH BEARS NORTH 37° 17' 08" EAST, 65.29 FEET) TO A POINT OF REVERSE CURVATURE; THENCE ALONG A 330.00 FOOT RADIUS CURVE TO THE LEFT THROUGH A CENTRAL ANGLE OF 24° 20' 59" AN ARC DISTANCE OF 140.24 FEET (THE CHORD OF WHICH BEARS NORTH 26° 55' 04" EAST, 139.19 FEET); THENCE NORTH 19° 04' 59" EAST, 32.29 FEET TO A POINT OF CURVATURE; THENCE ALONG A 78.48 FOOT RADIUS CURVE TO THE LEFT THROUGH A CENTRAL ANGLE OF 42° 25' 03" AN ARC DISTANCE OF 62.21 FEET (THE CHORD OF WHICH BEARS NORTH 09° 58' 24" WEST, 60.60 FEET) TO THE POINT OF BEGINNING.

CONTAINS 17,701 SQUARE FEET OR 0.41 ACRES, MORE OR LESS

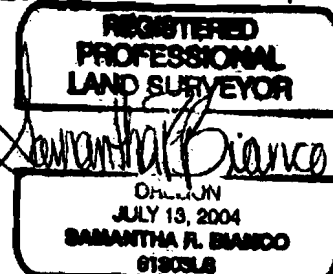

CURVE 1
 L: 100.43'
 R: 378.31'
 D: 15°12'37"
 CH: S26°25'33"W;
 100.14'

CURVE 2
 L: 386.35'
 R: 2794.79
 D: 7°55'14"
 CH: S28°35'21"W;
 386.04'

CURVE 3
 L: 62.21'
 R: 78.48'
 D: 42°25'03"
 CH: N9°58'24"W;
 60.60'

CURVE 4
 L: 140.24'
 R: 330.00
 D: 24°20'59"
 CH: N26°55'04"E;
 139.19'

CURVE 5
 L: 85.51'
 R: 230.00'
 D: 16°19'09"
 CH: N37°17'08"E;
 65.29'

LINE 1
 S34°09'49"W; 44.28'

LINE 2
 S12°30'12"W; 30.08'

LINE 3
 N19°04'59"E; 32.29'

LINE 4
 N29°07'33"E; 143.38'

LINE 5
 N40°33'12"E; 135.75'

LOT 2
 "CLACKAMETTE
 COVE"
 PLAT NO. 4289

RIGHT OF WAY
 VACATION
 17,701SF
 0.41 ACRES

POINT OF
 BEGINNING

INITIAL POINT
 "CLACKAMETTE COVE"

MAIN STREET

N26°23'28"E 2430.50'

N23°44'20"E 412.18'

INTERSTATE 205

L=514.61'
 R=2864.79'
 Δ=10°17'32"
 CH=N28°53'06"E 513.92'

L=178.08'
 R=318.31'
 Δ=32°03'15"
 CH=S18°00'14"W 175.77'

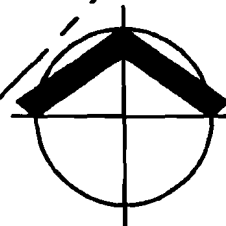

SCALE: 1"=100'



**Cardno
 WRG**

PORTLAND
 8116 SW WESTGATE DR, STE 100, PORTLAND, OR 97221
 TEL: (503) 419-3800 FAX: (503) 419-3800
 www.cardnogr.com
 PLANNERS • ENGINEERS • LANDSCAPE ARCHITECTS • SURVEYORS

EXHIBIT "B"
RIGHT-OF-WAY VACATION

820, T28, R2E, WILLAMETTE MERIDIAN
 CLACKAMAS COUNTY, OREGON

PROJECT NO. PAP8828

DATE: 02/18/10

BY: JTE

SCALE: 1"=100'

PAGE NO. 2 OF 2