

# **WEST LINN**

## **MEETING NOTICE**

### **Traffic Safety Committee**

January 26th, 2012(Thursday)

1:00 – 2:00 pm

Bolton Conference Room

City Hall

22500 Salamo Road

West Linn, OR 97068

---

- **Agenda Item #1: TC-12-01 Scott Mader (503-557-7269) – Intersection of Ponderay and Crescent – Remove Island and install stop signs on Ponderay. TC-12-01A: Bill Hill, CSHOA President – letter in support of Scott Mader’s concern.**
- **Agenda Item #2: Project Update.**

For special assistance under the Americans with Disabilities Act, please call City Hall 48 hours prior to the meeting date, 503-657-0331 or TDD 503-657-7845.



CITY OF

West Linn

Public Works Department • 4100 Norfolk St • West Linn, Oregon 97068  
Telephone 503.656.6081 • Fax 503.657.3237

TC-12-01

## REQUEST FOR TRAFFIC CONTROL INVESTIGATION/IMPROVEMENT

TODAY'S DATE: 11/29/11 DATE PROBLEM NOTED: years  
 APPLICANT'S NAME: Scott Mader TIME OF DAY: AM/PM  
 ADDRESS: 22515 Ponderay Dr CONTRIBUTING FACTORS: (CHECK ONE):  
 ( ) Weather ( ) Road Surface Condition  
 ( ) Hedges/Trees ( ) Street Lighting  
 (X) Others Islands.  
 TELEPHONE: (H) 503 557-7269  
 (W)

LOCATION OF PROBLEM: Intersection of Ponderay Dr +  
 Crescent Dr

REQUEST: Remove Island + Put A Stop Sign.  
 (multiple cars have plowed into the island)

REASON REQUESTED Traffic heading towards Salamo  
 on Ponderay Drives fast + if you are  
 backing out of your Driveway you cannot  
 see them coming because of dip in Road.

ADDITIONAL COMMENTS: Also child safety issue. City  
 has had Traffic Speed monitors up several  
 times. It is just a matter of time before a major  
 collision of cars / pedestrians occur.

Thank you for completing this informational form. Your input is an important part of analyzing the above  
 described problem. City Staff will review your request and conduct the necessary investigations. Please use  
 the back of this form for a sketch or diagram as appropriate.

Please return to: Attn: Jeff Randall  
 Public Works Department  
 City of West Linn  
 4100 Norfolk Street  
 West Linn, OR 97068

Phone: (503) 656-6081 x2103  
 e-mail: jrandall@westlinnoregon.gov

TC-12-01A

## Cascade Summit Owners Association

*c/o The Management Group, Inc.*

---

15350 SW Sequoia Parkway, Suite 200  
Portland, OR 97224  
Phone (503) 858-1094  
Fax (503) 598-0554

7710 NE Vancouver Mall Dr  
Vancouver, WA 98662  
Phone (360) 397-0288  
Fax (360) 397-0265

December 15, 2011

Jeff Randall  
Public Works Department  
City of West Linn  
4100 Norfolk Street  
West Linn, Oregon 97068

Dear Jeff

I serve as President of the Cascade Summit Home Owners Association and am writing to you on behalf of Mr. Scott Mader, who resides within our HOA. Mr. Mader lives on Ponderay at the corner of the intersection and Cresant Drive and has expressed concerned about the continuing safety issues raised by drivers as they speed through that intersection. As you may recall a few years ago our Association spear headed the installation of the existing dividers that were installed by the City to address the same problem that Mr. Mader is expressing. Our Association initially funded the dividers which at a later date were reimbursed for those costs by the City. Even since the installation of the dividers and the periodic speed reminder equipment that is placed at this location, the speeding has continued. It has been noticed on a number of occasions by community members that the pole that displays the sidewalk sign has been damaged by apparent speeding drivers. So, even with everyone's cooperation the problem has failed to be solved.

I would offer for consideration the possibility of the installation of stop signs as needed at this spot to resolve the continued problem of vehicle speeding before a tragedy occurs. I recognize that this may not be the only location within the City that has this problem, however, the record of our willingness to work with the City to solve local area concerns stands on its' own merit. I would request that you consider examining/reviewing this location again to determine, if stop signs are appropriate. We would be happy to assist the City any way we can with this matter. I can assure you that Mr. Mader is a very positive and responsible member of not only Cascade Summit, but of the entire community West Linn area.

I look forward to your reply

Sincerely,

Bill Hill, President of Cascade Summit Home Owners Association. 503- 975-9990  
cc: [Scott.Mader@va.gov](mailto:Scott.Mader@va.gov)  
[jrandall@westlinnoregon.gov](mailto:jrandall@westlinnoregon.gov)



City of West Linn GIS (Geographic Information System), SnapMap Date: 12/29/2011

Scale: 034 Feet

**MAP DISCLAIMER:**

This product is for informational purposes and may not have been prepared for, or be suitable for legal, engineering, or surveying purposes. Users of this information should review or consult the primary data and information sources to ascertain the usability of the information.

TC-12-01-A

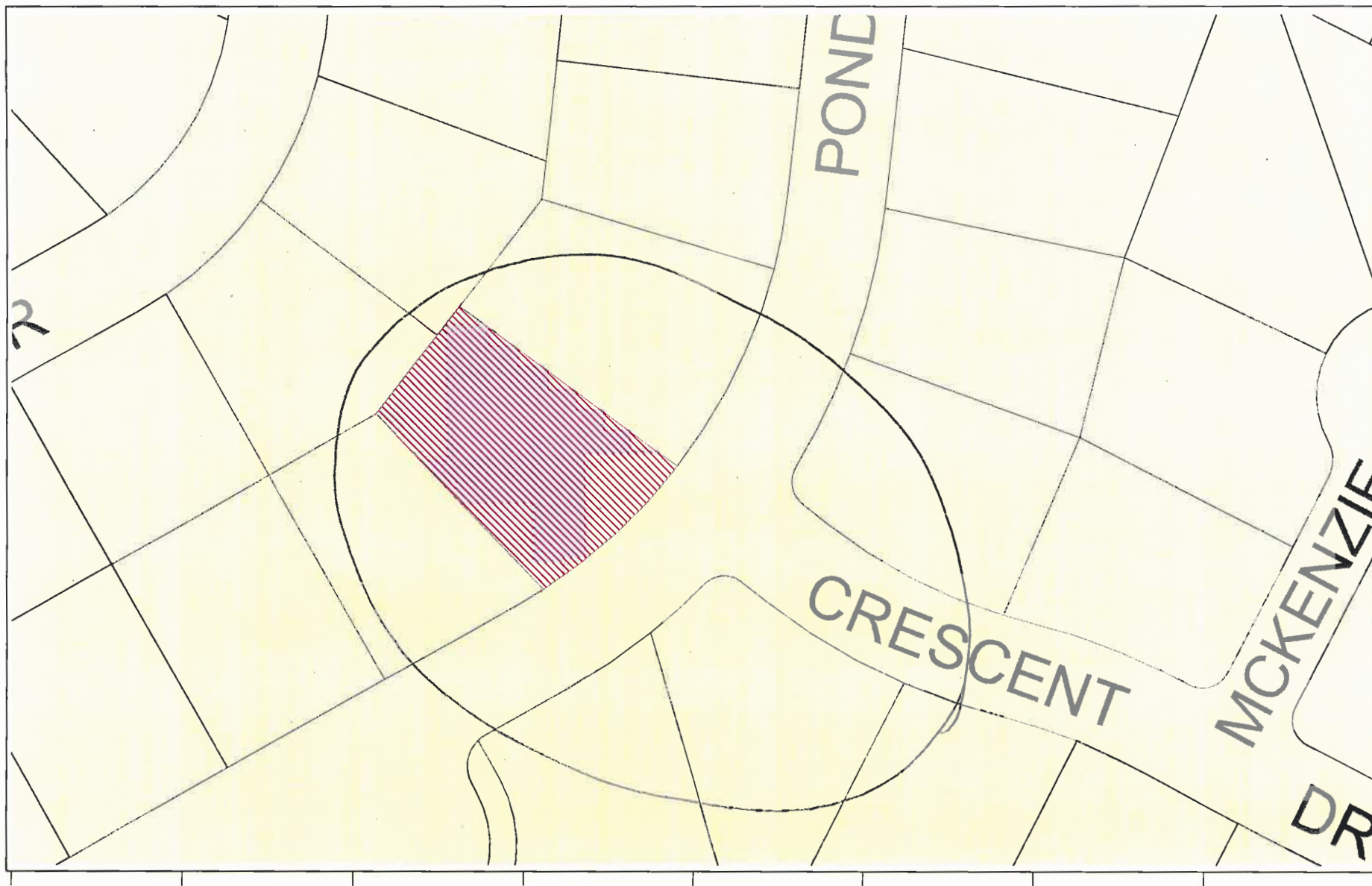

City of West Linn GIS (Geographic Information System), SnapMap Date: 12/29/2011

Scale: 089 Feet

**MAP DISCLAIMER:**

This product is for informational purposes and may not have been prepared for, or be suitable for legal, engineering, or surveying purposes.

Users of this information should review or consult the primary data and information sources to ascertain the usability of the information.

TC-12-01-A





Scale: 147 Feet

This product is for informational purposes and may not have been prepared for, or be suitable for legal, engineering, or surveying purposes. Users of this information should review or consult the primary data and information sources to ascertain the usability of the information.

mis -

Here is the latest  
Traffic Study For  
Ponderay DR and one  
that was done in 2005

JK

**Nu-Metrics Traffic Analyzer Study  
Computer Generated Summary Report  
City: WEST LINN  
Street: 22315 PODERAY DR.**

A study of vehicle traffic was conducted with HI-STAR unit number 3884. The study was done in the SB lane on 22315 PODERAY DR. in WEST LINN, OR in CLACK county. The study began on 05/31/2005 at 04:00 PM and concluded on 06/02/2005 at 04:00 PM, lasting a total of 48 hours. Data was recorded in 15 minute time periods. The total recorded volume of traffic showed 789 vehicles passed through the location with a peak volume of 16 on 06/02/2005 at 03:15 PM and a minimum volume of 0 on 05/31/2005 at 11:15 PM. The AADT Count for this study was 395.

**SPEED**

Chart 1 lists the values of the speed bins and the total traffic volume for each bin.

**Chart 1**

0 to 9	10 to 14	15 to 19	20 to 24	25 to 29	30 to 34	35 to 39	40 to 44	45 to 49	50 to 54	55 to 59	60 to 64	65 to 69	70 to 74	75 >
0	17	65	229	280	115	32	22	6	5	4	3	1	2	1

At least half of the vehicles were traveling in the 25 - 29 mph range or a lower speed. The average speed for all classified vehicles was 27 mph with 60.2 percent exceeding the posted speed of 25 mph. The HI-STAR found 1.41 percent of the total vehicles were traveling in excess of 55 mph. The mode speed for this traffic study was 25 mph and the 85th percentile was 33.20 mph.

**CLASSIFICATION**

Chart 2 lists the values of the eight classification bins and the total traffic volume accumulated for each bin.

**Chart 2**

0 to 20	21 to 27	28 to 39	40 to 49	50 to 59	60 to 69	70 to 79	80 >
706	53	18	3	2	0	0	0

Most of the vehicles classified during the study were Passenger Cars. The number of Passenger Cars in the study was 759 which represents 97.10 percent of the total classified vehicles. The number of Small Trucks in the study was 18 which represents 2.30 percent of the total classified vehicles. The number of Trucks/Buses in the study was 3 which represents 0.40 percent of the total classified vehicles. The number of Tractor Trailers in the study was 2 which represents 0.30 percent of the total classified vehicles.

**HEADWAY**

During the peak time period, on 06/02/2005 at 03:15 PM the average headway between the vehicles was 52.94 seconds. The slowest traffic period was on 05/31/2005 at 11:15 PM. During this slowest period, the average headway was 900.0 seconds.

**WEATHER**

The roadway surface temperature over the period of the study varied between 58 and 95 degrees Fahrenheit. The HI-STAR determined that the roadway surface was Dry 100.00 percent of the time.



### City of West Linn Traffic Study

Hi-Starr ID#: 3884

Begin Date: 05/31/05 Time: 4:00 PM

End Date: 06/02/05 Time: 4:00 PM

Street: 22315 Ponderay DR

Lane Direction: S Bound Total Hours: 48

Posted Speed: 25

### Report

Total Volume: 771

Daily Average: 386

<u>Speed</u>	<u>Volume</u>
0-19	<u>82</u>
20-24	<u>229</u>
25-29	<u>280</u>
30-34	<u>115</u>
35-39	<u>32</u>
40-44	<u>22</u>
45-49	<u>6</u>
50-54	<u>5</u>

Average Speed: 27 MPH

85 Percentile: 33.2 MPH

**Nu-Metrics Traffic Analyzer Study**  
**Computer Generated Summary Report**  
**City: WEST LINN**  
**Street: 22570 PONDERAY DR**

A study of vehicle traffic was conducted with HI-STAR unit number 1854. The study was done in the WB lane on 22570 PONDERAY DR in WEST LINN, OR in CLACK county. The study began on 05/31/2005 at 04:00 PM and concluded on 06/02/2005 at 04:00 PM, lasting a total of 48 hours. Data was recorded in 15 minute time periods. The total recorded volume of traffic showed 1,348 vehicles passed through the location with a peak volume of 27 on 06/02/2005 at 03:15 PM and a minimum volume of 0 on 05/31/2005 at 10:15 PM. The AADT Count for this study was 674.

**SPEED**

Chart 1 lists the values of the speed bins and the total traffic volume for each bin.

**Chart 1**

0 to 9	10 to 14	15 to 19	20 to 24	25 to 29	30 to 34	35 to 39	40 to 44	45 to 49	50 to 54	55 to 59	60 to 64	65 to 69	70 to 74	75 >
0	26	157	494	450	144	34	14	1	12	1	3	3	5	2

At least half of the vehicles were traveling in the 20 - 24 mph range or a lower speed. The average speed for all classified vehicles was 26 mph with 49.7 percent exceeding the posted speed of 25 mph. The HI-STAR found 1.04 percent of the total vehicles were traveling in excess of 55 mph. The mode speed for this traffic study was 20 mph and the 85th percentile was 30.59 mph.

**CLASSIFICATION**

Chart 2 lists the values of the eight classification bins and the total traffic volume accumulated for each bin.

**Chart 2**

0 to 20	21 to 27	28 to 39	40 to 49	50 to 59	60 to 69	70 to 79	80 >
1259	55	30	2	0	0	0	0

Most of the vehicles classified during the study were Passenger Cars. The number of Passenger Cars in the study was 1,314 which represents 97.60 percent of the total classified vehicles. The number of Small Trucks in the study was 30 which represents 2.20 percent of the total classified vehicles. The number of Trucks/Buses in the study was 2 which represents 0.10 percent of the total classified vehicles. The number of Tractor Trailers in the study was 0 which represents 0.00 percent of the total classified vehicles.

**HEADWAY**

During the peak time period, on 06/02/2005 at 03:15 PM the average headway between the vehicles was 32.14 seconds. The slowest traffic period was on 05/31/2005 at 10:15 PM. During this slowest period, the average headway was 900.0 seconds.

**WEATHER**

The roadway surface temperature over the period of the study varied between 58 and 97 degrees Fahrenheit. The HI-STAR determined that the roadway surface was Dry 91.15 percent of the time.

### City of West Linn Traffic Study

Hi-Starr ID#: 1854

Begin Date: 05/31/05 Time: 4:00 PM

End Date: 06/02/05 Time: 4:00 PM

Street: 22570 Ponderay DR

Lane Direction: W Bound Total Hours: 48

Posted Speed: 25

### Report

Total Volume: 1332

Daily Average: 666

<u>Speed</u>	<u>Volume</u>
0-19	<u>183</u>
20-24	<u>494</u>
25-29	<u>450</u>
30-34	<u>144</u>
35-39	<u>34</u>
40-44	<u>14</u>
45-49	<u>1</u>
50-54	<u>12</u>

Average Speed: 26 MPH

85 Percentile: 30.59 MPH

**Nu-Metrics Traffic Analyzer Study**  
**Computer Generated Summary Report**  
**City: west linn**  
**Street: 22570 PONDERAY DR.**

A study of vehicle traffic was conducted with HI-STAR unit number 388. The study was done in the EB lane on 22570 PONDERAY DR. in west linn, or in CLACK county. The study began on 05/31/2005 at 04:00 PM and concluded on 06/02/2005 at 04:00 PM, lasting a total of 48 hours. Data was recorded in 15 minute time periods. The total recorded volume of traffic showed 1,297 vehicles passed through the location with a peak volume of 23 on 06/01/2005 at 06:45 PM and a minimum volume of 0 on 05/31/2005 at 11:30 PM. The AADT Count for this study was 649.

**SPEED**

Chart 1 lists the values of the speed bins and the total traffic volume for each bin.

**Chart 1**

0 to 9	10 to 14	15 to 19	20 to 24	25 to 29	30 to 34	35 to 39	40 to 44	45 to 49	50 to 54	55 to 59	60 to 64	65 to 69	70 to 74	75 >
0	37	134	409	452	179	35	10	10	5	2	4	4	3	1

At least half of the vehicles were traveling in the 25 - 29 mph range or a lower speed. The average speed for all classified vehicles was 26 mph with 54.8 percent exceeding the posted speed of 25 mph. The HI-STAR found 1.09 percent of the total vehicles were traveling in excess of 55 mph. The mode speed for this traffic study was 25 mph and the 85th percentile was 31.68 mph.

**CLASSIFICATION**

Chart 2 lists the values of the eight classification bins and the total traffic volume accumulated for each bin.

**Chart 2**

0 to 20	21 to 27	28 to 39	40 to 49	50 to 59	60 to 69	70 to 79	80 >
1206	48	22	8	0	1	0	0

Most of the vehicles classified during the study were Passenger Cars. The number of Passenger Cars in the study was 1,254 which represents 97.60 percent of the total classified vehicles. The number of Small Trucks in the study was 22 which represents 1.70 percent of the total classified vehicles. The number of Trucks/Buses in the study was 8 which represents 0.60 percent of the total classified vehicles. The number of Tractor Trailers in the study was 1 which represents 0.10 percent of the total classified vehicles.

**HEADWAY**

During the peak time period, on 06/01/2005 at 06:45 PM the average headway between the vehicles was 37.5 seconds. The slowest traffic period was on 05/31/2005 at 11:30 PM. During this slowest period, the average headway was 900.0 seconds.

**WEATHER**

The roadway surface temperature over the period of the study varied between 58 and 93 degrees Fahrenheit. The HI-STAR determined that the roadway surface was Dry 38.54 percent of the time.

### City of West Linn Traffic Study

Hi-Starr ID#: 388

Begin Date: 05/31/05 Time: 4:00 PM

End Date: 06/02/05 Time: 4:00 PM

Street: 22570 Ponderay DR

Lane Direction: E Bound Total Hours: 48

Posted Speed: 25

### Report

Total Volume: 1271 Daily Average: 636

<u>Speed</u>	<u>Volume</u>
0-19	<u>171</u>
20-24	<u>409</u>
25-29	<u>452</u>
30-34	<u>179</u>
35-39	<u>35</u>
40-44	<u>10</u>
45-49	<u>10</u>
50-54	<u>5</u>

Average Speed: 26 MPH

85 Percentile: 31.68 MPH





**Nu-Metrics Traffic Analyzer Study**  
**Computer Generated Summary Report**  
**City: West Linn**  
**Street: 22515 Ponderay DR**

A study of vehicle traffic was conducted with HI-STAR unit number 3884. The study was done in the S Bound lane on 22515 Ponderay DR in West Linn, OR in Clackamas county. The study began on 12/21/2011 at 02:00 PM and concluded on 12/23/2011 at 02:00 PM, lasting a total of 48 hours. Data was recorded in 15 minute time periods. The total recorded volume of traffic showed 1,502 vehicles passed through the location with a peak volume of 26 on 12/23/2011 at 12:30 PM and a minimum volume of 0 on 12/22/2011 at 12:45 AM. The AADT Count for this study was 751.

**SPEED**

Chart 1 lists the values of the speed bins and the total traffic volume for each bin.

**Chart 1**

0 to 9	10 to 14	15 to 19	20 to 24	25 to 29	30 to 34	35 to 39	40 to 44	45 to 49	50 to 54	55 to 59	60 to 64	65 to 69	70 to 74	75 >
0	59	459	529	298	73	30	13	6	4	2	2	1	4	2

At least half of the vehicles were traveling in the 20 - 24 mph range or a lower speed. The average speed for all classified vehicles was 23 mph with 29.3 percent exceeding the posted speed of 25 mph. The HI-STAR found 0.74 percent of the total vehicles were traveling in excess of 55 mph. The mode speed for this traffic study was 20 mph and the 85th percentile was 28.57 mph.

**CLASSIFICATION**

Chart 2 lists the values of the eight classification bins and the total traffic volume accumulated for each bin.

**Chart 2**

0 to 20	21 to 27	28 to 39	40 to 49	50 to 59	60 to 69	70 to 79	80 >
1360	85	28	3	3	3	0	0

Most of the vehicles classified during the study were Passenger Cars. The number of Passenger Cars in the study was 1,445 which represents 97.50 percent of the total classified vehicles. The number of Small Trucks in the study was 28 which represents 1.90 percent of the total classified vehicles. The number of Trucks/Buses in the study was 3 which represents 0.20 percent of the total classified vehicles. The number of Tractor Trailers in the study was 6 which represents 0.40 percent of the total classified vehicles.

**HEADWAY**

During the peak time period, on 12/23/2011 at 12:30 PM the average headway between the vehicles was 33.33 seconds. The slowest traffic period was on 12/22/2011 at 12:45 AM. During this slowest period, the average headway was 900.0 seconds.

**WEATHER**

The roadway surface temperature over the period of the study varied between 29 and 46 degrees Fahrenheit. The HI-STAR determined that the roadway surface was Dry 100.00 percent of the time.

## City of West Linn Traffic Study

Hi-Starr ID#: 3884

Begin Date: 12/21/11 Time: 2:00 PM

End Date: 12/23/11 Time: 2:00 PM

Street: 22515 Ponderay DR

Lane Direction: S Bound Total Hours: 48

Posted Speed: 25

### Report

Total Volume: 1471

Daily Average: 736

<u>Speed</u>	<u>Volume</u>
0-19	<u>518</u>
20-24	<u>529</u>
25-29	<u>298</u>
30-34	<u>73</u>
35-39	<u>30</u>
40-44	<u>13</u>
45-49	<u>6</u>
50-54	<u>4</u>

Average Speed: 23 MPH

85 Percentile: 28.57 MPH

**Nu-Metrics Traffic Analyzer Study**  
**Computer Generated Summary Report**  
**City: West Linn**  
**Street: 22540 Ponderay DR**

A study of vehicle traffic was conducted with HI-STAR unit number 4280. The study was done in the N Bound lane on 22540 Ponderay DR in West Linn, OR in Clackamas county. The study began on 12/21/2011 at 02:00 PM and concluded on 12/23/2011 at 02:00 PM, lasting a total of 48 hours. Data was recorded in 15 minute time periods. The total recorded volume of traffic showed 1,316 vehicles passed through the location with a peak volume of 22 on 12/21/2011 at 04:45 PM and a minimum volume of 0 on 12/22/2011 at 01:30 AM. The AADT Count for this study was 658.

**SPEED**

Chart 1 lists the values of the speed bins and the total traffic volume for each bin.

**Chart 1**

0 to 9	10 to 14	15 to 19	20 to 24	25 to 29	30 to 34	35 to 39	40 to 44	45 to 49	50 to 54	55 to 59	60 to 64	65 to 69	70 to 74	75 >
0	53	397	539	205	45	20	9	12	9	3	5	3	3	3

At least half of the vehicles were traveling in the 20 - 24 mph range or a lower speed. The average speed for all classified vehicles was 23 mph with 24.2 percent exceeding the posted speed of 25 mph. The HI-STAR found 1.30 percent of the total vehicles were traveling in excess of 55 mph. The mode speed for this traffic study was 20 mph and the 85th percentile was 27.95 mph.

**CLASSIFICATION**

Chart 2 lists the values of the eight classification bins and the total traffic volume accumulated for each bin.

**Chart 2**

0 to 20	21 to 27	28 to 39	40 to 49	50 to 59	60 to 69	70 to 79	80 >
1251	32	22	0	1	0	0	0

Most of the vehicles classified during the study were Passenger Cars. The number of Passenger Cars in the study was 1,283 which represents 98.20 percent of the total classified vehicles. The number of Small Trucks in the study was 22 which represents 1.70 percent of the total classified vehicles. The number of Trucks/Buses in the study was 0 which represents 0.00 percent of the total classified vehicles. The number of Tractor Trailers in the study was 1 which represents 0.10 percent of the total classified vehicles.

**HEADWAY**

During the peak time period, on 12/21/2011 at 04:45 PM the average headway between the vehicles was 39.13 seconds. The slowest traffic period was on 12/22/2011 at 01:30 AM. During this slowest period, the average headway was 900.0 seconds.

**WEATHER**

The roadway surface temperature over the period of the study varied between 29 and 46 degrees Fahrenheit. The HI-STAR determined that the roadway surface was Dry 100.00 percent of the time.

### City of West Linn Traffic Study

Hi-Starr ID#: 4280

Begin Date: 12/21/11 Time: 2:00 PM

End Date: 12/23/11 Time: 2:00 PM

Street: 22540 Ponderay DR

Lane Direction: N Bound Total Hours: 48

Posted Speed: 25

### Report

Total Volume: 1289

Daily Average: 645

<u>Speed</u>	<u>Volume</u>
0-19	<u>450</u>
20-24	<u>539</u>
25-29	<u>205</u>
30-34	<u>45</u>
35-39	<u>20</u>
40-44	<u>9</u>
45-49	<u>12</u>
50-54	<u>9</u>

Average Speed: 23 MPH

85 Percentile: 27.95 MPH



**Nu-Metrics Traffic Analyzer Study**  
**Computer Generated Summary Report**  
**City: West Linn**  
**Street: 22485 Ponderay DR**

A study of vehicle traffic was conducted with HI-STAR unit number 4316. The study was done in the S Bound lane on 22485 Ponderay DR in West Linn, OR in Clackamas county. The study began on 12/21/2011 at 02:00 PM and concluded on 12/23/2011 at 02:00 PM, lasting a total of 48 hours. Data was recorded in 15 minute time periods. The total recorded volume of traffic showed 945 vehicles passed through the location with a peak volume of 17 on 12/22/2011 at 04:00 PM and a minimum volume of 0 on 12/21/2011 at 10:45 PM. The AADT Count for this study was 473.

**SPEED**

Chart 1 lists the values of the speed bins and the total traffic volume for each bin.

**Chart 1**

0 to 9	10 to 14	15 to 19	20 to 24	25 to 29	30 to 34	35 to 39	40 to 44	45 to 49	50 to 54	55 to 59	60 to 64	65 to 69	70 to 74	75 >
0	42	248	448	187	13	3	0	0	0	0	0	0	0	0

At least half of the vehicles were traveling in the 20 - 24 mph range or a lower speed. The average speed for all classified vehicles was 22 mph with 21.5 percent exceeding the posted speed of 25 mph. The HI-STAR found 0.00 percent of the total vehicles were traveling in excess of 55 mph. The mode speed for this traffic study was 20 mph and the 85th percentile was 26.65 mph.

**CLASSIFICATION**

Chart 2 lists the values of the eight classification bins and the total traffic volume accumulated for each bin.

**Chart 2**

0 to 20	21 to 27	28 to 39	40 to 49	50 to 59	60 to 69	70 to 79	80 >
917	16	8	0	0	0	0	0

Most of the vehicles classified during the study were Passenger Cars. The number of Passenger Cars in the study was 933 which represents 99.10 percent of the total classified vehicles. The number of Small Trucks in the study was 8 which represents 0.90 percent of the total classified vehicles. The number of Trucks/Buses in the study was 0 which represents 0.00 percent of the total classified vehicles. The number of Tractor Trailers in the study was 0 which represents 0.00 percent of the total classified vehicles.

**HEADWAY**

During the peak time period, on 12/22/2011 at 04:00 PM the average headway between the vehicles was 50.0 seconds. The slowest traffic period was on 12/21/2011 at 10:45 PM. During this slowest period, the average headway was 900.0 seconds.

**WEATHER**

The roadway surface temperature over the period of the study varied between 29 and 46 degrees Fahrenheit. The HI-STAR determined that the roadway surface was Dry 100.00 percent of the time.

## City of West Linn Traffic Study

Hi-Starr ID#: 4316

Begin Date: 12/21/11 Time: 2:00 PM

End Date: 12/23/11 Time: 2:00 PM

Street: 22485 Ponderay DR

Lane Direction: S Bound Total Hours: 48

Posted Speed: 25

### Report

Total Volume: 941

Daily Average: 471

<u>Speed</u>	<u>Volume</u>
0-19	<u>290</u>
20-24	<u>448</u>
25-29	<u>187</u>
30-34	<u>13</u>
35-39	<u>3</u>
40-44	<u>0</u>
45-49	<u>0</u>
50-54	<u>0</u>

Average Speed: 22 MPH

85 Percentile: 26.65 MPH

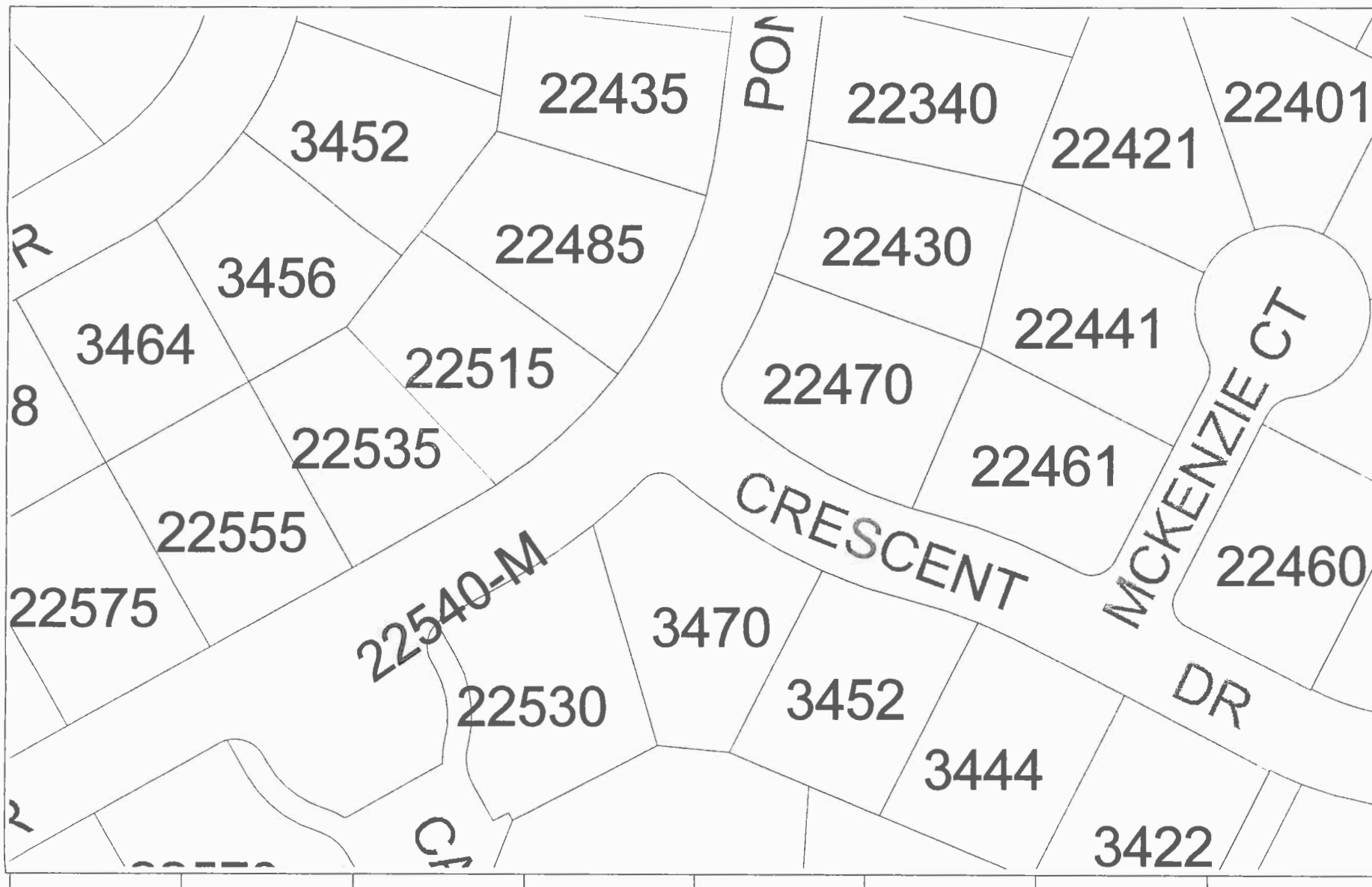

City of West Linn GIS (Geographic Information System), SnapMap Date: 12/27/2011

Scale: 099 Feet

**MAP DISCLAIMER:**

This product is for informational purposes and may not have been prepared for, or be suitable for legal, engineering, or surveying purposes. Users of this information should review or consult the primary data and information sources to ascertain the usability of the information.



City of West Linn GIS (Geographic Information System), SnapMap Date: 12/27/2011

Scale: 153 Feet

**MAP DISCLAIMER:**

This product is for informational purposes and may not have been prepared for, or be suitable for legal, engineering, or surveying purposes. Users of this information should review or consult the primary data and information sources to ascertain the usability of the information.



**Rich, Pat**

---

**From:** Wright, Dennis  
**Sent:** Tuesday, April 17, 2012 10:26 AM  
**To:** Scott.Mader@va.gov  
**Cc:** Randall, Jeffrey; Rich, Pat; Worcester, Ken  
**Subject:** FW: Update on the Ponderay-Crescent Traffic Meeting from Jan 26

Scott,

Thanks for checking in on our progress.

Jeff Randall, West Linn's Transportation Supervisor, has had a "25 mph" sign installed on the uphill westbound section approaching the intersection of Ponderay with Crescent. Additionally, Jeff has ordered reflective pylons to install along that same approach direction to narrow the travel lane and further reduce vehicle speed. These actions will hopefully make that area safer but we anticipate that there will continue to be some recurring maintenance associated with the island/median. The installation was initially done in collaboration with the neighborhood association to reduce speeds; it has been effective though not without some associated side effects.

If you have additional questions, please feel free to contact either me or Jeff Randall at your convenience.

Sincerely,

Dennis Wright

City Engineer

City of West Linn, OR

Dennis Wright, City Engineer  
Public Works, #1514

West Linn Sustainability Please consider the impact on the environment before printing a paper copy of this email.

Public Records Law Disclosure This e-mail is subject to the State Retention Schedule and may be made available to the public.

**From:** Rich, Pat  
**Sent:** Monday, April 16, 2012 7:36 AM  
**To:** Wright, Dennis; Randall, Jeffrey  
**Subject:** FW: Update on the Ponderay-Crescent Traffic Meeting from Jan 26

Pat Rich, Administrative Assistant  
Public Works, #1501

West Linn Sustainability Please consider the impact on the environment before printing a paper copy of this email.

Public Records Law Disclosure This e-mail is subject to the State Retention Schedule and may be made available to the public.

**From:** Mader, Scott (Portland) [<mailto:Scott.Mader@va.gov>]  
**Sent:** Saturday, April 14, 2012 6:01 PM  
**To:** Rich, Pat  
**Cc:** Mader, Scott (Portland); [meweieri@us.ibm.com](mailto:meweieri@us.ibm.com); Linda Graham; Walt Graham; [stevesmith\\_98@yahoo.com](mailto:stevesmith_98@yahoo.com); [gregg.wilkinson@comcast.net](mailto:gregg.wilkinson@comcast.net); [sak@hwh.com](mailto:sak@hwh.com); [longtain5@msn.com](mailto:longtain5@msn.com); [gvtach@aol.com](mailto:gvtach@aol.com); [icaruso@scsengineers.com](mailto:icaruso@scsengineers.com); [pellico4@comcast.net](mailto:pellico4@comcast.net); [steven.cook@ch2m.com](mailto:steven.cook@ch2m.com); [ghongo@comcast.net](mailto:ghongo@comcast.net); [jsmith@earleaz.com](mailto:jsmith@earleaz.com); Mom ICE; Hill, Bill; [bghadeed@msn.com](mailto:bghadeed@msn.com); [karimcnamara@msn.com](mailto:karimcnamara@msn.com); [judylofurno@msn.com](mailto:judylofurno@msn.com)  
**Subject:** Update on the Ponderay-Crescent Traffic Meeting from Jan 26

I was just checking in to see if we had made any progress/plans since our meeting.



Someone just flattened the crosswalk sign at Ponderay and Crescent again this past week.

I think there was going to be a traffic study and some other things.

---

**From:** Rich, Pat [<mailto:Prich@westlinnoregon.gov>]

**Sent:** Thursday, January 19, 2012 3:19 PM

**To:** Mader, Scott (Portland)

**Subject:** Information for the upcoming Traffic Safety meeting on January 26, 2012

---

 Pat Rich  
[Prich@westlinnoregon.gov](mailto:Prich@westlinnoregon.gov)  
Administrative Assistant  
22500 Salamo Rd.  
West Linn, OR 97068  
P: (503) 722-5501  
F: (503) 656-4106  
Web: [westlinnoregon.gov](http://westlinnoregon.gov)

West Linn Sustainability Please consider the impact on the environment before printing a paper copy of this email.

Public Records Law Disclosure This e-mail is subject to the State Retention Schedule and may be made available to the public.

Rich, Pat

---

**From:** Mader, Scott (Portland) [Scott.Mader@va.gov]  
**nt:** Saturday, April 14, 2012 6:01 PM  
**o:** Rich, Pat  
**Cc:** Mader, Scott (Portland); meweieri@us.ibm.com; Linda Graham; Walt Graham; stevesmith\_98@yahoo.com; gregg.wilkinson@comcast.net; sak@hhw.com; longtain5@msn.com; gvtach@aol.com; lcaruso@scsengineers.com; pellico4@comcast.net; steven.cook@ch2m.com; ghongo@comcast.net; jsmith@earleaz.com; Mom ICE; Hill, Bill; bghadeed@msn.com; karimcnamara@msn.com; judylofurno@msn.com  
**Subject:** Update on the Ponderay-Crescent Traffic Meeting from Jan 26

Pat,

I was just checking in to see if we had made any progress/plans since our meeting.  
Someone just flattened the crosswalk sign at Ponderay and Crescent again this past week.

I think there was going to be a traffic study and some other things.

---

**From:** Rich, Pat [<mailto:Prich@westlinnoregon.gov>]  
**Sent:** Thursday, January 19, 2012 3:19 PM  
**To:** Mader, Scott (Portland)  
**Subject:** Information for the upcoming Traffic Safety meeting on January 26, 2012

 Pat Rich  
[Prich@westlinnoregon.gov](mailto:Prich@westlinnoregon.gov)  
Administrative Assistant  
22500 Salamo Rd.  
West Linn, OR 97068  
P: (503) 722-5501  
F: (503) 656-4106  
Web: [westlinnoregon.gov](http://westlinnoregon.gov)

West Linn Sustainability Please consider the impact on the environment before printing a paper copy of this email.

Public Records Law Disclosure This e-mail is subject to the State Retention Schedule and may be made available to the public.

## Wright, Dennis

---

**From:** Rich, Pat  
**Sent:** Monday, April 16, 2012 7:36 AM  
**To:** Wright, Dennis; Randall, Jeffrey  
**Subject:** FW: Update on the Ponderay-Crescent Traffic Meeting from Jan 26

Pat Rich, Administrative Assistant  
Public Works, #1501

West Linn Sustainability Please consider the impact on the environment before printing a paper copy of this email.

Public Records Law Disclosure This e-mail is subject to the State Retention Schedule and may be made available to the public.

**From:** Mader, Scott (Portland) [<mailto:Scott.Mader@va.gov>]  
**Sent:** Saturday, April 14, 2012 6:01 PM  
**To:** Rich, Pat  
**Cc:** Mader, Scott (Portland); [meweieri@us.ibm.com](mailto:meweieri@us.ibm.com); Linda Graham; Walt Graham; [stevesmith\\_98@yahoo.com](mailto:stevesmith_98@yahoo.com); [gregg.wilkinson@comcast.net](mailto:gregg.wilkinson@comcast.net); [sak@hhw.com](mailto:sak@hhw.com); [longtain5@msn.com](mailto:longtain5@msn.com); [gvtach@aol.com](mailto:gvtach@aol.com); [icaruso@scsengineers.com](mailto:icaruso@scsengineers.com); [pellico4@comcast.net](mailto:pellico4@comcast.net); [steven.cook@ch2m.com](mailto:steven.cook@ch2m.com); [ghongo@comcast.net](mailto:ghongo@comcast.net); [jsmith@earleaz.com](mailto:jsmith@earleaz.com); Mom ICE; Hill, Bill; [bghadeed@msn.com](mailto:bghadeed@msn.com); [karimcnamara@msn.com](mailto:karimcnamara@msn.com); [judylofurno@msn.com](mailto:judylofurno@msn.com)  
**Subject:** Update on the Ponderay-Crescent Traffic Meeting from Jan 26

Pat,

I was just checking in to see if we had made any progress/plans since our meeting.  
Someone just flattened the crosswalk sign at Ponderay and Crescent again this past week.

I think there was going to be a traffic study and some other things.

---

**From:** Rich, Pat [<mailto:Prich@westlinnoregon.gov>]  
**Sent:** Thursday, January 19, 2012 3:19 PM  
**To:** Mader, Scott (Portland)  
**Subject:** Information for the upcoming Traffic Safety meeting on January 26, 2012

---

 Pat Rich  
[Prich@westlinnoregon.gov](mailto:Prich@westlinnoregon.gov)  
Administrative Assistant  
22500 Salamo Rd.  
West Linn, OR 97068  
P: (503) 722-5501  
F: (503) 656-4106  
Web: [westlinnoregon.gov](http://westlinnoregon.gov)

West Linn Sustainability Please consider the impact on the environment before printing a paper copy of this email.

Public Records Law Disclosure This e-mail is subject to the State Retention Schedule and may be made available to the public.