

MINUTES
MILWAUKIE CITY COUNCIL WORK SESSION
OCTOBER 16, 2012

Mayor Ferguson called the work session to order at 5 p.m. in the City Hall Conference Room.

Council Present: Council President Chaimov and Councilors Dave Hedges, Mike Miller, and Joe Loomis

Staff Present: City Manager Bill Monahan, Assistant to the City Manager Teri Bankhead, City Recorder Pat DuVal, Finance Director Casey Camors, Library Director Katie Newell, Public Affairs Coordinator Grady Wheeler, Community Development and Public Works Director Kenny Asher, Planning Director Steve Butler, Community Services Director JoAnn Herrigel, and Associate Planner Kari Svanstrom

Media: Victoria Edwards, *The Oregonian*

City Manager's Report

Mr. Monahan reviewed the evening's agendas including the revised coal train resolution. He updated the City Council on attempts to schedule a session with the North Clackamas School District #12 (NC12) Board of Directors. AFSCME stated it did not have any issues regarding the reorganization of the Community Services Department, so code enforcement and parking can be expected to move in about three weeks. Gary Parkin would be moved into the Public Works Operations Director position, and Gary Rebello started work on October 15 as the City's Human Resources Director.

He provided an update on the Urban Growth Management Agreement (UGMA) discussions. Happy Valley was proposing an agreement with I-205 as the boundary and requested a letter of support from Milwaukie. Mr. Monahan recommended doing so with qualifications. Mr. Ramis would report on his evaluation of his comparisons of the TriMet agreements with Clackamas County and the City of Milwaukie.

Community Development and Planning Active Projects

Mr. Butler provided an update on planning department activities including the Residential Development Standards, annexations, and Tacoma Station Planning. He discussed the Neighborhood Main Streets project that was temporarily on hold as the Planning Department reached full staffing.

Mr. Asher reported consultants were evaluating the stormwater model that would be used in developing a preliminary capital improvement project (CIP) list. He noted the infrastructure was pretty inadequate, and rates would likely be impacted. The Citizens Utility Advisory Board (CUAB) will consider the matter in January and make a recommendation to the City Council. Mr. Asher added elements would include pipes as well as pervious systems and swales.

Councilor Miller hoped a maintenance plan for swales would be included in the program.

Mr. Asher addressed the Citywide Sidewalk Improvement Program. One approach was a sidewalk local improvement district (LID) where the beneficiary pays. The other option was a citywide approach similar to the Street Surface Maintenance Program (SSMP) where a little bit of money was collected from everyone to fund the highest need projects. Each approach had beneficial aspects, and Mr. Asher asked if the City Council wished to offer any direction.

Councilor Hedges asked if there could be choices in the type of materials and commented on the Home Avenue sidewalk project. He favored the locally driven option.

Mr. Asher replied there could be options where feasible, but in some cases there may be stormwater, retaining wall, and maintenance issues. He discussed ADA and engineering requirements.

Councilor Miller stated citizens should know the costs upfront before making their decisions. He discussed the feasibility of matching funds.

Mr. Asher replied an assessment of that nature would probably cost about \$50,000.

Councilor Loomis liked the citywide alternative and hoped there would be a network plan to create walking routes to schools, shops, and churches. The SSMP was successful because it was a long-range plan, and people knew what they were paying for. He recommended including downtown sidewalks repair as a program element.

Council President Chaimov agreed with Councilor Loomis.

Mayor Ferguson did not have a strong opinion at this time and understood the citywide program would not eliminate the LID option.

Mr. Asher would work on a marketing analysis

Coal Train Resolution

Councilor Loomis said most of his questions had to do with emergency vehicle access. He asked if patrols were assigned to districts at specific times.

Mr. Monahan responded that Chief Jordan had a plan and agreements in place with other jurisdictions for backup. Adjustments might be necessary based on the coal train proposal. He discussed the distribution of police throughout the City.

The group discussed covering the cars and the availability of current technology.

Councilor Loomis wanted an honest approach. What had started out with health and safety concerns seems to have become a corporate issue.

Mayor Ferguson felt the City Council's role was concern about local safety and health hazards.

Councilor Hedges added if companies wanted to make money selling coal that was not the concern of the Milwaukie City Council. He was concerned about the dust and other adverse effects in the Gorge, Portland, and Milwaukie. The City was asking for more information on the detriments. He suggested several changes that supported other communities in the region who might end up struggling with this project.

Council President Chaimov thought the resolution should be more focused on Milwaukie.

Councilor Miller's main concerns were health, safety, and security within the City limits.

City Council Work Session – October 16, 2012

Approved Minutes

Page 2

The group agreed to include a reference to barges.

Audit Committee Composition

Ms. Camors asked for City Council clarification on the composition of the Committee and particularly the citizen member who would be a Certified Public Accountant (CPA). She asked if the Council preferred one living in the City. Her personal preference was to have a CPA who could act as an advisor.

Council President Chaimov recommended the City recruit a CPA with either an office or residence in Milwaukie. It was further agreed that the Audit Committee would be composed of one Councilor, one Budget Committee member, and one CPA

Library Expansion Task Force

Ms. Newell discussed the efforts of the Library Expansion Task Force (LETF) and the \$1 million available from the County for capital improvements. She pointed out the survey results that showed a strong desire to expand the Library on its current site. The project was now at the point of doing a needs assessment for a community this size and what kind of community space would be appropriate.

Scott Churchill, LETF member, noted that 88% of those surveyed wished to keep the Library at its current location. He addressed the request for qualifications (RFQ) for the needs assessment and massing schematic opportunities on the site. It was important that these efforts aligned with community wishes.

Councilor Hedges hoped for someone skilled in looking into a crystal ball and how libraries might change in the next 30 years. He hoped the facility would be flexible and easily kept up to date.

Mr. Churchill agreed it was important to look at the future. His personal vision was for the facility to be a vessel for both books and technology. Libraries were the heart of the community built around education.

Councilor Loomis agreed it was important that the facility be flexible and adjust with time. The main ingredient was the citizens who would be using it.

Councilor Miller noted most citizens wanted to stay on the site, and he supported that. It was the only City building where people go in happy and go out happy. It was the heart of the community and a great place where children can access programs.

Council President Chaimov commented on the productivity of the Task Force meetings and noted it was a very inclusive process.

Mr. Churchill said the intent was to have a transparent process and to bring the findings back to the City Council before spending any money.

Riverfront Park Access Options

Ms. Herrigel discussed the pros and cons of the four options for Riverfront Park access and added Water Environment Services (WES) had as yet not provided the requested data. She understood the WES concerns had to do with the absence of a light so the trucks could move north.

Council President Chaimov commented that it was the WES argument, and the parties needed to figure out some way to get to "yes."

Mayor Ferguson had visited the site with County Commissioner Damon and had spoken with Commissioners Savas and Bernard. It was agreed that it was time to engage the County Commissioners and to get the matter on an upcoming agenda.

Ms. Herrigel discussed the costs of the four options that could result in Park redesign, reengaging the stakeholders, and revising the permit applications. She said that the Oregon Department of Transportation (ODOT) did not want to install a light at Washington Street, and WES felt that no signal was a deal killer.

Councilor Hedges said one option was to do away with the boat ramp. It seemed that one entity was blocking the whole thing.

Councilor Miller commented on the wastewater treatment agreement and lack of cooperation from WES.

Councilor Loomis urged caution and said he felt genuine concern about the future of the Park.

Mayor Ferguson hoped to have things finalized by the end of the year.

Dave Green, Riverfront Task Force Chair, said this was a design that met park, open space, and boat ramp needs. Options 3 & 4 were non-starters and would initiate the whole community dialogue again. Construction and design costs would be significant, and he believed there were ways to address the safety issues. He urged pushing the conversation forward. Clackamas County had been involved since 2004 so their concerns had been a legitimate part of the Riverfront Park discussions.

Mr. Monahan discussed the easement and permanent right of access.

Ms. Herrigel expressed concern about missing the Oregon Marine Board's biennial application cycle.

TriMet Agreement

Mr. Ramis provided an analysis of the TriMet Light Rail funding agreements with the City of Milwaukie and Clackamas County.

Mayor Ferguson adjourned the work session at 6:40 p.m.

Respectfully submitted,



Pat DuVal, Recorder

WORK SESSION

**LOCALLY DRIVEN
SIDEWALK IMPROVEMENT PROGRAM (LID)**

STEP 1: Receive Direction from Property Owners for Specific Project

- Owners in favor of construction
- Owners in opposition of construction
- Owners are neutral

STEP 2: Staff evaluation of existing conditions (and feasibility check)

- Right of way (see note 1)
- Stormwater collection/treatment (see note 2)
- Sidewalk connectivity
- Topography (see note 3)
- ADA Compliance
- Adjacent properties concurrence (majority required)

STEP 3: Financing

- Survey grades
- Provide a cost estimate to abutting property owners
- Set up the LID with property owners

COUNCIL CONSIDERATIONS:

The LID approach would not require a new funding mechanism or new code authority. It could reach any feasible sidewalk in town. Only beneficiaries would pay. However property owners would shoulder the full cost of constructing the new sidewalk. The Engineering Department would be able to undertake the initial project scope, surveying, and cost estimate in house. The "new" aspect of this program would be an aggressive outreach and communications effort to make property owners aware of the LID option.

¹ Does the selected location for sidewalks have enough right of way width? Acquiring right of way is very costly and could expend most funds without being able to construct sidewalk.

² Construct stormwater facilities for treatment and detention or use pervious concrete? The trigger for requiring stormwater treatment is 500 SF of new impervious area. Pervious concrete is a cheaper but requires routine cleaning to maintain porosity.

³ Many streets in Milwaukie would require retaining walls to be built and driveways reconstructed. This would reduce the amount of sidewalks that could be constructed with the amount of funding available.

**CITYWIDE
SIDEWALK IMPROVEMENT PROGRAM**

STEP 1: Receive Input on Sidewalk Needs Generally from Citizens

- Open Houses and Public Meetings
- Surveys (Online, Mailers, etc.)
- City Council

STEP 2: Staff Evaluation of Projects

- Transportation System Plan (TSP) Pedestrian Master Plan
- Safer Routes to School
- Street Classification
- Transit Routes
- Public Destinations (Library, Shopping, Hospital, etc.)
- Current Right of Way
- In-Fill
- Existing Conditions

STEP 3. City Council Selection and Adoption of Funding Mechanism

- Bonds
- New Utility Fee
- Amend SSMP funding formulas

STEP 4: City Council Selection of Projects

- "Right-size" based on funding availability
- Equity between neighborhoods
- Prior Policy (i.e. TSP Ped Master Plan)

COUNCIL CONSIDERATIONS:

Under this approach, all citizens shoulder the burden for funding select projects. A new funding mechanism is required. The adopted TSP Pedestrian Master Plan is a likely basis for priority projects, which includes 50 pre-identified projects. The role of staff, NDAs and Council would need to be carefully constructed then carried out by council authorization. The WSMP would be instructive with lessons learned.

EXHIBIT

10/16/12 WJS

10/16/12 WS

To: Mayor and City Council

Through: Bill Monahan, City Manager

From: Katie Newell, Library Director
Scott Churchill, Library Expansion Task Force Chair

Subject: LETF Progress Report

Date: October 16, 2012

ACTION REQUESTED

None. For information only.

BACKGROUND

At its February 1, 2011 Work Session meeting, City Council met with the Ledding Library Board and discussed the space needs of the library as well as the process necessary to evaluate options for enlarging the Library. The availability of \$1 million of capital funds from the Library District of Clackamas County in 2012 requires the City undertake an analysis of how to use the funds and develop a plan to address space needs. The Council and Board discussion focused on the benefits of creating a task force to stimulate a broad based discussion of the community need for library facilities, the options available and the process needed to pursue locations and funding.

At its March 15, 2011 meeting, the Milwaukie City Council authorized the creation of the Library Expansion Task Force (LETF) to look into the issues surrounding the expansion of the Ledding Library. The first meeting of LETF was June 23, 2011, with representatives from City Council, Library Board, Library Foundation, Planning Commission, Budget Commission, Neighborhoods, Business, Library staff. (List attached)

The LETF developed a survey to ask the community how it used the Library. It was available on-line, as well as handed out at the Library, local stores (Albertson's and Safeway) and Sunday Market. Overall, there were 1,057 responses (see attached). 83.3% wanted to keep the Library at its current location.

The LETF developed a preliminary design program that supported the need of an expansion.

RECOMMENDATION

At this time, the Task Force would like to recommend to Council to hire an outside consultant to complete an unbiased needs assessment/programming plan for the Ledding Library.

FISCAL IMPACTS

None to the City. \$35,000 has been set aside from the Library Endowment to be used for the needs assessment.

WORK LOAD IMPACTS

Library Director Katie Newell will be involved in any plans to move forward.

ALTERNATIVES

Take no action.

Library Expansion Task Force Members

Group represented	Name
City Council	Greg Chaimov
Library Board	Melissa Perkins
Library Board	Tom Hogan
Library Foundation	Ed Zumwalt
Planning Commission	Lisa Batey
Budget Commission	Jon Stoll
Neighborhood – East	Paul Klein
Neighborhood – West	Scott Churchill
Citizen-at-large – East	Kathi Schroeder
Citizen-at-large – West	Christie Schaeffer
Business representative	Fred Bruderlin
Library Director	Katie Newell
Library Circulation Supervisor	Nancy Wittig
City Manager	Bill Monahan
Public Affairs Coordinator	Grady Wheeler

Leading Library Expansion Survey - Introductory Survey



1. How often do you use the library and its services?

		Response Percent	Response Count
Two or more times a week		29.7%	314
Once a week		36.3%	384
Once a month		22.8%	241
Once a Year		5.9%	62
Less than once a year		5.3%	56
		answered question	1,057
		skipped question	0

2. When you use the library, what resources do you use most often?

		Response Percent	Response Count
Books		74.6%	775
Audiovisual materials, CDs, DVDs, games, etc.		40.4%	420
Internet access through library computers		31.2%	324
Children's library		22.6%	235
Library sponsored programs such as poetry readings, story time, concerts		10.4%	108
On site use of library materials		14.3%	149
		answered question	1,039
		skipped question	18



3. If the city chose to expand the library facilities where would you like that expansion to take place?

		Response Percent	Response Count
At the current Ledding Library location		83.4%	830
At a location in another Milwaukie neighborhood		16.6%	165
answered question			995
skipped question			62

4. For the resources you use most often would you prefer to access those services at the current library location or at other locations?

		Response Percent	Response Count
At the current Ledding Library location		88.2%	897
At a location in another Milwaukie neighborhood		11.8%	120
answered question			1,017
skipped question			40





5. When you choose to check out a book to read, do you prefer to:

		Response Percent	Response Count
Check out a book from the library shelf		95.6%	968
Download an e-book from the on-line library		7.2%	73
answered question			1,013
skipped question			44

6. When you are doing research on line, do you access that information through one of the library internet portals or through other internet search engines such as Google, YouTube, or Bing?

		Response Percent	Response Count
Online through the library portal (LINCC online resources)		33.3%	303
Online through other internet search engines		72.0%	656
answered question			911
skipped question			146

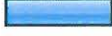
7. How do you prefer to get news about the library expansion study?

		Response Percent	Response Count
Milwaukie Pilot newsletter		42.6%	416
Email update		33.6%	328
US Postal mail		18.2%	178
City website		16.3%	159
Community booth at the Farmer's Market		10.8%	106
Other (please specify)		4.1%	40
answered question			977
skipped question			80

8. If you selected "Email update" in Question 7, please enter your email address:

	Response Count
	296
answered question	296
skipped question	761

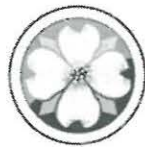

MILWAUKIE
Dogwood City of the West

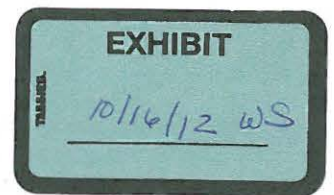

Memorandum

To: City Council

From: Kenny Asher, Community Development/Public Works Director
Steve Butler, Planning Director
JoAnn Herrigel, Community Services Director

CC: Bill Monahan, City Manager
Grady Wheeler, Public Information Coordinator

Date: October 16, 2012

Re: CD & Planning Active Projects: City Council Update

Community Development

- Dark Horse Relocation/Real Estate Study
- Light Rail Project Management
- South Downtown Implementation/Adams St. Connector
- Light Rail Station Building
- Kellogg for Coho Initiative
- Bertman House Lease

CD/Engineering

- Quiet Zone Implementation
- **Citywide Sidewalk Improvement Program (exploring)**
- **Stormwater Master Plan**

CD/Community Services

- Riverfront Park
- Other Parks
- Public/Government Access

Planning

- **Residential Development Standards**
- **Annexations**
- Land Use and Development Review
- Downtown Facade Improvement Program
- Neighborhood Main Streets
- **Tacoma Station Area Planning**
- Zoning Code Enforcement
- Parks Plans
- Transportation System Plan
- Metro 2035 Population and Employment Forecast
- Downtown Plan and Code Refresh
- 'Low Hanging Fruit' Code Amendments

Community Development

Citywide Sidewalk Improvement Program

See handout.

Stormwater Master Plan

Consultants are evaluating the stormwater model results which show localized flooding, which will be addressed through a preliminary CIP project list. A rate study can then estimate the level of funding needed to complete the CIP projects. An open house is tentatively scheduled for the first part of December. The Stormwater Master Plan will be presented to the CUAB in January, the Planning Commission in late January/early February, and the City Council in March 2013.

Riverfront Park

JoAnn to provide update during tonight's work session.

Public/Government Access

As requested by Council, staff has developed and issued a Request for Proposals for Public and Government Access services. Proposals are due to the City on Nov 2 and staff will bring a recommendation to Council for their consideration on November 20th.

Planning**Residential Development Standards**

With the standards having been adopted by the City Council, staff is working on preparing informational handouts for the public and updating relevant checklists/application forms.

Annexations

The application deadline for the final set of assisted annexations is November 30, 2012. Per the City Council's Resolution, this will be the last assisted group the city will process. Two applications for expedited annexations are on tonight's regular session agenda for Council action.

Tacoma Station Area Planning

On October 25, 1:30-3:30 p.m., an expert panel will meet to discuss what they see as the opportunities and challenges for future development within the station area. Work sessions on the project for the Planning Commission and City Council will occur in December.

Access Description	Purpose	Project Impact	Cost to City	WES Impact	Cost to WES
1. New access south of Kellogg (with turn lanes and remote signal activation for large vehicles)	This option maintains the original park programming by facilitating the creation of continuous open space and the public plaza while accomodating a new boat ramp and parking lot. It also develops a singular entrance to the site eliminating traffic congestion and pedestrian auto conflicts created by multiple entries.	None	No new costs	Access issues, circulation issues, ROW issues, operational impacts, maintenance costs, travel time costs.	<div data-bbox="2747 278 3039 459" style="border: 1px solid black; padding: 5px; text-align: center;"> EXHIBIT 10/16/12 WS </div>
2. New access south of Kellogg allowing right in/ right out only (with a median blocking north bound turns out of the park/plant)	This option addresses safety concerns raised by WES by eliminating a double merge south of Washington St. and eliminating a north bound left turn into the site.	Minor revisions to park entry and McLoughlin Blvd.	Redesign of McLoughlin and revisions to park entry - \$2,000	Operations, travel time costs, equipment costs, safety issues	
3. Access at Washington St. with full light for both park and plant access. (Existing entry)	This option eliminates the proposed access south of Kellogg Creek and maintains a signalized access point for WES access.	Park redesign would include; reduction in open space, reduction of overall plaza size, relocation of restroom building, reduction in play area, reduced boat trailer parking, ineffecient auto and pedestrian circulation, auto/truck and pedestrian conflicts at Washington St. intersection.	Re-engagment of stakeholders - \$50,000 Park redesign - \$530,000 Revise traffic study - \$10,000 Revise/resubmit land-use application - \$60,000 Revise/resubmit of USAC Joint Permit Application - \$100,000 TOTAL \$750,000	Possible conflicts with parked vehicles, possible blocking of access aisles by cars/boats	
4. Access at Jefferson and Washington: Jefferson St. right in/right out for park use only, Washington St. with a full light plant trucks only.	This option addresses potential conflicts created by Option 3 by separating plant vehicles from private vehicles.	Park redesign would include; relocation of plaza and great lawn, reduction in open space, reduction of overall plaza size, relocation of restroom building, elimination of amphitheater, elimination of play area, reduced boat trailer parking, ineffecient auto and pedestrian circulation, vehicle/pedestrian conflicts at	Re-engagment of stakeholders - \$50,000 Park redesign - \$650,000 reivse traffic study - \$10,000 Revise/resubmit land-use application - \$80,000 Revise/resubmit of USAC Joint Permit Application - \$130,000 TOTAL \$920,000		

**MILWAUKIE CITY COUNCIL
WORK SESSION
OCTOBER 16, 2012**

MILWAUKIE CITY HALL

Conference Room
10722 SE Main Street

A light dinner will be served

WORK SESSION – 5:00 P.M.

	<u>Presenter</u>	<u>Page #</u>
1. 5:00 p.m. City Manager's Report	Bill Monahan	
2. 5:30 p.m. Audit Committee Composition	Casey Camors	1
3. 5:45 p.m. Library Expansion Task Force	Katie Newell and Task Force Members	
4. 6:10 p.m. Riverfront Park Access Option Review	JoAnn Herrigel	3
5. 6:30 p.m. Adjourn		

EXECUTIVE SESSION 6:30 P.M.

The City Council will meet in executive session immediately following adjournment of the work session pursuant to ORS 192.660(2)(h) to consult with legal counsel concerning legal rights and duties regarding current litigation or litigation likely to be filed.

Information

Executive Session: All discussions are confidential and those present may disclose nothing from the Session. Representatives of the news media are allowed to attend Executive Sessions as provided by ORS 192.660(3) but must not disclose any information discussed. No Executive Session may be held for the purpose of taking any final action or making any final decision. Executive Sessions are closed to the public.

Public Notice

- The Council may vote in work session on non-legislative issues.
- The time listed for each discussion item is approximate. The actual time at which each item is considered may change due to the length of time devoted to the one previous to it.
- The Council requests that all pagers and cell phones be either set on silent mode or turned off during the meeting.
- The City of Milwaukie is committed to providing equal access to information and public meetings per the Americans with Disabilities (ADA). If you need special accommodations, please call 503.786.7502 or email ocr@ci.milwaukie.or.us at least 48 hours prior to the meeting.



To: Mayor and City Council
Through: Bill Monahan, City Manager
From: Casey Camors, Finance Director
Date: October 16, 2012
Subject: Audit Committee Composition Clarification

ACTION REQUESTED

Clarify the Council's desired composition of the City of Milwaukie Audit Committee, specifically regarding the citizen member position.

HISTORY OF PRIOR ACTIONS AND DISCUSSIONS

July 2012: Council adopted resolution 43-2012 creating and audit subcommittee of the Milwaukie City Council

Council and staff have had multiple discussions regarding the audit committee since, mostly surrounding the question of if we should focus on getting a CPA as an audit subcommittee member.

BACKGROUND

Within the adopted resolution (43-2012), it's stated that the Audit Committee will "consist of two members of the City Council appointed by the Council for two-year staggered terms and one citizen member with an interest in City government financial operations, preferably a Certified Public Accountant residing within City limits, also for a two-year term."

We wish to clarify the desired composition of the Audit Committee and have the following questions:

- The resolution states that the subcommittee will have "one citizen member with an interest in City government financial operations, preferably a Certified Public Accountant residing within City Limits." Our research indicates that there are 6 CPA's residing within City limits and 9 CPA's residing outside of City limits but who have a Milwaukie address, offering a very small pool of potential CPA committee members. Would the Council prefer to have a CPA or is the priority to have someone that lives within City limits.

- The resolution states that we will have two Council members, but it is our understanding that we prefer one Council member and one Budget Committee member to serve on the committee. Please confirm that that is the case and we will prepare an amended resolution.

CONCURRENCE

N/A

FISCAL IMPACT

N/A

WORK LOAD IMPACTS

N/A

ALTERNATIVES

N/A

ATTACHMENTS

1. N/A



Agenda Item: WS.4
Riverfront Park Access
Meeting Date:10/16/12

COUNCIL AGENDA ITEM SUMMARY

Issue/Agenda Title: Riverfront Park Access

Prepared By: JoAnn Herrigel, Community Services Director

Dept. Head Approval: JoAnn Herrigel, Community Services Director

City Manager Approval:

Reviewed by City Manager:

ISSUE BEFORE THE COUNCIL

Provide staff with guidance regarding which Riverfront Park vehicle access option(s) to pursue.

STAFF RECOMMENDATION

Staff is looking for Council's input before pursuing an option.

KEY FACTS & INFORMATION SUMMARY

The current design for Milwaukie Riverfront Park proposes to close the west side vehicle accesses at Washington and Jefferson Streets and open a new access south of Kellogg Creek. This new access and associated landscape changes fall on the Kellogg Wastewater Plant property, owned by Clackamas County. Staff from Water Environment Services (WES) and the City are developing a matrix comparing the impacts of various access options which will be presented at the October 16 work session.

OTHER ALTERNATIVES CONSIDERED

Options being considered are presented in this staff report.

CITY COUNCIL GOALS

This item supports Council's goal to continue development of Riverfront Park.

ATTACHMENT LIST

None.

FISCAL NOTES

Depending on which option is chosen, there may be costs to the City for modifying and permitting the park design.



To: Mayor and City Council

Through: Bill Monahan, City Manager

From: JoAnn Herrigel, Community Services Director

Subject: Riverfront Park Access

Date: October 16, 2012

ACTION REQUESTED

Provide staff with guidance regarding which Riverfront Park vehicle access option(s) to pursue.

HISTORY OF PRIOR ACTIONS AND DISCUSSIONS

September 2012 – staff provided Council with an update on Riverfront access

BACKGROUND

The current design for Milwaukie Riverfront Park proposes to close the west side vehicle accesses at Washington and Jefferson Streets and open a new access south of Kellogg Creek. This new access and associated landscape changes fall on the Kellogg Wastewater Plant property, owned by Clackamas County. City staff has been in discussions with staff and elected officials from Clackamas County and Water Environment Services (WES) for several years about the design of this access and the impact the design has on the plant's administration building and wastewater truck access to McLoughlin Blvd.

The proposed access, south of Kellogg Creek has no traffic light. The Oregon Department of Transportation (ODOT) has stated that the new access would not "warrant" a light. In order to warrant a light, the access would have to facilitate 75 vehicles an hour, and the proposed park and wastewater plant do not generate this level of traffic. In order to facilitate vehicle ingress and egress from the park and plant the design does include a turn lane for north bound vehicles turning into the site and a harbor lane for vehicle leaving the site and going north. In addition, the design team has explored with WES and ODOT the idea of installing a remote sensor system that

would trigger a longer red light at Washington to allow longer traffic gaps for vehicles leaving the site.

At meetings held in April and August of 2012, staff from Water Environment Services expressed continued concerns about the safety of their trucks turning north onto McLoughlin Blvd. WES staff noted that re-directing their trucks so that they go right in and right out of the new access would be costly and may cause public perception issues.

In September, staff from WES and the City agreed to develop a matrix comparing various access options and the actual cost to the City and WES for each option. Data gathering for this matrix is underway and results will be presented to Council at the October 16 Council work session.

The options currently under review include:

- 1) **The current design** - with access south of Kellogg Creek with turn lanes and sensor system
- 2) **Right in/Right Out at new access** - with a median blocking northbound turns, forcing right in and right out access for all vehicles
- 3) **Washington Street access** - park and plant users would both use existing Washington Street access with a full traffic light
- 4) **Park access at Jefferson and plant access at Washington** - with Jefferson access for park users being right in and right out (as it is today) and WES trucks using Washington Street with the existing full light

CONCURRENCE

The Community Development Director participated in the latest discussion with WES and County engineers and supports the development of the matrix for Council's review.

FISCAL IMPACT

Depending on which option is chosen, there may be costs to the City for modifying and permitting the park design.

WORK LOAD IMPACTS

The Community Services Director currently spends about 15 hours a week on Riverfront Park related tasks. Modifying the current design would increase time spent on this project to at least 20 hours a week during redesign and permitting.

ALTERNATIVES

Access options are described above.

ATTACHMENTS

1. Access Options

1) Current Design

Attachment 1

Milwaukie Riverfront Park Access Options

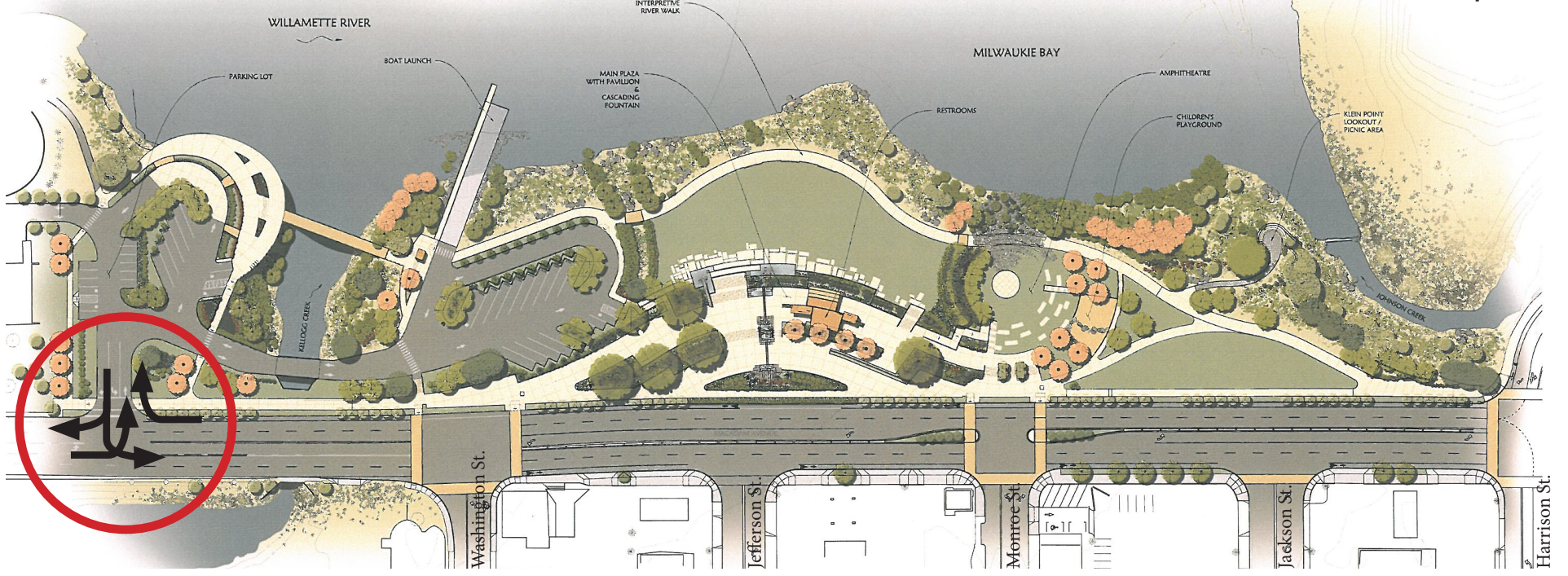

2) Right in/Right out at new access

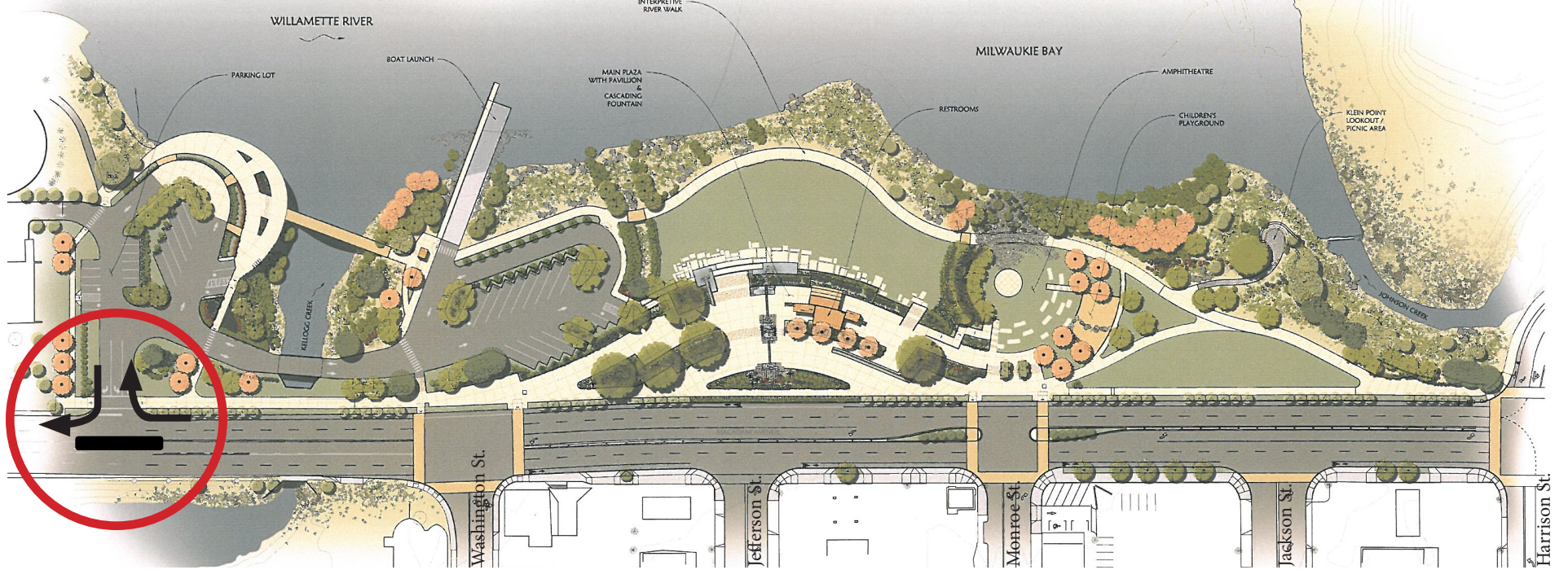

3) Washington Street access

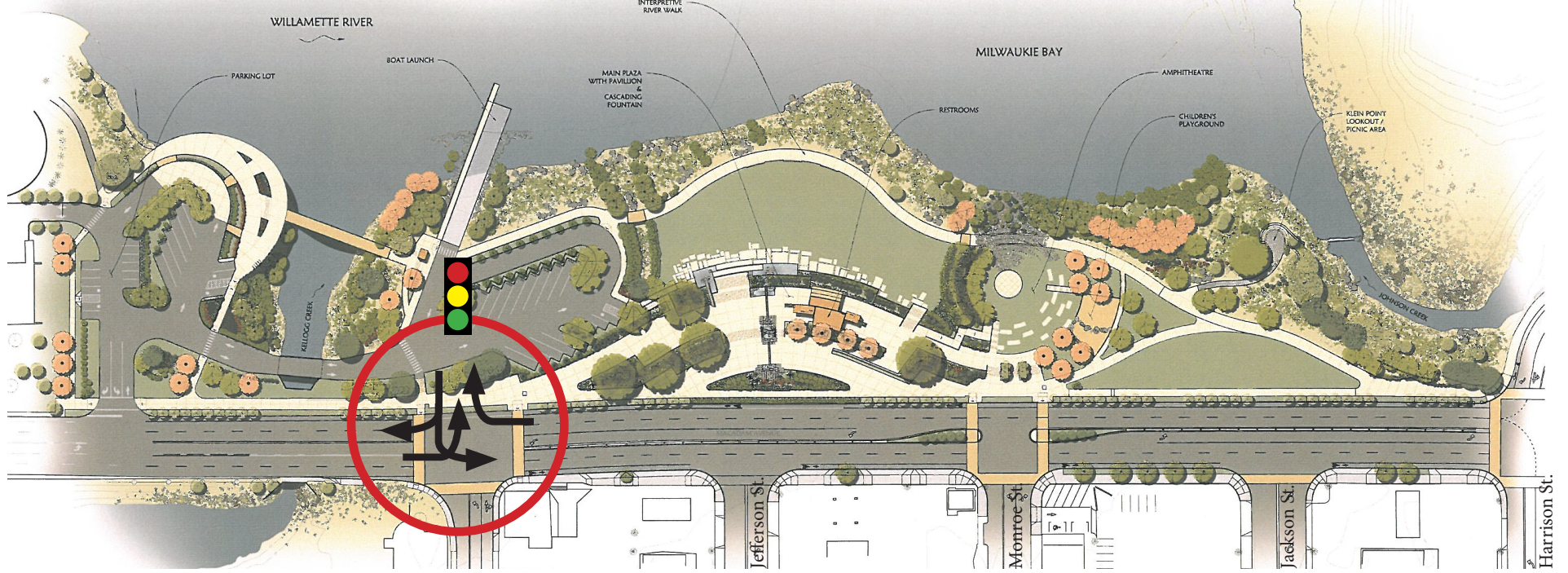

4) Park access at Jefferson and plant access at Washington

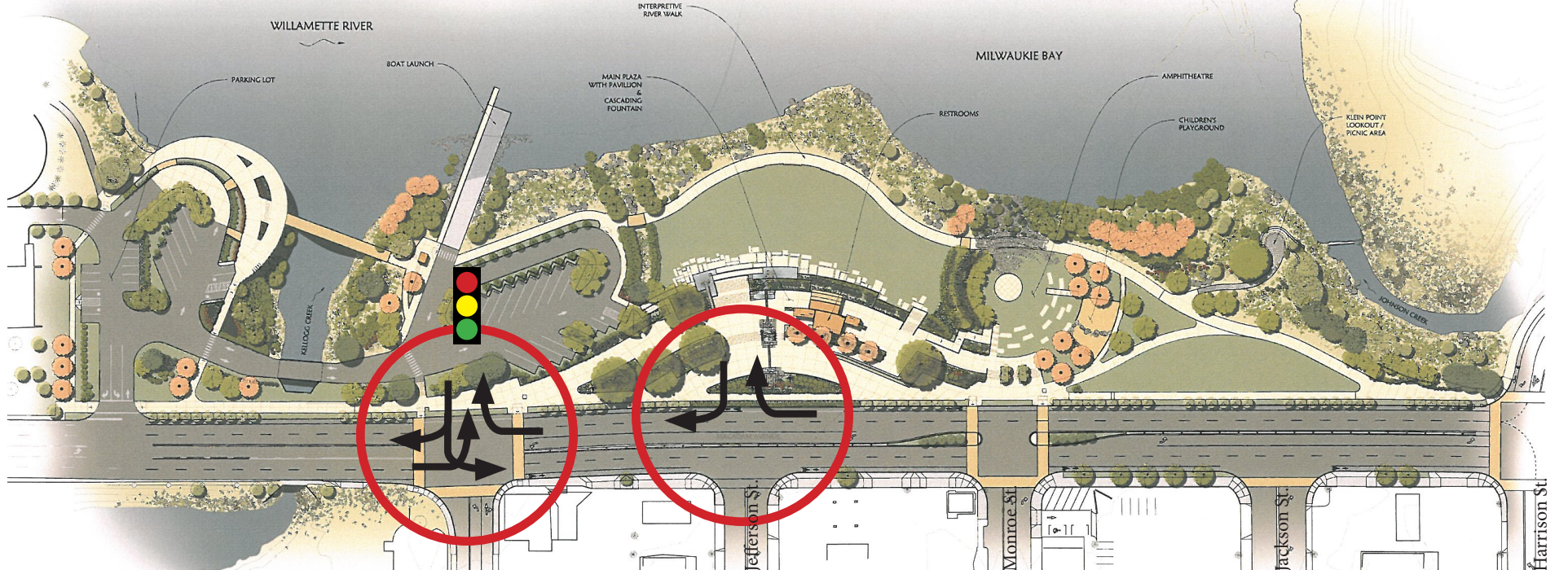

Existing Condition

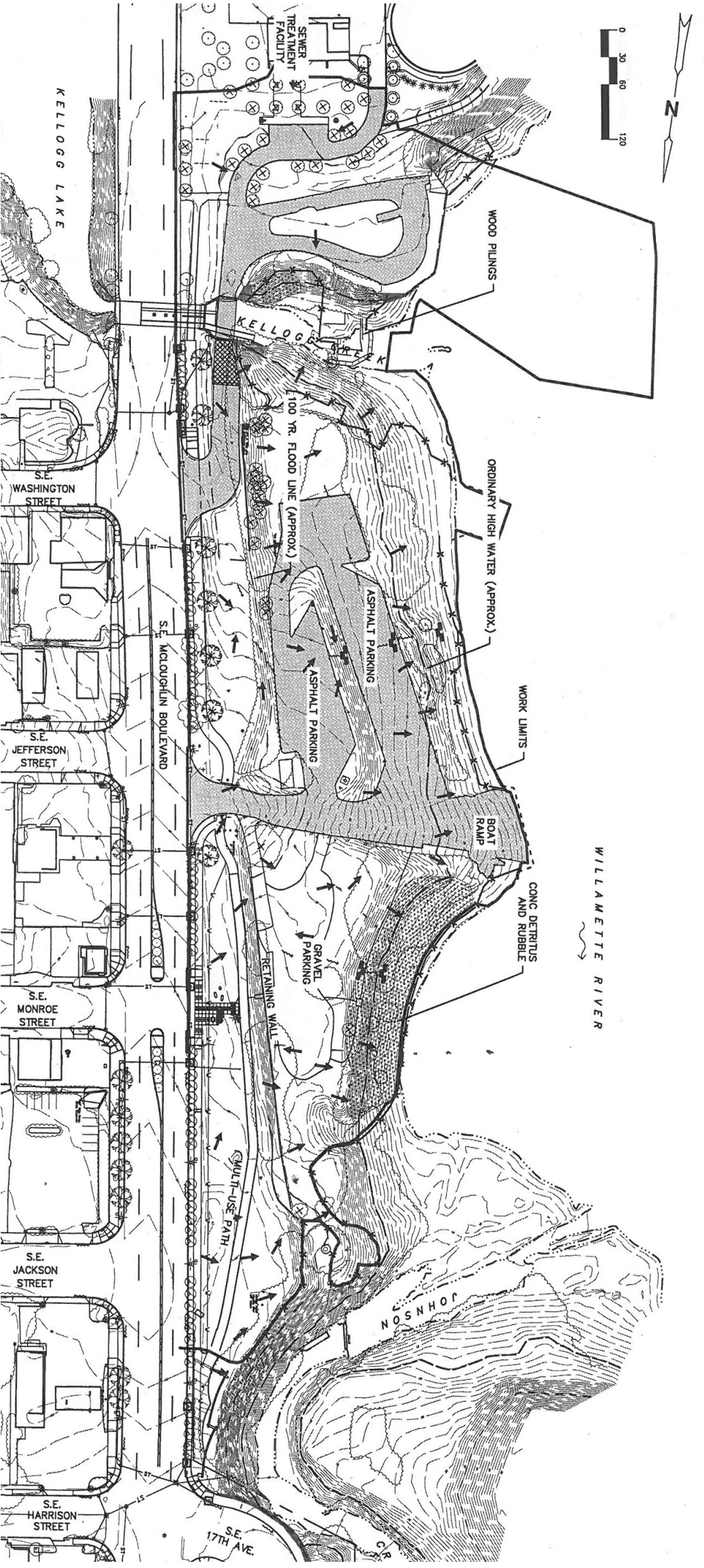

Current Proposed Design

