

**CITY OF MILWAUKIE
CITY COUNCIL MEETING
DECEMBER 1, 2009**

CALL TO ORDER

Mayor Ferguson called the 2067th meeting of the Milwaukie City Council to order at p.m. in the City Hall Council Chambers.

Present: Mayor Jeremy Ferguson, Council President Greg Chaimov, and Councilors Deborah Barnes, Joe Loomis, and Susan Stone

Staff present: City Attorney Bill Monahan, Engineering Director Gary Parkin, Community Services Director JoAnn Herrigel, and Resource and Economic Development Specialist Alex Campbell

PLEDGE OF ALLEGIANCE**PROCLAMATIONS, COMMENDATION, SPECIAL REPORTS AND AWARDS****2009 Christmas Ships Proclamation**

Councilor Barnes read a proclamation naming December 9, 2009 through December 20, 2009 as *Christmas Ships Parade Weeks* in the City of Milwaukie.

CONSENT AGENDA

It was moved by Councilor Stone and seconded by Councilor Barnes to approve the consent agenda as presented.

- A. **Resolution 77-2009: A Resolution of the City Council of the City of Milwaukie, Oregon, Amending the Intergovernmental Agreement (IGA) with the Metropolitan Area Communication Commission (MACC) to Extend the Term; and**
- B. **OLCC Application for King Curry Thai Cuisine, 4208 SE King Road, New Outlet**

Motion passed with the following vote:

AUDIENCE PARTICIPATION

None.

PUBLIC HEARING

None scheduled.

OTHER BUSINESS**A. Contract Award for the Construction of the Waste Water Sewer Collection System in the Northeast Sewer Extension Project Area – Resolution**

Mr. Parkin discussed the background of the Northeast Sewer Extension (NESE) project. When speaking with residents staff heard consistently that people were concerned about the expense. He outlined some of the cost savings that had come about as the project rolled out including favorable interest rates on the Clean Water State Revolving Fund Loan, stimulus funds, and the bidding climate. The project

CITY COUNCIL REGULAR SESSION – DECEMBER 1, 2009

APPROVED MINUTES

Page 1 of 3

estimate was \$3.8 million, and the bids came in at approximately \$2.6 million. This allowed the City to supply sewer to those desiring it at a much lower cost than anticipated. The collection system would serve 261 properties and consist of 3 miles of sewer main, 4,800 feet of service laterals, 85 manholes, and a pump station.

Councilor Stone was curious about the company doing the work and asked if K and R Plumbing Construction had done work for the City in the past.

Mr. Parkin replied it had not, but he had checked references. He noted 3 of the 7 bids received were relatively close. Staff will scrutinize the work and felt comfortable the contractor was capable of doing the work.

Councilor Stone was pleased the connection fee would be lower than originally thought and less than \$4,000.

Mayor Ferguson asked if staff thought property owners would connect sooner than anticipated because of the better rate.

Mr. Campbell replied the lower cost as a result of stimulus funds and the bid environment would certainly allow more people to take advantage of the opportunity. Staff will propose for Council approval a 10-year payment plan at 0% interest if the connection was made in the first 2 years of the program.

Councilor Barnes wanted to make sure there was a good public relations outreach so people could connect as soon as possible.

Mayor Ferguson agreed with that comment because there were already a lot of hard feelings in that area. It would be important to let residents know the City was passing the savings along to them.

It was moved by Councilor Barnes and seconded by Councilor Stone to adopt the resolution approving the contract award for the construction of the North East Sewer Extension Project and authorizing the City Manager to sign a contract with K & R Plumbing Construction in the amount of \$2,653,257.05. Motion passed with the following vote: Councilors Stone, Loomis, Barnes, and Chaimov and Mayor Ferguson voting "aye." [5:0]

RESOLUTION NO. 78-2009:

A RESOLUTION OF THE CITY COUNCIL OF THE CITY OF MILWAUKIE, OREGON, APPROVING THE CONTRACT AWARD FOR THE CONSTRUCTION OF THE NORTHEAST SEWER EXTENSION PROJECT (SERVING DUAL INTEREST AREA "A")

B. Council Reports

Councilor Chaimov announced the Celebration of Life for Shirley Brown on December 5 and acknowledged her work on the Library Board and Friends of the Library.

Councilor Stone attended the Light Rail Steering Committee meeting where there was a decision reached on the bridge height. She briefly reviewed the project schedule.

Councilor Barnes attended the State of the City address with Councilor Chaimov and will attend the North Clackamas School Board meeting to accept a grant from the North Clackamas Education Foundation.

Mayor Ferguson gave the State of the City address to the Milwaukie Rotary. He announced the Umbrella Parade and City Hall Tree Lighting on December 5 and the monthly light rail meeting where traffic studies would be discussed.

ADJOURNMENT

It was moved by Councilor Chaimov and seconded by Councilor Barnes to adjourn the meeting. Motion passed with the following vote: Councilors Stone, Loomis, Barnes, and Chaimov and Mayor Ferguson voting "aye." [4:0]

Mayor Ferguson adjourned the regular session at 7:21 p.m.

Pat DuVal

Pat DuVal, Recorder

REGULAR SESSION

AGENDA

MILWAUKIE CITY COUNCIL DECEMBER 1, 2009

MILWAUKIE CITY HALL
10722 SE Main Street

2067th MEETING

REGULAR SESSION – 7:00 p.m.

- | | Page # |
|---|--------|
| 1. CALL TO ORDER
Pledge of Allegiance | |
| 2. PROCLAMATIONS, COMMENDATIONS, SPECIAL REPORTS, AND AWARDS | 1 |
| A. 2009 Christmas Ships Proclamation
Presenter: Mayor Ferguson | 2 |
| 3. CONSENT AGENDA <i>(These items are considered to be routine, and therefore, will not be allotted Council discussion time on the agenda. The items may be passed by the Council in one blanket motion. Any Council member may remove an item from the “Consent” portion of the agenda for discussion or questions by requesting such action prior to consideration of that portion of the agenda.)</i> | 3 |
| A. Metropolitan Area Communications Commission (MACC)
Intergovernmental Agreement Extension – Resolution | 4 |
| B. OLCC Application for King Curry Thai Cuisine, 4208 SE King Road, New Outlet | 8 |
| 4. AUDIENCE PARTICIPATION <i>(The Presiding Officer will call for statements from citizens regarding issues relating to the City. Pursuant to Section 2.04.140, Milwaukie Municipal Code, only issues that are “not on the agenda” may be raised. In addition, issues that await a Council decision and for which the record is closed may not be discussed. Persons wishing to address the Council shall first complete a comment card and return it to the City Recorder. Pursuant to Section 2.04.360, Milwaukie Municipal Code, “all remarks shall be directed to the whole Council, and the Presiding Officer may limit comments or refuse recognition if the remarks become irrelevant, repetitious, personal, impertinent, or slanderous.” The Presiding Officer may limit the time permitted for presentations and may request that a spokesperson be selected for a group of persons wishing to speak.)</i> | |
| 5. PUBLIC HEARING <i>(Public Comment will be allowed on items appearing on this portion of the agenda following a brief staff report presenting the item and action requested. The Mayor may limit testimony.)</i> | |
| A. None Scheduled | |

- 6. OTHER BUSINESS** *(These items will be presented individually by staff or other appropriate individuals. A synopsis of each item together with a brief statement of the action being requested shall be made by those appearing on behalf of an agenda item.)* **9**
- A. Contract Award for the Construction of the Waste Water Sewer Collection System in the Northeast Sewer Extension Project Area – Resolution** **10**
Presenter: Gary Parkin, Engineering Director
- B. Council Reports**

7. INFORMATION

8. ADJOURNMENT

Public Information

- Executive Session: The Milwaukie City Council may meet in executive session pursuant to ORS 192.660.
- All discussions are confidential and those present may disclose nothing from the Session. Representatives of the news media are allowed to attend Executive Sessions as provided by ORS 192.660(3) but must not disclose any information discussed. No Executive Session may be held for the purpose of taking any final action or making any final decision. Executive Sessions are closed to the public.
- The City of Milwaukie is committed to providing equal access to information and public meetings per the Americans with Disabilities (ADA). If you need special accommodations, please call 503.786.7502 or email ocr@ci.milwaukie.or.us at least 48 hours prior to the meeting.
- The Council requests that all pagers and cell phones be either set on silent mode or turned off during the meeting.

2.

PROCLAMATIONS,
COMMENDATIONS,
SPECIAL REPORTS,
AND AWARDS

PROCLAMATION

WHEREAS, commencing December 9, 2009 and ending on December 20, 2009, with a special performance in Camas, Washington on December 5, 2009, the Christmas Ship Parade will be sailing the Columbia and Willamette Rivers, and;

WHEREAS, 2009 marks the fifty-fifth year that the annual Christmas Ship Parade has made its voyages part of the Portland Metro area's annual holiday tradition; and

WHEREAS, the Columbia and Willamette River Christmas Ship Fleets average between fifty-five and sixty boats; and

WHEREAS, the boat owners who participate are volunteers who donate their time, resources, and money to continue this holiday tradition enjoyed by generations of families; and

WHEREAS, the Willamette Fleet will visit the City of Milwaukie on December 9, 2009, December 11, 2009, December 14, 2009, December 16, 2009, December 18, 2009, and December 19, 2009; and

WHEREAS, the unique characteristics of the Milwaukie riverfront permit those wishing to view the Christmas Ship Fleet to enjoy unparalleled views of the boats; and

WHEREAS, the response by those viewing the ships at the Milwaukie riverfront is heard and appreciated by the volunteers who give of their time and resources; and

WHEREAS, the City of Milwaukie is deeply honored to serve as a destination for the Christmas Ships Parade and expresses its appreciation to the volunteers who continue this tradition year after year.

NOW, THEREFORE, I, Jeremy Ferguson, proclaim December 9, 2009 through December 20, 2009 as

CHRISTMAS SHIPS PARADE WEEKS

in the City of Milwaukie and encourage citizens to greet the ships and their owners as they arrive each night at the Milwaukie Boat Ramp and to experience this very special holiday tradition so enjoyed by generations of families.

IN WITNESS WHEREOF, I hereunto set my hand this
1st Day of December, 2009

ATTEST:

Jeremy Ferguson, Mayor

Pat Duval, City Recorder

3.

CONSENT AGENDA



To: Mayor and City Council
Through: Mike Swanson, City Manager
From: JoAnn Herrigel, Community Services Director
Subject: MACC IGA Amendment
Date: November 18, 2009

Action Requested

Approve a resolution amending the intergovernmental agreement (IGA) with the Metropolitan Area Communication Commission (MACC) to extend the term of the agreement to December 31, 2012.

History of Prior Actions and Discussions

June 2000 – Council approves a resolution authorizing staff to enter into a one year IGA with MACC for the administration of the City’s cable franchise (at that time, with AT+T)

June 2001 - Council approves a resolution renewing the IGA with MACC via amendment

June 18, 2002 - Council approves a resolution renewing the IGA with MACC and extending term for three years

June 9, 2005 - Council approves a resolution renewing the IGA with MACC and extending term for three years

August 15, 2006 – Council approves a resolution extending the IGA term to December 31, 2009 and decreasing MACC’s compensation from 28% to 23% of annual franchise revenue.

Background

Since 2000, MACC has administered Milwaukie's cable contract. For this work, the City makes an annual payment to MACC of twenty-three percent (23% or, about \$45,000) of its franchise fees. MACC's services to the City include but are not limited to:

- Day to day customer response regarding technical or billing problems with cable service.
- Financial auditing of franchise and Public, Education and Government (PEG) and Institutional Network (I Net) fee payments by MACC staff.
- Monitoring of Comcast contract obligations to Milwaukie and regulatory follow-up where necessary.
- Technical assistance with legal and financial issues regarding Comcast's relationship with and obligations to the City.
- In addition to assisting the City with cable-related issues, MACC staff has also provided valuable support and information regarding other City franchise issues related to Qwest and PGE and has provided telecommunication-related legislative monitoring during legislative sessions.

Staff recommends that the IGA with MACC be extended for another three year period. The City has benefited from our relationship with MACC and staff believes that extending this relationship is to the City's advantage.

The term of the Comcast franchise is now within three years of expiration and the City will need to begin the renegotiation process very soon. MACC has been, and will continue to, assist City staff with preparing for this negotiation. Over the next year or so, City staff plans to explore various options with MACC for this negotiation. Among these options is the possibility of the City joining MACC as a full member jurisdiction. (Currently we only contract with MACC, we are not a member of the Commission.) This would allow the City to receive the same services as other MACC members, including having MACC staff negotiate a single franchise to serve the City as one of its MACC members. MACC membership would also potentially decrease the City's payment to MACC to 20% of annual franchise fees. Staff will keep Council apprised of any discussions with MACC regarding membership status and negotiations with Comcast.

Concurrence

The City Manager and legal council concur with this staff recommendation.

Fiscal Impact

None. The City budget already accounts for payment of 23% of the City's franchise fees to MACC on an annual basis.

Council Staff Report – MACC IGA Agreement

Work Load Impacts

None. The extension of this agreement will maintain a level work load for the Community Services Director.

Alternatives

Do not approve the extension of the MACC IGA, requiring City staff to take on the responsibility of cable franchise administration.

Attachments

Resolution

RESOLUTION NO. _____

A RESOLUTION OF THE CITY COUNCIL OF THE CITY OF MILWAUKIE, OREGON, AMENDING THE INTERGOVERNMENTAL AGREEMENT (IGA) WITH THE METROPOLITAN AREA COMMUNICATION COMMISSION (MACC) TO EXTEND THE TERM OF THE AGREEMENT TO DECEMBER 31, 2012.

WHEREAS, the City signed an IGA with MACC in 2000 to administer cable television franchise services in the City; and

WHEREAS, the MACC IGA has been extended and amended from time to time since its inception; and

WHEREAS, the IGA will expire at the end of 2009 unless MACC and the City agree to extend the IGA;

NOW, THEREFORE, BE IT RESOLVED that the Intergovernmental Agreement (IGA) with the Metropolitan Area Communication Commission (MACC) is extended to December 31, 2012

Introduced and adopted by the City Council on December 1, 2009.

This resolution is effective on December 1, 2009.

Jeremy Ferguson, Mayor

ATTEST:

APPROVED AS TO FORM:
Jordan Schrader Ramis PC

Pat DuVal, City Recorder

City Attorney



To: Mayor Ferguson and Milwaukie City Council
Through: Mike Swanson, City Manager
From: Bob Jordan, Chief of Police
Date: November 16, 2009
Subject: **O.L.C.C. Application – King Curry Thai Cuisine – 4208 S.E. King Road**

Action Requested:

It is respectfully requested the Council approve the O.L.C.C. Application To Obtain A Liquor License from King Curry Thai Cuisine – 4208 S.E. King Road.

Background:

We have conducted a background investigation and find no reason to deny the request for liquor license.

6.
OTHER BUSINESS



To: Mayor and City Council

Through: Mike Swanson, City Manager
Kenneth Asher, Community Development and Public Works Director

From: Gary Parkin, Engineering Director

Subject: Contract Award for the construction of the Wastewater Sewer Collection System in the Northeast Sewer Extension Project Area

Date: November 24th for the December 1, 2009 Regular Session

Action Requested

Authorize the City Manager to sign a contract for the construction of the wastewater collection system as part of the North East Sewer Extension (NESE) project with K and R Plumbing Construction Co. Inc., in the amount of \$2,653,257.05 (see attachment 1 for resolution).

History of Prior Actions and Discussions

October 2009: Council approved an IGA with Clackamas County Development Agency regarding payment to the City of urban renewal contributions to the project, amounting to a \$3450 discount on project costs for developed properties in the North Clackamas Revitalization Area (Resolution 64-2009). Council approved a resolution requesting transfer of the jurisdiction of the street right-of-way in the area. (Resolution 66-2009).

September 2009: Council approved an updated Clean Water State Revolving Fund Loan Agreement for the NE Sewer Extension (NESE) project (Resolution 57-2009) and initiated annexation of the right-of-way in the NE Sewer Extension Project Area by resolution (Resolution 58-2009).

August 2009: Staff briefed Council on the status of the NESE Project and the need to annex the right-of-way in this area.

June 2009: Council approved the award of contract to Right-of-Way Associates Inc. for the easement and appraisal services within in the project area.

February 2009: Staff presented an update during Work Session to refresh Council on the NESE Project status. Council approved a resolution authorizing the City Manager to enter into a contract with Century West Engineering for the engineering services needed to provide a sewer system to the Dual Interest Area “A” (DIAA).

December 2008: Council approved a loan agreement for the Clean Water State Revolving Fund (CWSRF) loan to fund the extension of wastewater sewer to the Dual Interest Area “A” (Resolution 94-2008). (Later super-ceded by Res. 57-2009.)

October 2008: Council approved moving forward with the extension of wastewater sewer to the Dual Interest Area including; entering into an Intergovernmental Agreement (IGA) with Clackamas County for use of Century West Engineering services through a contract between Century West Engineering and Clackamas County; making application for a DEQ loan needed to accomplish the sewer extension; and moving forward with the public information needed for the project (Resolution 81-2008).

September 2008: Work session discussing the sewer extension project. Council requested additional information prior to acting.

May 2008: Work session to discuss the sewer extension project in light of City, County, State and intergovernmental requirements and policies. Staff presented information on relevant City and County policies, state law regarding annexation, and raised questions regarding service delivery and governance.

March 2008: Work session to discuss the need for, and timing of wastewater service to the unincorporated area adjacent to the northeastern border of the City. Working with Clackamas County, the City was beginning a public outreach effort to inform residents about the Dual Interest Area and determine public interest regarding connection to the City’s public wastewater sewer system.

September 2006: Staff briefed Council on State statute and City Comprehensive Plan policy regarding island annexations.

November 2002: Council directed the City Manager to sign a CDBG grant application to subsidize connection costs for low-income residents in the Dual Interest Area. This

proposal assumed a City project to extend service to the unsewered unincorporated area.

July 1990: Clackamas County Order No 90-726 established an Urban Growth Management Agreement (UGMA) in which the City and County agreed to coordinate the future delivery of services to the unincorporated areas of North Clackamas County. In the northern Dual Interest Area (DIA), or DIA, the agreement states: *“The City shall assume a lead role in providing urbanizing services.”*

Background

The requested contract bid award is the culmination of much effort. Constructing a wastewater sewer system in this area is a significant step forward in the implementation of City and County policy, state law and current best practices in the State of Oregon regarding the delivery of quality services. While the effort does not end with the construction award, the installation of the sewer system provides tangible evidence of the City’s commitment.

The construction bid package proposed for award will construct a sewer collection system to serve 261 of the 278 properties in the City’s future incorporated area known as Dual Interest Area “A”. The project installs just over 3 miles of sewer main, 4800 feet of service laterals, 85 manholes, and a pump station. Attachment 2 is a map showing the project. Additional graphics will be provided at the meeting.

A section of pipe in West Fork Ave will be constructed in a later phase by WES in accordance with an agreement with the City. The main will provide connection opportunity to 15 properties within the DIAA (south side of West Fork). The County plans on constructing the West Fork main next year, anticipating that it will be installed and available for use by September 2010.

This project provides a paving package to repave area streets. The majority of the street surface is in poor condition and not likely to hold up well to the construction work. In addition to trench restoration paving, the project allows for about 2 miles of full street width pavement overlay (2” thick).

The project generated a great deal of interest in the local contracting community. The project was advertised for bid on October 15, 2009 (and repeated October 20th). A mandatory pre-bid meeting was held October 23, 2009 with 25 people in attendance representing 20 contracting firms.

Seven contractors submitted bids for this project. The bid tabulation is shown as attachment 3. The bid recommended for award is rather low (69% of the engineer’s

estimate), however, two other bidders provided similar quotes. The low bidder expressed enthusiasm for the project and has demonstrated the ability to perform the work required. The City's engineering consultant for this project and the Department of Environmental Quality (DEQ) have reviewed the proposal and are satisfied that it is responsive and responsible and recommend award.

The proposed bid award would provide for lower than expected connection charges for the area residents. The average connection fee will be about \$7,000 (before NCRA discounts) compared to original estimates of over \$13,000. The lower cost is a result of the ARRA (Federal stimulus) grant included in the CWSRF loan and the low bid cost.

Clackamas County Department of Water Environment Services (WES) will be constructing the wastewater sewer system for the area adjacent to the City's project (east of Linwood Ave from King Road to Johnson Creek Blvd). They opened bids on November 18th (about 2 weeks after this project). Work will be coordinated to limit traffic issues as the WES work will close Linwood Avenue to through traffic for two to three months.

Traffic impacts from this project will be most significant when sewer main is being constructed in Wichita, Stanley and 55th Avenues. As work is done on these higher volume collector type streets, traffic will be limited to a single lane causing some travel delay. The majority of the work will occur on the local streets within the area. Work on these streets will not have a significant impact on the low traffic volumes that use the local streets.

Community Services will continue to lead communications with the property owners and residents of the project area. The next communication will provide an update on project costs based on the bid amount, lateral and system decommissioning cost information, financial program details, and construction schedule and impacts details. Efforts will begin early next year on developing a packet of information that will introduce and orient new residents to City services and programs.

Concurrence

The Engineering Department and Century West Engineering (the City's Engineering consultant) have evaluated the bids and recommend award to the low bidder. DEQ has reviewed the bids and approved the low bidder, K and R Plumbing, for award (see attachment 4).

Fiscal Impact

The contract will be paid from the 2009/10 NESE project budget. The source of funds is a CWSRF loan, approved by Council in September 2009, which includes 50% loan forgiveness (the ARRA/stimulus grant). Although loan repayment will be primarily funded by project Reimbursement District collections, the loan is guaranteed by the Wastewater fund. With the lower than expected project cost and total loan amount, the fund is accepting significantly less risk than previously assumed.

It is anticipated that Wastewater Capital and Reserve will make an inter-fund loan to the project fund of \$300,000 to cover easement purchases (which are not eligible expenses under the CWSRF loan/grant). In addition, the loan will provide adequate cash flow over the initial years of the reimbursement district as properties connect and until NCRA issues the bonds necessary to provide discounts. The internal loan repayment period is assumed to be 10 years.

Work Load Impacts

Engineering staff will manage the full-time construction inspection effort contracted to Century West Engineering. The workload was anticipated and is within current schedules.

Public Works Operations will incur some workload during the project's duration. The additional workload will be to attend weekly construction coordination meetings and respond to construction issues that will arise. The extra time burden is not expected to alter work plans significantly.

Alternatives

1. Don't award to the proposed contractor.
2. Delay award.

Staff strongly supports approval of this contract award. The alternatives would delay the project, likely result in cost increases, and put committed funds at risk.

Attachments

1. Resolution
2. Project Vicinity Map
3. Bid Tabulation
4. Letter from DEQ approving K and R Plumbing Constructing Inc

ATTACHMENT 1

RESOLUTION NO. _____

A RESOLUTION OF THE CITY COUNCIL OF THE CITY OF MILWAUKIE, OREGON, APPROVING THE CONTRACT AWARD FOR THE CONSTRUCTION OF THE NORTHEAST SEWER EXTENSION PROJECT (SERVING DUAL INTEREST AREA "A").

WHEREAS, the City of Milwaukie has undertaken a project in cooperation with Clackamas County to provide wastewater service in the unincorporated area known through its Urban Growth Management Agreement (UGMA) as Dual Interest Area "A"; and

WHEREAS, the project was included in the 2010-2014 Capital Improvement Plan; and

WHEREAS, the project was approved for funding in the 2009/2010 budget; and

WHEREAS, the project was approved for funding by the Clean Water State Revolving Fund by the Oregon Department of Environmental Quality; and

WHEREAS, the project was approved for funding by the American Recovery and Reinvestment Act (Federal Economic Stimulus Program); and

WHEREAS, the City of Milwaukie has been coordinating with Clackamas County to facilitate the jurisdictional transfer of roads within the Dual Interest Area "A"; and

WHEREAS, the City of Milwaukie has begun the process of annexing the road rights-of-way within the Dual Interest Area "A"; and

WHEREAS, the project to construct the wastewater sewer system was advertised, bid and evaluated in accordance with City, State and Federal requirements; and

WHEREAS, K & R Plumbing Construction is the lowest responsive and responsible bidder; and

NOW, THEREFORE, BE IT RESOLVED that the City of Milwaukie authorizes the City Manager to sign a contract for construction of the Northeast Sewer Extension project with K & R Plumbing Construction, in the amount of \$2,653,257.05.

Introduced and adopted by the City Council on December 1, 2009.

This resolution is effective on December 1, 2009.

Jeremy Ferguson, Mayor

ATTEST:

APPROVED AS TO FORM:
Jordan Schrader Ramis PC

Pat DuVal, City Recorder

City Attorney

LEGEND - SHEETS 4 THROUGH 23

- 5 BENCHMARK
- △ DENOTES FOUND MONUMENT AS NOTED
- FIRE HYDRANT (EXISTING)
- PROPOSED SANITARY SEWER & MANHOLE
- SS EXISTING SANITARY SEWER
- PROPERTY LINE
- RIGHT OF WAY
- UT UNDERGROUND TELEPHONE (PROFILE)
- UP UNDERGROUND POWER (PROFILE)
- SD STORM SEWER LINE
- W WATERLINE
- G GAS LINE
- OHP OVERHEAD POWER LINE
- UGP UNDERGROUND POWER LINE
- X FENCE
- GAS VALVE
- FOUND PROPERTY MARKER
- POWER POLE
- POWER POLE WITH LIGHT
- CATCH BASIN
- MANHOLE
- WATER METER
- WATER VALVE
- 10124 ADDRESS (HOUSE NOT SHOWN)
- VEGETATION
- TREE
- REMOVE TREE
- REMOVE TREE

LEGEND - SHEET 2

- PROPOSED SANITARY SEWER
- * ESTIMATED BASEMENT LOCATIONS (FULL, HALF, OR DAYLIGHT)
- 12 SHEET NUMBER

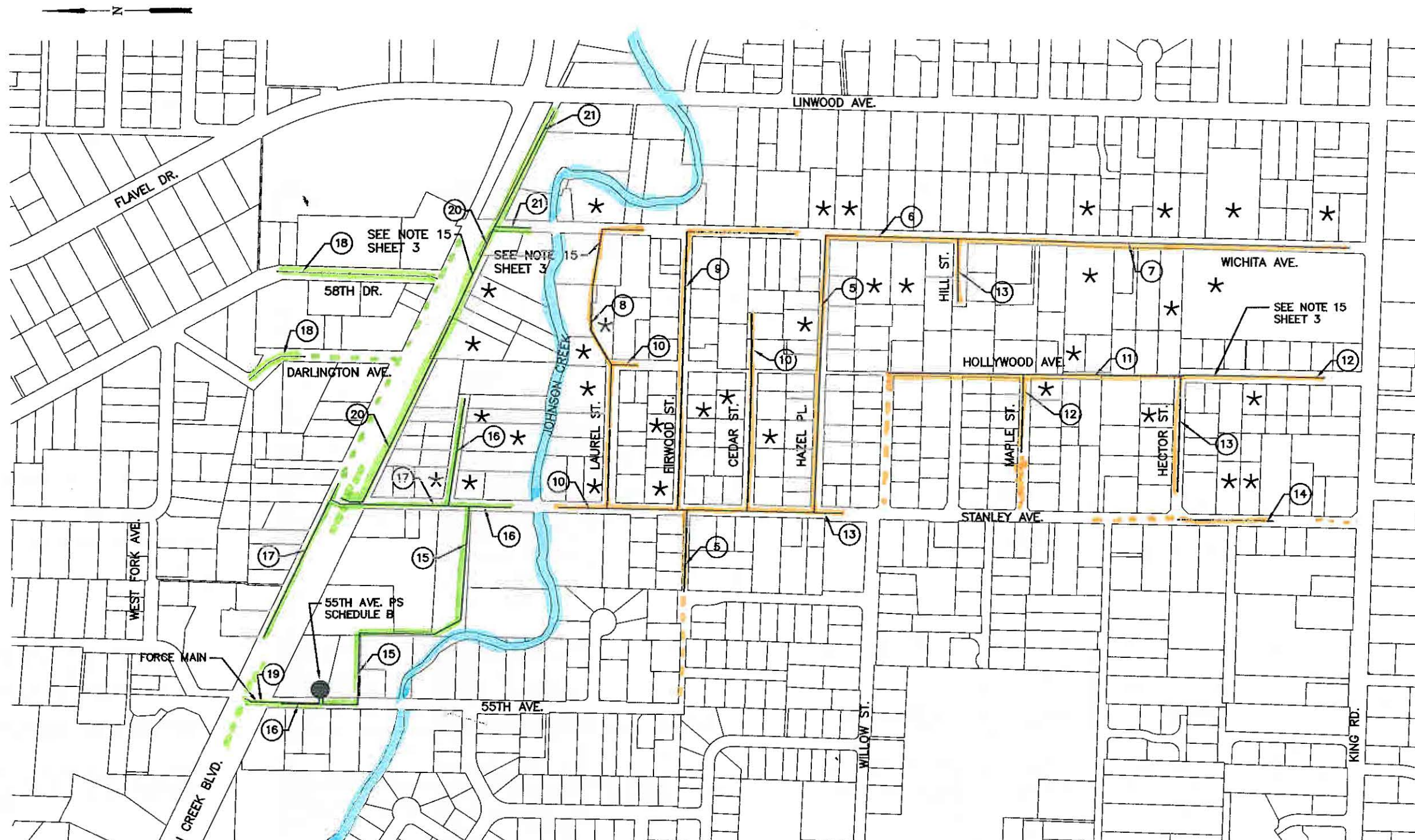

--- New Sewer (Portland Treatment) --- New Sewer (Kellogg treatment)
- - - Exst Sewer " - - - Exst Sewer "

- An updated map will be provided -



PLAN
SCALE: 1"=200'

CWEC PROJECT NO: 41399006.01	VERIFY SCALES BAR IS ONE INCH ON ORIGINAL DRAWING. IF NOT ONE INCH ON THIS SHEET, ADJUST SCALES ACCORDINGLY.	<table border="1" style="width: 100%; border-collapse: collapse;"> <thead> <tr> <th>NO.</th> <th>DATE</th> <th>BY</th> <th>APPR</th> <th>REVISIONS</th> </tr> </thead> <tbody> <tr> <td> </td> <td> </td> <td> </td> <td> </td> <td> </td> </tr> </tbody> </table>	NO.	DATE	BY	APPR	REVISIONS						<p style="text-align: center;">RS PAGE 16</p> <p style="text-align: center;">CENTURY WEST ENGINEERING CORPORATION 6650 S.W. Redwood Lane, Suite 350 Portland, Oregon 97224 503-419-2130 phone • 503-439-2710 fax www.centurywest.com</p> <p>DESIGNED BY: DATE: SEPTEMBER 2009 DRAWN BY: SLK CHECKED BY: RW SCALE: AS SHOWN PROJECT NO: CIP-09-001</p>	<p>NE MILWAUKIE SEWER EXTENSION LEGEND AND SHEET LAYOUT</p> <p>SCHEDULE A</p>	DRAWING NO. G1 SHEET NO. 2 OF 23
NO.	DATE	BY	APPR	REVISIONS											

NORTHEAST MILWAUKIE SEWER EXTENSION PROJECT*November 5, 2009***BID SUMMARY**

<u>CONTRACTOR</u>	<u>SCHEDULE A</u>	<u>SCHEDULE B</u>	<u>TOTAL BID</u>
Emery & Sons Construction	3,479,302.00	325,404.00	3,804,706.00
C & M Construction, In.	3,181,982.10	418,934.65	3,600,916.75
Canby Excavation	2,333,000.00	342,000.00	2,675,000.00
Landis & Landis Construction	2,376,396.00	319,000.00	2,695,396.00
K & R Plumbing Construction	2,320,257.05	333,000.00	2,653,257.05
Moore Excavation, Inc.	3,384,567.00	295,000.00	3,679,567.00
Gelco Construction	4,103,459.50	363,500.00	4,466,959.50
Average Prices	\$3,025,566.24	\$342,405.52	\$3,367,971.76
ENGINEER'S ESTIMATE	3,328,275.00	505,000.00	3,833,275.00

NORTHEAST MILWAUKIE SEWER EXTENSION PROJECT CONSTRUCTION BIDS - NOVEMBER 5, 2009 - 10AM

ITEMS	QUANTITY	Engineers Estimate				Emery & Sons		C & M Construction In.		Canby Excavating		Landis & Landis		K & R Plumbing Const.	
		UNIT PRICE	TOTAL AMOUNT	UNIT PRICE	TOTAL AMOUNT	UNIT PRICE	TOTAL AMOUNT	UNIT PRICE	TOTAL AMOUNT	UNIT PRICE	TOTAL AMOUNT	UNIT PRICE	TOTAL AMOUNT	UNIT PRICE	TOTAL AMOUNT
1 Mobilization (Max 5%)	1 LS	\$ 150,000.00	\$ 150,000.00	\$ 193,000.00	\$ 193,000.00	\$ 150,000.00	\$ 150,000.00	\$ 130,014.00	\$ 130,014.00	\$ 175,000.00	\$ 175,000.00	\$ 105,000.00	\$ 105,000.00	\$ 105,000.00	\$ 105,000.00
2 Traffic Control	1 LS	\$ 80,000.00	\$ 80,000.00	\$ 25,000.00	\$ 25,000.00	\$ 55,905.00	\$ 55,905.00	\$ 76,000.00	\$ 76,000.00	\$ 40,000.00	\$ 40,000.00	\$ 28,000.00	\$ 28,000.00	\$ 28,000.00	\$ 28,000.00
3 Clearing and Grubbing	1 LS	\$ 110,000.00	\$ 110,000.00	\$ 30,000.00	\$ 30,000.00	\$ 83,821.00	\$ 83,821.00	\$ 25,000.00	\$ 25,000.00	\$ 55,000.00	\$ 55,000.00	\$ 11,000.00	\$ 11,000.00	\$ 11,000.00	\$ 11,000.00
4 Rock Excavation - Trench (S.P)	50 CY	\$ 150.00	\$ 7,500.00	\$ 150.00	\$ 7,500.00	\$ 150.00	\$ 7,500.00	\$ 150.00	\$ 7,500.00	\$ 150.00	\$ 7,500.00	\$ 150.00	\$ 7,500.00	\$ 150.00	\$ 7,500.00
5 Foundation Material (S.P.)	500 CY	\$ 40.00	\$ 20,000.00	\$ 40.00	\$ 20,000.00	\$ 40.00	\$ 20,000.00	\$ 40.00	\$ 20,000.00	\$ 40.00	\$ 20,000.00	\$ 40.00	\$ 20,000.00	\$ 40.00	\$ 20,000.00
6 8" PVC Pipe, Class B Backfill	792 LF	\$ 80.00	\$ 63,360.00	\$ 70.00	\$ 55,440.00	\$ 52.00	\$ 41,184.00	\$ 26.00	\$ 20,592.00	\$ 43.00	\$ 34,056.00	\$ 24.90	\$ 19,720.80	\$ 24.90	\$ 19,720.80
7 8" PVC Pipe, Class B Backfill, 0-12 feet deep	6,680 LF	\$ 110.00	\$ 954,800.00	\$ 104.00	\$ 902,720.00	\$ 97.00	\$ 841,960.00	\$ 51.00	\$ 442,680.00	\$ 58.00	\$ 503,440.00	\$ 59.30	\$ 514,724.00	\$ 59.30	\$ 514,724.00
8 8" PVC Pipe, Class B Backfill, 12-16 feet deep	3,836 LF	\$ 130.00	\$ 498,680.00	\$ 154.00	\$ 590,744.00	\$ 108.00	\$ 414,288.00	\$ 83.00	\$ 318,388.00	\$ 82.00	\$ 314,552.00	\$ 95.00	\$ 364,420.00	\$ 95.00	\$ 364,420.00
9 8" PVC Pipe, Class B Backfill, Over 16 feet deep	50 LF	\$ 150.00	\$ 7,500.00	\$ 178.00	\$ 8,900.00	\$ 115.00	\$ 5,750.00	\$ 120.00	\$ 6,000.00	\$ 150.00	\$ 7,500.00	\$ 150.00	\$ 7,500.00	\$ 150.00	\$ 7,500.00
10 12" PVC Pipe, Class A Backfill	570 LF	\$ 100.00	\$ 57,000.00	\$ 77.00	\$ 43,890.00	\$ 59.00	\$ 33,630.00	\$ 48.00	\$ 27,360.00	\$ 40.00	\$ 22,800.00	\$ 26.80	\$ 15,276.00	\$ 26.80	\$ 15,276.00
11 12" PVC Pipe, Class B Backfill, 0-12 feet deep	757 LF	\$ 165.00	\$ 124,905.00	\$ 136.00	\$ 102,952.00	\$ 110.00	\$ 83,270.00	\$ 68.00	\$ 51,476.00	\$ 72.00	\$ 54,504.00	\$ 67.50	\$ 51,097.50	\$ 67.50	\$ 51,097.50
12 12" PVC Pipe, Class B Backfill, 12-16 feet deep	298 LF	\$ 205.00	\$ 61,090.00	\$ 182.00	\$ 54,236.00	\$ 118.00	\$ 35,164.00	\$ 91.00	\$ 27,118.00	\$ 88.00	\$ 26,224.00	\$ 114.00	\$ 33,972.00	\$ 114.00	\$ 33,972.00
13 Horizontal Directional Drilling, Set-up through Restoration	1 LS	\$ 10,000.00	\$ 10,000.00	\$ 8,000.00	\$ 8,000.00	\$ 17,000.00	\$ 17,000.00	\$ 12,000.00	\$ 12,000.00	\$ 8,500.00	\$ 8,500.00	\$ 5,500.00	\$ 5,500.00	\$ 5,500.00	\$ 5,500.00
14 Horizontal Directional Drilling, 8" HDPE Installation	630 LF	\$ 125.00	\$ 78,750.00	\$ 80.00	\$ 50,400.00	\$ 60.50	\$ 38,115.00	\$ 50.00	\$ 31,500.00	\$ 74.00	\$ 46,620.00	\$ 61.50	\$ 38,745.00	\$ 61.50	\$ 38,745.00
15 4" C900 PVC Pipe, (Force Main) Class B Backfill	281 LF	\$ 60.00	\$ 16,860.00	\$ 75.00	\$ 21,075.00	\$ 49.00	\$ 13,769.00	\$ 58.00	\$ 15,736.00	\$ 32.00	\$ 8,992.00	\$ 43.00	\$ 12,083.00	\$ 43.00	\$ 12,083.00
16 4" PVC Tees	252 EA	\$ 35.00	\$ 8,820.00	\$ 100.00	\$ 25,200.00	\$ 35.00	\$ 8,820.00	\$ 143.00	\$ 36,036.00	\$ 34.00	\$ 8,568.00	\$ 70.00	\$ 17,540.00	\$ 70.00	\$ 17,540.00
17 4" PVC Pipe, Service Lateral Class A and B Backfill	4,800 LF	\$ 20.00	\$ 96,000.00	\$ 75.00	\$ 360,000.00	\$ 101.00	\$ 484,800.00	\$ 71.00	\$ 340,800.00	\$ 55.00	\$ 264,000.00	\$ 47.90	\$ 229,920.00	\$ 47.90	\$ 229,920.00
18 48" Standard Manhole 0-12 feet deep	63 LF	\$ 3,500.00	\$ 220,500.00	\$ 6,000.00	\$ 378,000.00	\$ 3,019.00	\$ 190,197.00	\$ 2,550.00	\$ 160,650.00	\$ 3,050.00	\$ 192,150.00	\$ 4,500.00	\$ 283,500.00	\$ 4,500.00	\$ 283,500.00
19 Extra Depth Manhole	22 LF	\$ 125.00	\$ 2,750.00	\$ 200.00	\$ 4,400.00	\$ 100.00	\$ 2,200.00	\$ 50.00	\$ 1,100.00	\$ 225.00	\$ 4,950.00	\$ 200.00	\$ 4,400.00	\$ 200.00	\$ 4,400.00
20 Connect to Exist MH	7 LS	\$ 5,000.00	\$ 35,000.00	\$ 4,000.00	\$ 28,000.00	\$ 6,000.00	\$ 42,000.00	\$ 2,000.00	\$ 14,000.00	\$ 8,500.00	\$ 59,500.00	\$ 9,700.00	\$ 67,900.00	\$ 9,700.00	\$ 67,900.00
21 AC Trench Restoration - (Main Line) 2" Thick	11,055 LF	\$ 12.00	\$ 132,660.00	\$ 9.00	\$ 99,495.00	\$ 12.62	\$ 139,514.10	\$ 12.50	\$ 138,187.50	\$ 8.00	\$ 88,440.00	\$ 9.25	\$ 102,258.75	\$ 9.25	\$ 102,258.75
22 AC Trench Restoration - (Service Lat.) 2" Thick	1,600 LF	\$ 8.00	\$ 12,800.00	\$ 15.00	\$ 24,000.00	\$ 12.71	\$ 20,336.00	\$ 14.25	\$ 22,800.00	\$ 8.00	\$ 12,800.00	\$ 10.00	\$ 16,000.00	\$ 10.00	\$ 16,000.00
23 AC Trench Restoration - (Service Lat.) 6" Thick - JCB	750 LF	\$ 32.00	\$ 24,000.00	\$ 30.00	\$ 22,500.00	\$ 31.91	\$ 23,932.50	\$ 22.25	\$ 16,687.50	\$ 19.00	\$ 14,250.00	\$ 43.00	\$ 32,250.00	\$ 43.00	\$ 32,250.00
24 Temp AC Trench- 1" Thick	7,300 SY	\$ 3.50	\$ 25,550.00	\$ 9.00	\$ 65,700.00	\$ 6.53	\$ 47,669.00	\$ 5.00	\$ 36,500.00	\$ 0.50	\$ 3,650.00	\$ 1.00	\$ 7,300.00	\$ 1.00	\$ 7,300.00
25 AC Overlay- 2" Thick	22,000 SY	\$ 12.00	\$ 264,000.00	\$ 8.00	\$ 176,000.00	\$ 8.76	\$ 192,720.00	\$ 8.25	\$ 181,500.00	\$ 8.50	\$ 187,000.00	\$ 8.30	\$ 182,900.00	\$ 8.30	\$ 182,900.00
26 3/4" - 0" Shoulder Rock	375 Ton	\$ 30.00	\$ 11,250.00	\$ 30.00	\$ 11,250.00	\$ 47.50	\$ 17,812.50	\$ 7.00	\$ 2,625.00	\$ 12.00	\$ 4,500.00	\$ 22.00	\$ 8,250.00	\$ 22.00	\$ 8,250.00
27 3/4" - 0" Base Rock	900 Ton	\$ 30.00	\$ 27,000.00	\$ 30.00	\$ 27,000.00	\$ 25.25	\$ 22,725.00	\$ 18.00	\$ 16,200.00	\$ 12.00	\$ 10,800.00	\$ 27.00	\$ 24,300.00	\$ 27.00	\$ 24,300.00
28 Restoration of Landscaping	1 LS	\$ 55,000.00	\$ 55,000.00	\$ 20,000.00	\$ 20,000.00	\$ 27,000.00	\$ 27,000.00	\$ 42,000.00	\$ 42,000.00	\$ 52,000.00	\$ 52,000.00	\$ 6,000.00	\$ 6,000.00	\$ 6,000.00	\$ 6,000.00
29 Erosion Control	1 LS	\$ 45,000.00	\$ 45,000.00	\$ 15,000.00	\$ 15,000.00	\$ 20,000.00	\$ 20,000.00	\$ 19,000.00	\$ 19,000.00	\$ 55,000.00	\$ 55,000.00	\$ 5,000.00	\$ 5,000.00	\$ 5,000.00	\$ 5,000.00
30 Impervious Barrier (CDF)	4 LS	\$ 1,000.00	\$ 4,000.00	\$ 2,000.00	\$ 8,000.00	\$ 1,000.00	\$ 4,000.00	\$ 525.00	\$ 2,100.00	\$ 500.00	\$ 2,000.00	\$ 900.00	\$ 3,600.00	\$ 900.00	\$ 3,600.00
32 Temp Chainlink Fencing - PGE	1,400 LF	\$ 12.00	\$ 16,800.00	\$ 10.00	\$ 14,000.00	\$ 4.00	\$ 5,600.00	\$ 3.25	\$ 4,550.00	\$ 2.00	\$ 2,800.00	\$ 4.50	\$ 6,300.00	\$ 4.50	\$ 6,300.00
33 Temp Chainlink Fencing	600 LF	\$ 7.00	\$ 4,200.00	\$ 4.00	\$ 2,400.00	\$ 4.00	\$ 2,400.00	\$ 2.00	\$ 1,200.00	\$ 3.00	\$ 1,800.00	\$ 2.50	\$ 1,500.00	\$ 2.50	\$ 1,500.00
34 16" HDPE Storm Drain	1 LS	\$ 20,000.00	\$ 20,000.00	\$ 6,000.00	\$ 6,000.00	\$ 12,650.00	\$ 12,650.00	\$ 9,700.00	\$ 9,700.00	\$ 10,000.00	\$ 10,000.00	\$ 9,500.00	\$ 9,500.00	\$ 9,500.00	\$ 9,500.00
Waterline Collar Blocks - (Stipulated Price)	15 EA	\$ 1,500.00	\$ 22,500.00	\$ 1,500.00	\$ 22,500.00	\$ 1,500.00	\$ 22,500.00	\$ 1,500.00	\$ 22,500.00	\$ 1,500.00	\$ 22,500.00	\$ 1,500.00	\$ 22,500.00	\$ 1,500.00	\$ 22,500.00
35 Decommission Existing Pump Station	1 LS	\$ 10,000.00	\$ 10,000.00	\$ 6,000.00	\$ 6,000.00	\$ 3,750.00	\$ 3,750.00	\$ 3,500.00	\$ 3,500.00	\$ 5,000.00	\$ 5,000.00	\$ 5,000.00	\$ 5,000.00	\$ 5,000.00	\$ 5,000.00
36 Extra Work / Force Account	1 LS	\$ 50,000.00	\$ 50,000.00	\$ 50,000.00	\$ 50,000.00	\$ 50,000.00	\$ 50,000.00	\$ 50,000.00	\$ 50,000.00	\$ 50,000.00	\$ 50,000.00	\$ 50,000.00	\$ 50,000.00	\$ 50,000.00	\$ 50,000.00
TOTAL SCHEDULE A			\$ 3,328,275.00		\$ 3,479,302.00		\$ 3,181,982.10		\$ 2,333,000.00		\$ 2,376,396.00		\$ 2,320,257.05		\$ 2,320,257.05
SCHEDULE B															
1 0.30 mgd Sanitary Sewer Pump Station	1 LS	\$ 485,000.00	\$ 485,000.00	\$ 305,404.00	\$ 305,404.00	\$ 398,934.65	\$ 398,934.65	\$ 322,000.00	\$ 322,000.00	\$ 299,000.00	\$ 299,000.00	\$ 313,000.00	\$ 313,000.00	\$ 313,000.00	\$ 313,000.00
2 Extra Work / Force Account	1 LS	\$ 20,000.00	\$ 20,000.00	\$ 20,000.00	\$ 20,000.00	\$ 20,000.00	\$ 20,000.00	\$ 20,000.00	\$ 20,000.00	\$ 20,000.00	\$ 20,000.00	\$ 20,000.00	\$ 20,000.00	\$ 20,000.00	\$ 20,000.00
TOTAL SCHEDULE B			\$ 505,000.00		\$ 325,404.00		\$ 418,934.65		\$ 342,000.00		\$ 319,000.00		\$ 333,000.00		\$ 333,000.00
TOTAL BID															
SCHEDULE A + SCHEDULE B			\$ 3,833,275.00	\$ 3,804,706.00	\$ 3,600,916.75	\$ 2,675,000.00	\$ 2,695,396.00	\$ 2,653,257.05							

NORTHEAST MILWAUKIE SEWER EXTENSION PROJECT CONSTRUCTION BIDS - NOVEMBER 5, 2009 - 10AM

SCHEDULE A		Moore Excavation Inc.				Gelco Construction												
ITEMS	QUANTITY		UNIT PRICE	TOTAL AMOUNT	UNIT PRICE	TOTAL AMOUNT	UNIT PRICE	TOTAL AMOUNT	UNIT PRICE	TOTAL AMOUNT	UNIT PRICE	TOTAL AMOUNT	UNIT PRICE	TOTAL AMOUNT	UNIT PRICE	TOTAL AMOUNT	UNIT PRICE	TOTAL AMOUNT
1	Mobilization (Max 5%)	1	LS	\$ 365,000.00	\$ 365,000.00	\$ 160,000.00	\$ 160,000.00	\$ -	\$ -	\$ -	\$ -	\$ -	\$ -	\$ -	\$ -	\$ -	\$ -	\$ -
2	Traffic Control	1	LS	\$ 115,000.00	\$ 115,000.00	\$ 167,000.00	\$ 167,000.00	\$ -	\$ -	\$ -	\$ -	\$ -	\$ -	\$ -	\$ -	\$ -	\$ -	\$ -
3	Clearing and Grubbing	1	LS	\$ 22,000.00	\$ 22,000.00	\$ 25,000.00	\$ 25,000.00	\$ -	\$ -	\$ -	\$ -	\$ -	\$ -	\$ -	\$ -	\$ -	\$ -	\$ -
4	Rock Excavation - Trench (S.P)	50	CY	\$ 150.00	\$ 7,500.00	\$ 150.00	\$ 7,500.00	\$ 150.00	\$ 7,500.00	\$ 150.00	\$ 7,500.00	\$ 150.00	\$ 7,500.00	\$ 150.00	\$ 7,500.00	\$ 150.00	\$ 7,500.00	\$ 7,500.00
5	Foundation Material (S.P.)	500	CY	\$ 40.00	\$ 20,000.00	\$ 40.00	\$ 20,000.00	\$ 40.00	\$ 20,000.00	\$ 40.00	\$ 20,000.00	\$ 40.00	\$ 20,000.00	\$ 40.00	\$ 20,000.00	\$ 40.00	\$ 20,000.00	\$ 20,000.00
6	8" PVC Pipe, Class B Backfill	792	LF	\$ 95.00	\$ 75,240.00	\$ 55.50	\$ 43,956.00	\$ -	\$ -	\$ -	\$ -	\$ -	\$ -	\$ -	\$ -	\$ -	\$ -	\$ -
7	8" PVC Pipe, Class B Backfill, 0-12 feet deep	8,680	LF	\$ 76.50	\$ 664,020.00	\$ 125.00	\$ 1,085,000.00	\$ -	\$ -	\$ -	\$ -	\$ -	\$ -	\$ -	\$ -	\$ -	\$ -	\$ -
8	8" PVC Pipe, Class B Backfill, 12-16 feet deep	3,836	LF	\$ 102.00	\$ 391,272.00	\$ 224.00	\$ 859,264.00	\$ -	\$ -	\$ -	\$ -	\$ -	\$ -	\$ -	\$ -	\$ -	\$ -	\$ -
9	8" PVC Pipe, Class B Backfill, Over 16 feet deep	50	LF	\$ 94.00	\$ 4,700.00	\$ 237.00	\$ 11,850.00	\$ -	\$ -	\$ -	\$ -	\$ -	\$ -	\$ -	\$ -	\$ -	\$ -	\$ -
10	12" PVC Pipe, Class A Backfill	570	LF	\$ 74.00	\$ 42,180.00	\$ 42.00	\$ 23,940.00	\$ -	\$ -	\$ -	\$ -	\$ -	\$ -	\$ -	\$ -	\$ -	\$ -	\$ -
11	12" PVC Pipe, Class B Backfill, 0-12 feet deep	757	LF	\$ 107.00	\$ 80,999.00	\$ 135.00	\$ 102,195.00	\$ -	\$ -	\$ -	\$ -	\$ -	\$ -	\$ -	\$ -	\$ -	\$ -	\$ -
12	12" PVC Pipe, Class B Backfill, 12-16 feet deep	298	LF	\$ 105.00	\$ 31,290.00	\$ 140.00	\$ 41,720.00	\$ -	\$ -	\$ -	\$ -	\$ -	\$ -	\$ -	\$ -	\$ -	\$ -	\$ -
13	Horizontal Directional Drilling, Set-up through Restoration	1	LS	\$ 10,000.00	\$ 10,000.00	\$ 11,000.00	\$ 11,000.00	\$ -	\$ -	\$ -	\$ -	\$ -	\$ -	\$ -	\$ -	\$ -	\$ -	\$ -
14	Horizontal Directional Drilling, 8" HDPE Installation	630	LF	\$ 100.00	\$ 63,000.00	\$ 125.00	\$ 78,750.00	\$ -	\$ -	\$ -	\$ -	\$ -	\$ -	\$ -	\$ -	\$ -	\$ -	\$ -
15	4" C900 PVC Pipe, (Force Main) Class B Backfill	281	LF	\$ 84.00	\$ 23,604.00	\$ 43.00	\$ 12,083.00	\$ -	\$ -	\$ -	\$ -	\$ -	\$ -	\$ -	\$ -	\$ -	\$ -	\$ -
16	4" PVC Tees	252	EA	\$ 45.00	\$ 11,340.00	\$ 40.00	\$ 10,080.00	\$ -	\$ -	\$ -	\$ -	\$ -	\$ -	\$ -	\$ -	\$ -	\$ -	\$ -
17	4" PVC Pipe, Service Lateral Class A and B Backfill	4,800	LF	\$ 75.00	\$ 360,000.00	\$ 87.00	\$ 417,600.00	\$ -	\$ -	\$ -	\$ -	\$ -	\$ -	\$ -	\$ -	\$ -	\$ -	\$ -
18	48" Standard Manhole 0-12 feet deep	63	LF	\$ 2,100.00	\$ 132,300.00	\$ 4,840.00	\$ 304,920.00	\$ -	\$ -	\$ -	\$ -	\$ -	\$ -	\$ -	\$ -	\$ -	\$ -	\$ -
19	Extra Depth Manhole	22	LF	\$ 120.00	\$ 2,640.00	\$ 1,050.00	\$ 23,100.00	\$ -	\$ -	\$ -	\$ -	\$ -	\$ -	\$ -	\$ -	\$ -	\$ -	\$ -
20	Connect to Exist MH	7	LS	\$ 14,500.00	\$ 101,500.00	\$ 1,300.00	\$ 9,100.00	\$ -	\$ -	\$ -	\$ -	\$ -	\$ -	\$ -	\$ -	\$ -	\$ -	\$ -
21	AC Trench Restoration - (Main Line) 2" Thick	11,055	LF	\$ 18.00	\$ 198,990.00	\$ 17.30	\$ 191,251.50	\$ -	\$ -	\$ -	\$ -	\$ -	\$ -	\$ -	\$ -	\$ -	\$ -	\$ -
22	AC Trench Restoration - (Service Lat.) 2" Thick	1,600	LF	\$ 23.00	\$ 36,800.00	\$ 17.50	\$ 28,000.00	\$ -	\$ -	\$ -	\$ -	\$ -	\$ -	\$ -	\$ -	\$ -	\$ -	\$ -
23	AC Trench Restoration - (Service Lat.) 6" Thick - JCB	750	LF	\$ 47.00	\$ 35,250.00	\$ 30.00	\$ 22,500.00	\$ -	\$ -	\$ -	\$ -	\$ -	\$ -	\$ -	\$ -	\$ -	\$ -	\$ -
24	Temp AC Trench- 1" Thick	7,300	SY	\$ 11.00	\$ 80,300.00	\$ 9.00	\$ 65,700.00	\$ -	\$ -	\$ -	\$ -	\$ -	\$ -	\$ -	\$ -	\$ -	\$ -	\$ -
25	AC Overlay- 2" Thick	22,000	SY	\$ 10.00	\$ 220,000.00	\$ 8.00	\$ 176,000.00	\$ -	\$ -	\$ -	\$ -	\$ -	\$ -	\$ -	\$ -	\$ -	\$ -	\$ -
26	3/4" - 0" Shoulder Rock	375	Ton	\$ 32.00	\$ 12,000.00	\$ 32.00	\$ 12,000.00	\$ -	\$ -	\$ -	\$ -	\$ -	\$ -	\$ -	\$ -	\$ -	\$ -	\$ -
27	3/4" - 0" Base Rock	900	Ton	\$ 32.38	\$ 29,142.00	\$ 24.00	\$ 21,600.00	\$ -	\$ -	\$ -	\$ -	\$ -	\$ -	\$ -	\$ -	\$ -	\$ -	\$ -
28	Restoration of Landscaping	1	LS	\$ 15,000.00	\$ 15,000.00	\$ 62,000.00	\$ 62,000.00	\$ -	\$ -	\$ -	\$ -	\$ -	\$ -	\$ -	\$ -	\$ -	\$ -	\$ -
29	Erosion Control	1	LS	\$ 75,000.00	\$ 75,000.00	\$ 18,300.00	\$ 18,300.00	\$ -	\$ -	\$ -	\$ -	\$ -	\$ -	\$ -	\$ -	\$ -	\$ -	\$ -
30	Impervious Barrier (CDF)	4	LS	\$ 1,000.00	\$ 4,000.00	\$ 970.00	\$ 3,880.00	\$ -	\$ -	\$ -	\$ -	\$ -	\$ -	\$ -	\$ -	\$ -	\$ -	\$ -
32	Temp Chainlink Fencing - PGE	1,400	LF	\$ 25.00	\$ 35,000.00	\$ 2.00	\$ 2,800.00	\$ -	\$ -	\$ -	\$ -	\$ -	\$ -	\$ -	\$ -	\$ -	\$ -	\$ -
33	Temp Chainlink Fencing	600	LF	\$ 20.00	\$ 12,000.00	\$ 1.60	\$ 960.00	\$ -	\$ -	\$ -	\$ -	\$ -	\$ -	\$ -	\$ -	\$ -	\$ -	\$ -
34	16" HDPE Storm Drain	1	LS	\$ 25,000.00	\$ 25,000.00	\$ 9,650.00	\$ 9,650.00	\$ -	\$ -	\$ -	\$ -	\$ -	\$ -	\$ -	\$ -	\$ -	\$ -	\$ -
34	Waterline Collar Blocks - (Stipulated Price)	15	EA	\$ 1,500.00	\$ 22,500.00	\$ 1,500.00	\$ 22,500.00											
35	Decommission Existing Pump Station	1	LS	\$ 10,000.00	\$ 10,000.00	\$ 2,260.00	\$ 2,260.00											
36	Extra Work / Force Account	1	LS	\$ 50,000.00	\$ 50,000.00	\$ 50,000.00	\$ 50,000.00											
TOTAL SCHEDULE A					\$ 3,384,567.00		\$ 4,103,459.50											
SCHEDULE B																		
1	0.30 mgd Sanitary Sewer Pump Station	1	LS	\$ 275,000.00	\$ 275,000.00	\$ 343,500.00	\$ 343,500.00	\$ -										
2	Extra Work / Force Account	1	LS	\$ 20,000.00	\$ 20,000.00	\$ 20,000.00	\$ 20,000.00											
TOTAL SCHEDULE B					\$ 295,000.00		\$ 363,500.00											
TOTAL BID					\$ 3,679,567.00		\$ 4,466,959.50		\$ -		\$ -		\$ -		\$ -		\$ -	



Oregon

Theodore R. Kulongoski, Governor

Department of Environmental Quality

Northwest Region Portland Office

2020 SW 4th Avenue, Suite 400

Portland, OR 97201-4987

(503) 229-5263

Fax: (503) 229-6945

TTY: (503) 229-5471

November 12, 2009

Gary Parkin, Engineering Director
City of Milwaukie
6101 SE Johnson Creek Blvd
Milwaukie, OR 97206

Re: Northeast Milwaukie Sewer Extension Project, Schedule A and Schedule B
CWSRF Loan #R06655, DEQ Concurrence in Award of Construction Contract

Dear Mr. Parkin,

The Department has reviewed the bid information for the above referenced project submitted by your consultant, Century West Engineering Corporation, on November 9, 2009. All documentation has been found to be in order. The Department concurs in the award of the contract to K & R Plumbing Construction Company, Inc., as recommended in the CWSRF Bid Review Checklist. The contract amount for both Schedule A and Schedule B is \$2,653,257.05.

Please provide us with a copy of the signed Contract and Notice to Proceed when these have been executed.

Please refer to the CWSRF Construction Manual, Tab 4, for guidance on Monthly Progress Reports, Disbursement Requests, Change Orders and other CWSRF procedures and requirements pertaining to this project. I will attend the pre-construction conference for this contract to provide further guidance to City staff and consultants on these procedures.

Also, please refer to the Plan Approval letters from Garry Sage, dated August 13, 2009 for Schedule A, and Mike Pinney, dated August 3, 2009 for Schedule B, for additional requirements pertaining to this project.

Feel free to contact me at 503-229-5219 if I can provide further assistance.

Sincerely,

Manette Simpson, Project Officer
Northwest Region Source Control Section

C: Ron Weigal, Project Manager, Century West Engineering Corporation
Garry Sage, Mike Pinney, Greg Geist, DEQ, NWR